

NOTE: See ProTrap[®] Owner's Manual for complete cab wiring & ProTrap[®] installation instructions.

Item	Part #	Description
1.	1702707	Ring Terminal - 6 Ga. 1/4" Stud
2.	1704330	Rubber Insulating Boot
3.	1118257	Shur-Co. [®] Wireless Receiver
4.	1700408	Hex Nut - 1/4"
5.	1700436	Lock Washer - 1/4"
6.	1702926	Cap Screw - 5/16" x 7/8"
7.	1201237	Flat Washer - 5/16"
8.	1700419	Nylon Lock Nut - 5/16"

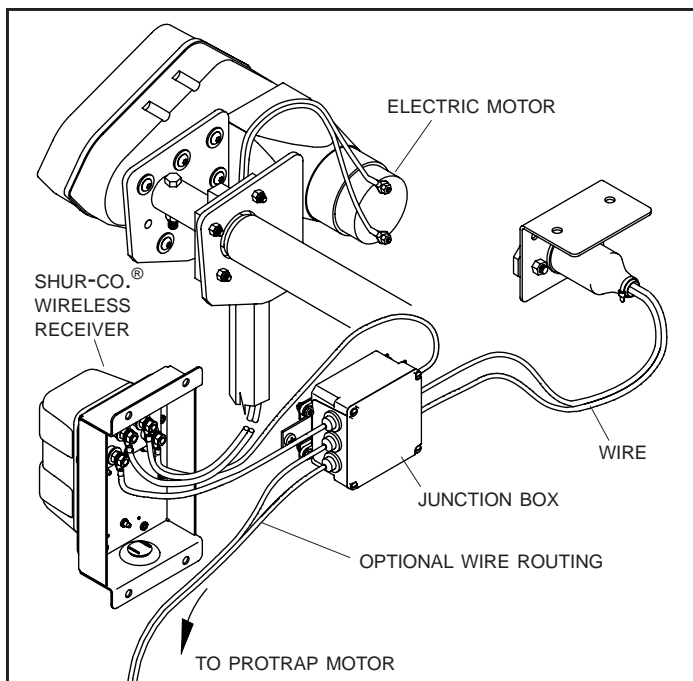
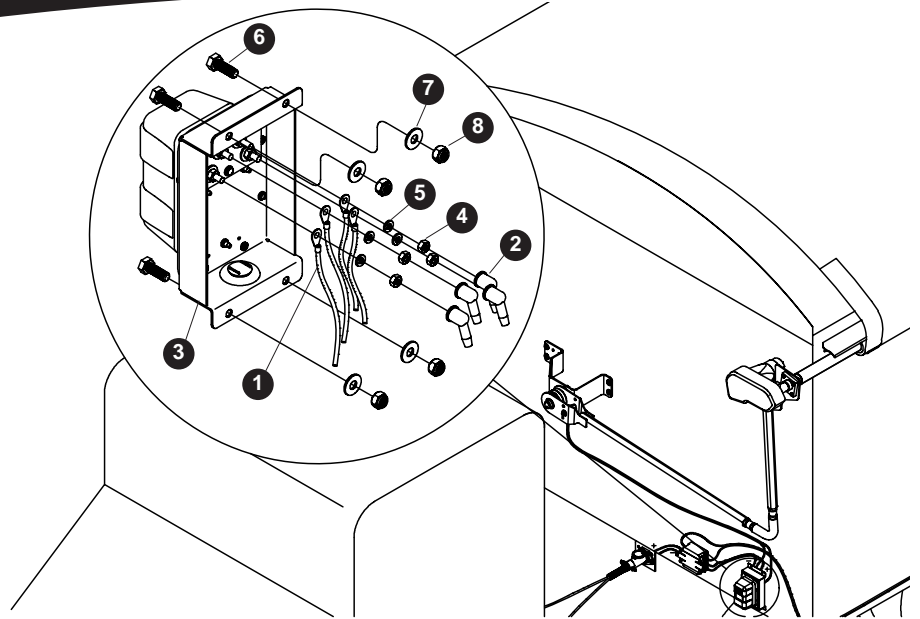

USE DIELECTRIC GREASE (PART #1704378) TO PREVENT CORROSION ON TERMINALS.

STEP 1: Shur-Co.[®] Wireless Receiver - Identify 6 ga. wire running from electric motor through front pivot arm. Route wire as desired. Insert end of this wire through rubber boots, then crimp 1/4" ring terminals onto wire ends. Remove nuts and lock washers from back of wireless receiver. Place positive wire on upper orange post and negative wire on upper black post. Secure lock washers and hex nuts. Coat with dielectric grease and install rubber boots over ring terminals.

Run a section of 6 ga. wire, long enough to reach the sealed junction box, through rubber boots. Crimp 1/4" ring terminals to wire ends. On back of wireless receiver, place positive wire on lower orange post and negative wire on lower black post. Secure with lock washers and hex nuts. Coat with dielectric grease and install rubber boots over ring terminals.

Mount receiver at suitable location on front of trailer. Mark and drill 11/32" holes and fasten with 5/16" x 7/8" cap screws, flat washers and nylon lock nuts.

STEP 2: Sealed Junction Box - Locate junction box near conductor socket. Mark and drill 3/16" holes and fasten to trailer with 1/4" x 3/4" self-drilling screws.

Run 6 ga. wire from receiver to sealed junction box. Crimp 1/4" ring terminals to wire ends. Remove hex nuts and lock washers from posts in junction box. Place positive wire on positive post and negative wire on negative post.

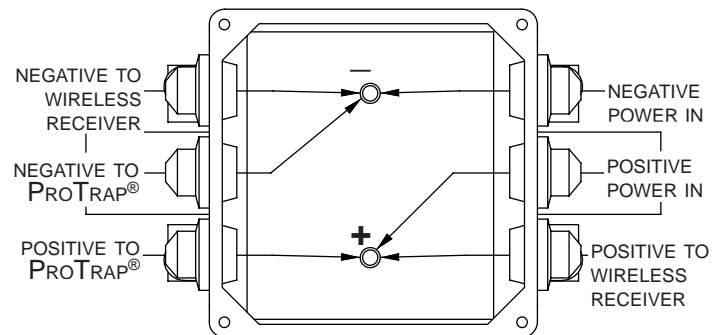

Run separate section of 6 ga. wires from conductor socket to sealed junction box. Crimp 1/4" ring terminals to wire ends. Place positive wire on positive post, negative wire on negative post. Run separate section of 6 ga. wires from ProTrap® motor assembly to junction box near conductor socket. Secure with 1/4" lock washers and hex nuts.

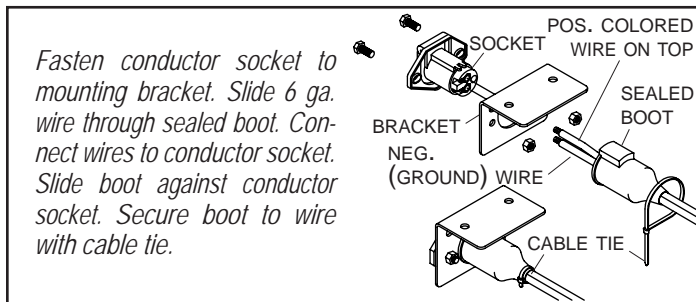
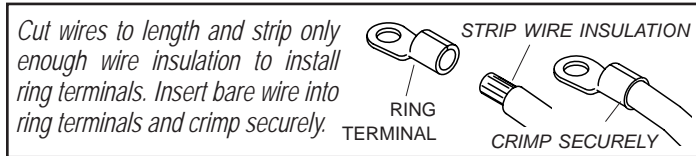

Operation

A) Open Trap: Check motor direction by activating switch to "OPEN". If switch is running system backwards, change wire leads on motor to opposite connections.

B) Close Trap: Push switch to "CLOSE" and hold. Observe trap and release switch when hopper door is fully closed.

C) Open Trap: Push switch to "OPEN" and hold. Observe trap and release switch when hopper door is fully opened.

NOTE: Release switch at end of cycle or modified-reset circuit breaker will trip. After breaker resets, switch will activate motor again. To reduce unnecessary strain on tarp components, release switch at end of each cycle.

NOTE: Pressure Wash - The receiver may be pressure washed, but keep nozzle at least three feet from system while spraying.

Replacement Parts

Item	Part #	Description
1.	1704308	Cap Screw - #10 x 1/2"
2.	1704298	Motor Reversing Solenoid - RF
3.	1704343	Cap Screw - 1/4" x 1 1/2"
4.	1700408	Hex Nut - 1/4"
5.	1700427	Flat Washer - 1/4"
6.	1118257	Shur-Co.® Wireless Receiver
7.	1118296	Modular Control Bracket
8.	1701595	End Plug - 1" x 14-23 Ga.
9.	1703282	Rubber Grommet - 1 1/4" Insert
10.	1118037	Plastic Washer - Black
11.	1118250	Plastic Washer - Orange
12.	1700436	Lock Washer - 1/4"
13.	1118297	Insulating Plate
14.	1118340	Solenoid Cover w/Decal, Gasket, Rocker Switch & 8" Wires
15.	1702926	Cap Screw - 5/16" x 7/8"
16.	1201237	Flat Washer - 5/16"
17.	1700419	Nylon Lock Nut - 5/16"
18.	1704317	12 Ga. Wire - 3" Black
19.	1704316	12 Ga. Wire - 3" Red
20.	1704369	Trim Seal
21.	1118437	SMARTtransmitter® Remote
22.	1704597	SMARTtransmitter® Battery (High Capacity)

