



TARPING SYSTEMS & ACCESSORIES

P/N 1121420 Rev. D

OWNER'S MANUAL



Value Series Swing Arm Electric Shur-Lok[®] Remote

READ BEFORE INSTALLING

PO BOX 713 ■ 2309 SHUR-LOK STREET ■ YANKTON, SD 57078-0713
PHONE 1-800-4-SHUR-LOK (1-800-474-8756) ■ FAX 605-665-0501
www.shurco.com

SHOP ONLINE: www.shopshurco.com

SHIPPING. All orders are shipped F.O.B. from the Shur-Co®, LLC sites listed below. There will be no full freight allowed or prepaid shipment accepted unless quoted and approved in writing prior to acceptance of the order. All shipments are made by the most reasonable means in accordance with the size and weight of the order, unless specified routing instructions are furnished by the customer. Shipments are made daily via U.P.S. and common carrier. Claims for shortages must be made within 10 days. All claims for damages or loss in transit must be made with the carrier. No collect calls will be accepted. To ensure delivery of orders, we need your full street address and phone number. When you receive your shipment, examine it carefully. Be sure all cartons listed on the delivery sheet are accounted for. Large items may be packaged separately. If a carton is damaged, open it and inspect the contents before signing for delivery. If merchandise is damaged, describe the damage on the delivery receipt. Failure on your part to document damaged or missing merchandise on the delivery receipt releases the carrier of all liability; repair or replacement will be the customer's responsibility.

WARRANTY. We warrant that all new products are free from defects in materials and workmanship.* This warranty is effective if products are properly installed and used for the purpose for which they were intended and applies to the original buyer only. Except as set forth above or as set forth in any product-specific warranty documentation, we make no other warranties, express or implied, including, but not limited to, warranties of merchantability or fitness for a particular use.

Returns of a product for warranty must be accompanied by a Return Merchandise Authorization number (RMA#), which can be obtained by calling Customer Service at 866-748-7435, and sent, with freight paid by us, to Shur-Co®, LLC, 2309 Shur-Lok Street, P.O. Box 713, Yankton, SD 57078 USA. All products returned without an RMA# will be refused. When we issue the RMA#, we will also issue a call tag to have UPS (or other freight company) pick up the product. C.O.D. returns will not be accepted. We will pay no storage charges for a warranty product return prior to pick by us or the freight company. If a warranty product return is scheduled to be picked up by us, we will pick up the product at our earliest convenience.

If a product returned is found, in our judgement, to be defective in material or workmanship, our obligation under this warranty is limited to the repair or replacement of the product, which will be made by us. Repair or replacement will be at our discretion, with replacements being made using current products performing in the equivalent function. Labor charges, other than those incurred at our factory, including, but not limited to, any labor to install a repaired or replacement product, are not covered under this warranty. All expenses associated with delivering defective products to our factory and delivering repaired or replacement products from our factory to the owner will be paid by us.

If the product returned is found, in our judgement, to be non-warrantable, the owner will be contacted to authorize repair work, purchase of a replacement product or return of the product, all of which will be at the owner's expense. Payment authorization must be received by us before any non-warrantable product is repaired, replaced or returned. All expenses associated with delivering the repaired non-warrantable product, a replacement product or the non-warrantable product from our factory to the owner will be paid by the owner.

In no event will we be liable for any damages of any kind or nature to person, product or property, including, but not limited to, indirect, incidental, special, consequential or punitive damages of any kind, or damages for loss of profits or revenue, even if we have been advised of the possibility of such damages. There are no warranties for used products or products that have been repaired, altered, modified or subjected to misuse, negligence or accident. We will not repair or replace products that fail or malfunction due to ordinary wear and tear, except as expressly provided in a product-specific warranty. The use of non-Shur-Co®, LLC parts in conjunction with Shur-Co®, LLC products will void this product warranty.

*Certain products have specific warranties that differ from this warranty, for example motors and electronics. Product-specific warranty documentation is available for these items. In the event of a conflict between this warranty and a product-specific warranty, the product-specific warranty will govern.

RETURN POLICY. All sales are final. See WARRANTY above for information on warranty returns.

OTHER. All prices, product listings, sizes, weights and manufacturing details are subject to change without notice. No person is authorized to modify the foregoing conditions of sale whatsoever.

SHUR-CO® OF SOUTH DAKOTA

Corporate HQ and Outlet Store
2309 Shur-Lok St., PO Box 713
Yankton, SD 57078-0713
Phone - 800.474.8756
Fax - 605.665.0501

SHUR-CO®, LLC Donovan

SHUR-CO® of FLORIDA
3353 SE Gran Park Way
Stuart, FL 34997
Phone - 800.327.8287
Fax - 772.287.0431

SHUR-CO®, LLC International

SHUR-CO® UK, Ltd.
Unit 41 Rochester Airport Est.
Laker Rd.
Rochester, Kent ME1 3QX
Phone - +44 (0)1795 473499
Fax +44 (0)871 272 8278

SERVICE CENTERS

SHUR-CO® of COLORADO
10220 Brighton Rd., Unit #1
Henderson, CO 80640
Phone - 866.355.9173
Fax - 303.289.2298

SHUR-CO® of ILLINOIS
4350 E. Boyd Rd.
Decatur, IL 62521
Phone - 866.356.0246
Fax - 217.877.8270

SHUR-CO® of IOWA
3839 Midway Blvd.
Ft. Dodge, IA 50501
Phone - 866.356.0245
Fax - 515.576.5578

SHUR-CO® of MICHIGAN
5100 Lakeshore Dr.
Lexington, MI 48450
Phone - 800.327.8287
Fax - 772.287.0431

SHUR-CO® of NORTH DAKOTA
920 38th St. NW, Exit 66
Fargo, ND 58102
Phone - 877.868.4488
Fax - 701.277.1283

SHUR-CO® of OHIO
1100 N. Freedom, St. Rt. 88 & 14
Ravenna, OH 44266
Phone - 866.356.0242
Fax - 330.297.5599

SHUR-CO® of OKLAHOMA
1604 East US Hwy 66
El Reno, OK 73036
Phone - 866.356.0243
Fax - 405.262.3842

SHUR-CO® of TEXAS
34505 I-10 West, S. Frontage Rd.
Brookshire, TX 77423
Phone - 866.689.0039
Fax - 281.934.3311

MESSAGE TO OWNERS

Thank you for buying this tarping system from Shur-Co®. We appreciate your confidence in our products. Please read and thoroughly understand this manual before installing and/or operating this system.

Pay particular attention to important safety and operating instructions, as well as warnings and cautions. The hazard symbol  is used to alert users to potentially hazardous conditions and is followed by caution, warning or danger messages.

Failure to READ AND FOLLOW INSTRUCTIONS could result in failure of your tarping system and/or personal injury. Your trailer requirements may, however, call for minor variations to these instructions.

Please inspect your tarping system periodically; repair or replace worn or damaged parts.

QUESTIONS? CALL OUR HELP LINE:

1-866-748-7435

MON-FRI 8 AM-5 PM CENTRAL TIME

SAFETY

We at Shur-Co® are concerned with your safety and the safety of all those operating this system. Therefore, we have provided safety decals at various locations on your tarping system. Keep decals as clean as possible at all times. Replace any decal that has become worn or damaged, painted over or otherwise difficult to read. Replacement decals are available through Shur-Co® dealers.

PARTS INSPECTION

Inspect all parts in your Value Series Electric kit upon arrival. Please inspect your tarping system regularly, and repair or replace parts when continued use could damage your system.

SAFETY INSTRUCTIONS

- 1. Always wear safety glasses during installation and operation.**
- 2. Stay clear of moving parts.**
- 3. No other use of this system is authorized, except as designed.**

RUST PREVENTION

To prevent rust, paint all exposed metal, such as weld seams and/or metal exposed by grinding or cutting, with corrosion-resistant paint.

TABLE OF CONTENTS

- Hardware Identification..... 1
- Swing Arm, Slide Arm & Motor 2
- Roll Tube Extension..... 3
- Shock Cord..... 4
- Roll Tube Eyes 5-6
- Electric - Farm Body & Fertilizer Spreader..... 7-9
- Wireless SMART1+™ Remote Programming & Operating 10
- Program Wireless SMART1+™ Remote to Receiver..... 11
- Electric - Semi 12-14
- Replacement Parts 15-16
- Troubleshooting Guide 17

TOOLS REQUIRED

- 1. Welder
- 2. Hammer
- 3. Center Punch or Transfer Punch
- 4. #3 Phillips Insert Bit
- 5. Air or Electric Impact Wrench (9/16" deep socket)
- 6. 7/16" Deep Socket
- 7. 3/8" Combination Wrench
- 8. 9/16" Combination Wrench
- 9. 1/2" Combination Wrench
- 10. 1/8" Hex Wrench Long T-Handle
- 11. 3/16" Hex Wrench Long T-Handle (recommended)
- 12. 5/16" Drill Bit (for 3/8" self-tapping screws)
- 13. 13/32" Drill Bit
- 14. 3/8" Drill Bit
- 15. 1/4" Drill Bit
- 16. 17/64" Drill Bit
- 17. 3/8" Drill
- 18. 2" Hole Saw
- 19. Standard/Flathead Screwdriver
- 20. #2 Phillips Screwdriver
- 21. Utility Knife
- 22. Ratchet
- 23. Hack Saw (metal cutter)
- 24. Pliers
- 25. Snap Ring Pliers
- 26. Wire Cutters
- 27. Grinder
- 28. Tape Measure

A

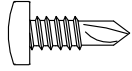

1700398 - Self-Drilling Screw - 1/4" x 3/4"

B

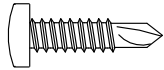

1705198 - Self-Drilling Screw - 1/4" x 1"

C

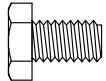

1703171 - Cap Screw - 5/16" x 1/2"

D

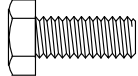

1701045 - Cap Screw - 5/16" x 3/4"

E

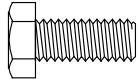

1201269 - Cap Screw - 5/16" x 3/4" - SS

F

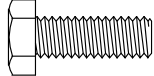

1702926 - Cap Screw - 5/16" x 7/8"

G

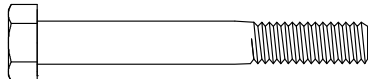

1703237 - Cap Screw - 5/16" x 2 1/2"

H

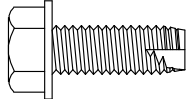

1700400 - Self-Tapping Screw - 3/8" x 1"

J

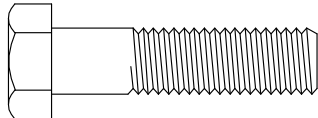

1701042 - Cap Screw - 1/2" x 2"

K

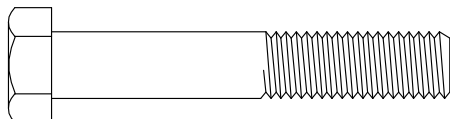

1704779 - Cap Screw - 1/2" x 3"

L



1702492 - Top Lock Nut - 5/16"

M



1700411 - Hex Nut - 5/16"

N



1700419 - Nylon Lock Nut - 5/16"

P



1700407 - Hex Nut - 3/8"

Q

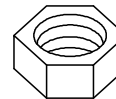

1700413 - Hex Jam Nut - 1/2"

R

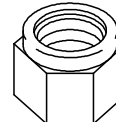

1702115 - Nylon Lock Nut - 1/2"

S

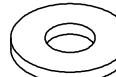

1700428 - Flat Washer - 5/16"

T

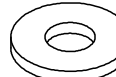

1201237 - Flat Washer - 5/16" - SS

U



1700434 - Lock Washer - 3/8"

V

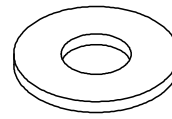

1702114 - Flat Washer - 1/2"

NOTE: Use lock washers and nuts with self-tapping screws whenever possible. A minimum material thickness of 3/16" is required in order to use self-tapping screws without lock washers and nuts. Drill 13/32" holes if lock washers and nuts are used; drill 5/16" holes if lock washers and nuts are not used.

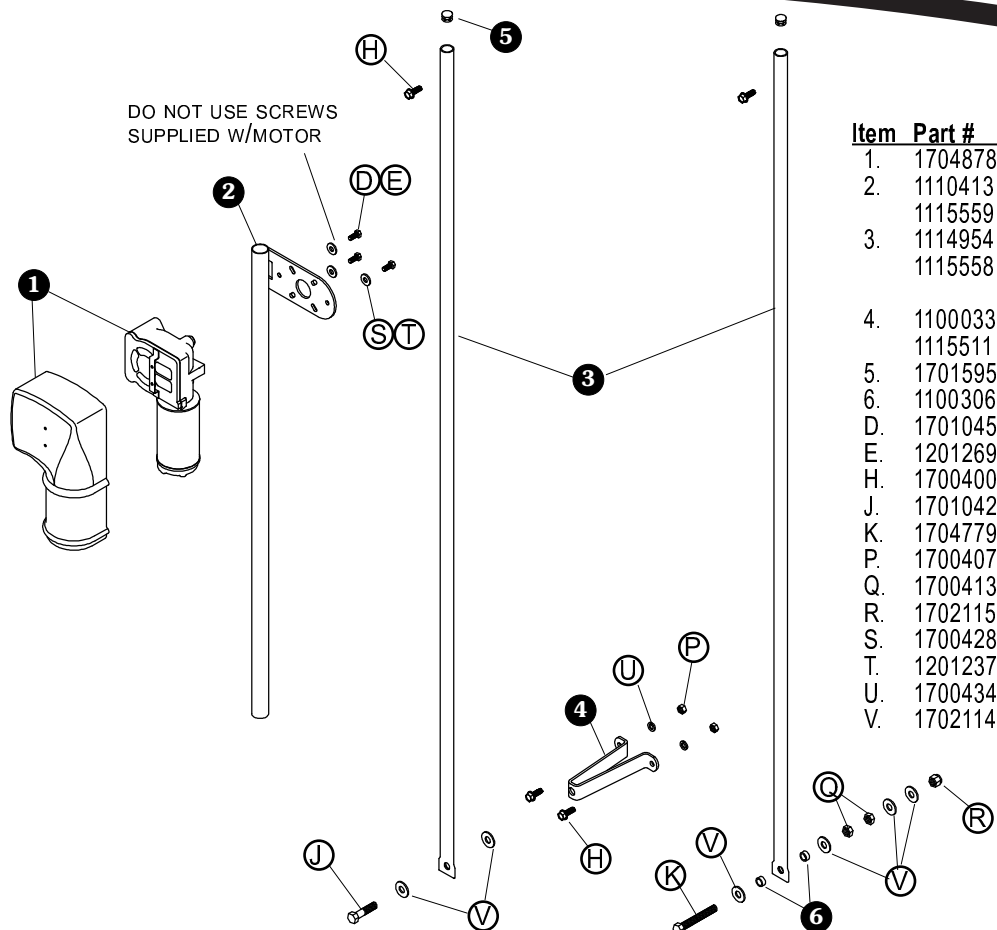

Item	Part #	Description
1.	1704878	Durabuilt Electric Motor
2.	1110413	Slide Arm
	1115559	Slide Arm - SS
3.	1114954	Value Series Electric Swing Arm
	1115558	Value Series - SS
		Electric Swing Arm
4.	1100033	Crank Retainer Standoff - 7"
	1115511	Crank Retainer Standoff - 7" - SS
5.	1701595	End Plug - 1"
6.	1100306	Retainer Bushing - 11/16" x 5/16"
D.	1701045	Cap Screw - 5/16" x 3/4"
E.	1201269	Cap Screw - 5/16" x 3/4" - SS
H.	1700400	Self-Tapping Screw - 3/8" x 1"
J.	1701042	Cap Screw - 1/2" x 2"
K.	1704779	Cap Screw - 1/2" x 3"
P.	1700407	Hex Nut - 3/8"
Q.	1700413	Jam Nut - 1/2"
R.	1702115	Nylon Lock Nut - 1/2"
S.	1700428	Flat Washer - 5/16"
T.	1201237	Flat Washer - 5/16" - SS
U.	1700434	Lock Washer - 3/8"
V.	1702114	Flat Washer - 1/2"

STEP 1: Farm bodies. Locate center line on front of box. Drill 9/16" hole on center line 38" to 56" from top of box.

Semi trailers. Locate center line on front of truck box. Drill 5/16" holes through 7" standoff on center line 38" to 56" from top of box.

NOTE: Installation procedures and/or parts used may vary to fit truck box.

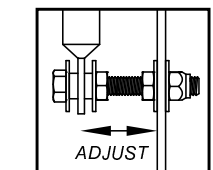
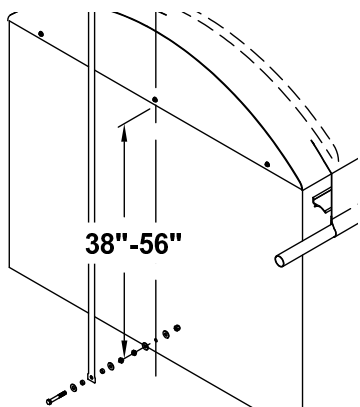

NOTE: Swing arm must operate without interference. Locate hole to allow clearance for swing arm operation.

STEP 2: Fasten as shown below. For farm bodies, adjust as needed to allow clearance for arm and motor, to avoid hitting any obstacles.

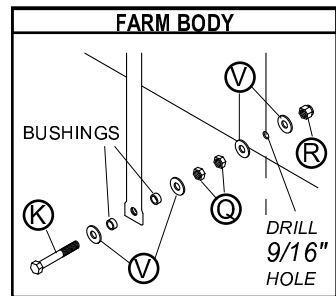
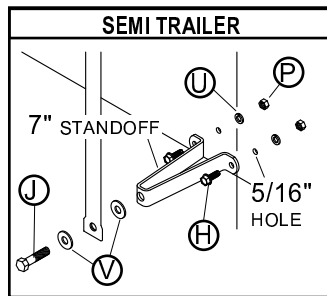

STEP 3: Mount electric motor to upper slide arm, fastening with screws D or E, and washers S or T.

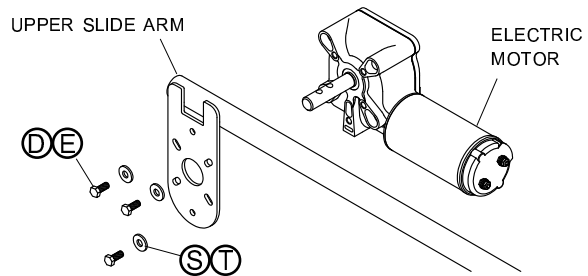

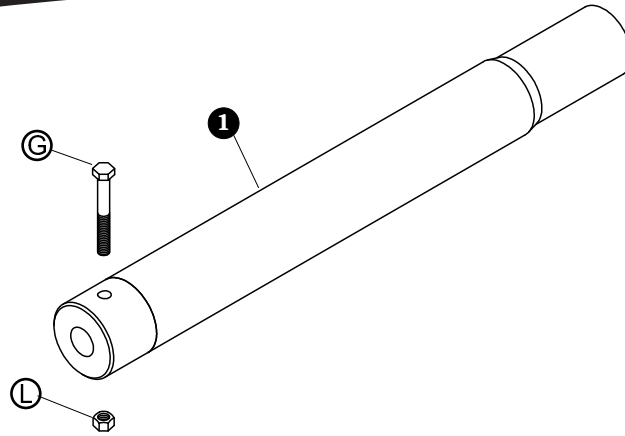

Item	Part #	Description
1.	1114916	Roll Tube Extension w/Adapter
G.	1703237	Cap Screw - 5/16" x 2 1/2"
L.	1702492	Top Lock Nut - 5/16"

STEP 1: Roll tarp closed over box with roll tube hanging below latchplate. Remove crank assembly from roll tube.

STEP 2: Hold motor and install upper slide arm over lower swing arm. Insert motor shaft into roll tube adapter. Fasten with screw **G** and nut **L**. Align swing arm vertically so it swings freely without hitting any obstacles.

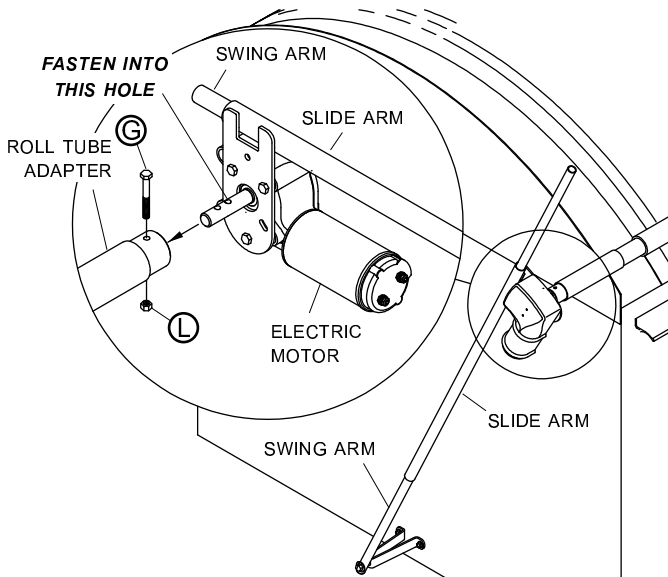

STEP 3: At front of trailer, slide tarp back on roll tube and adjust roll tube away from any obstructions, leaving space for roll tube eye and retaining rings on roll tube.

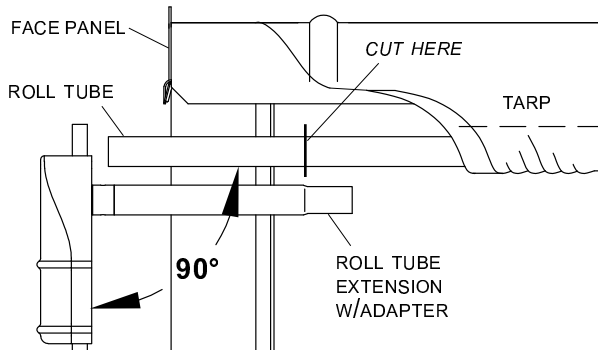

STEP 4: Hold swing/slide arms with motor and roll tube extension 90° to roll tube. Mark roll tube and cut at marked location.

STEP 5: Unfasten and remove motor from roll tube extension. Insert swaged end of roll tube extension w/drive shaft into roll tube. Align extension straight with roll tube and weld all around. Grind smooth.

NOTE: Pull roll tube away from tarp and trailer before welding to protect from weld spatter. Align roll tube extension straight with roll tube before welding so tarp system will roll smoothly.

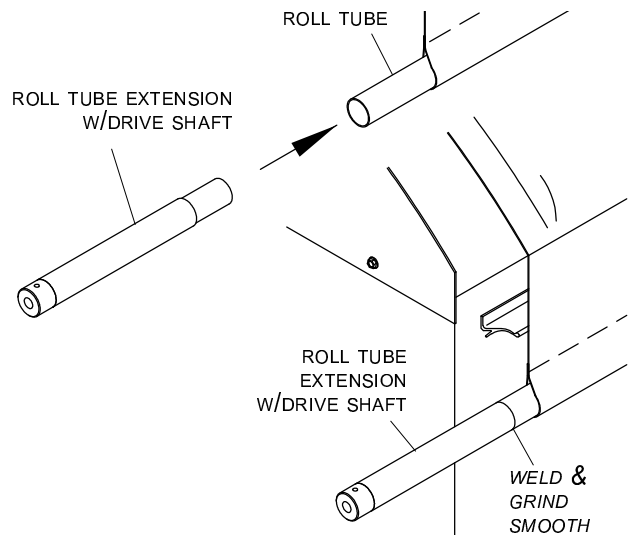

NOTE: To prevent rust, paint all exposed metal, such as weld seams and/or metal exposed by grinding or cutting, with corrosion-resistant paint.

STEP 6: Slide roll tube extension weldment back into position.

Item	Part #	Description
1.	1703445	Stretch Cord Eye Bracket
2.	1114948	Stretch Cord Tie-Down Strap
3.	1100169	Stretch Cord - 138"
H.	1700400	Self-Tapping Screw - 3/8" x 1"

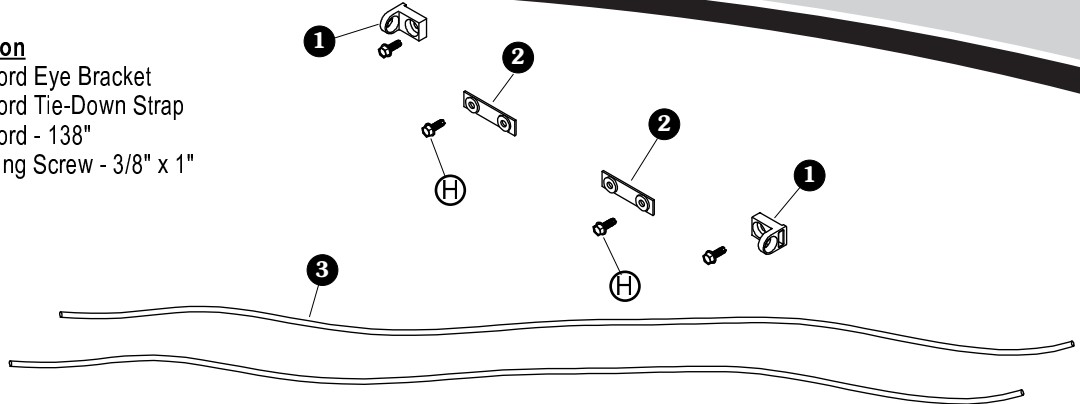

STEP 1: Open tarp against tarp stops. At rear of box and on square front boxes without obstructions, locate eye bracket in configuration shown at left. For non-square front boxes, notch latchplate 1" and align eye bracket with edge of notch on latchplate.

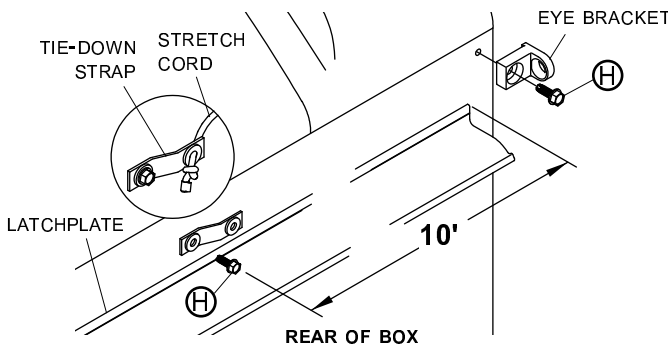
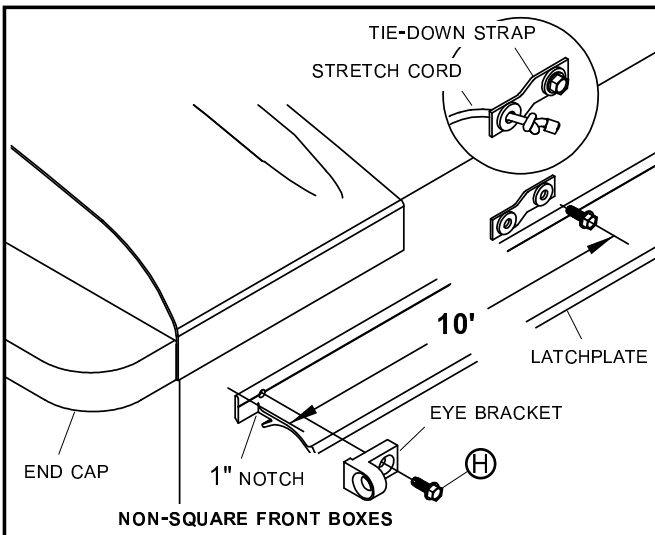
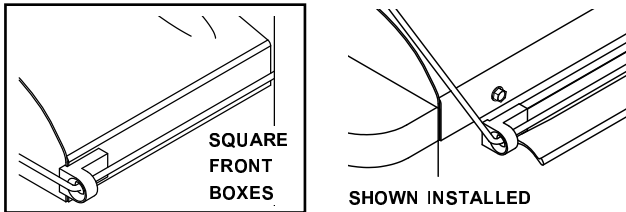

STEP 2: Using eye brackets as guide, mark and drill 5/16" holes in trailer. Fasten brackets to trailer with screws (H).

STEP 3: Mount stretch cord tie-down straps 10' back from outer edges of latchplate. Drill 5/16" holes and fasten with screws (H).

STEP 4: Lead first stretch cord through front eye bracket, then through grommet on rear tie-down strap. Lead second stretch cord through rear eye bracket, then through front tie-down strap. Tie knots in stretch cords at tie-down straps to secure. Trim ends of stretch cords and wrap with tape to prevent fraying.

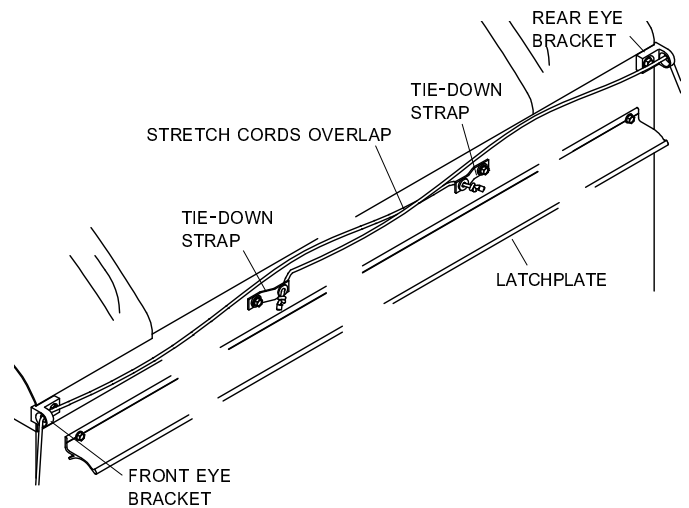

Item	Part #	Description
1.	1701354	Plastic U-Clamp
2.	1704352	Retaining Collar
3.	1114947	Roll Tube Eye
A.	1700398	Self-Drilling Screw - 1/4" x 3/4"
B.	1705198	Self-Drilling Screw - 1/4" x 1"

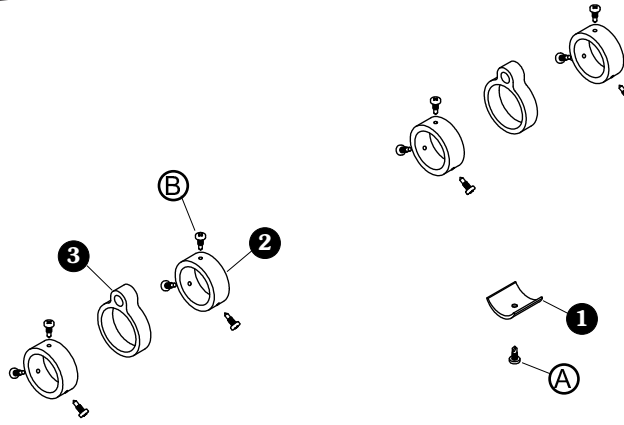

STEP 1: Roll tarp closed and let hang. Slide roll tube eyes and retaining collars onto front and rear of roll tube. Refasten motor to roll tube and re-align swing arm vertically so arm swings freely without interference. When swing arm is aligned and roll tube is in place, secure tarp to roll tube with U-clamps, fastening with screws A.

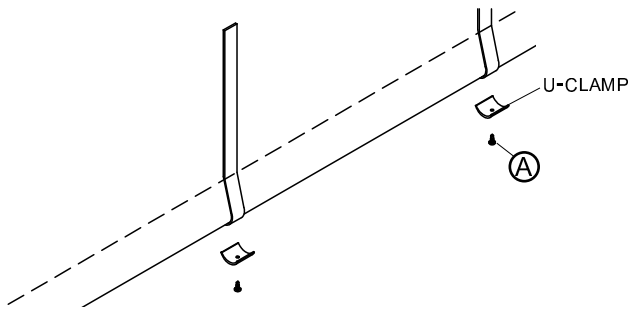

STEP 2: Allow stretch cords to hang down. Slide roll tube eyes onto each end of roll tube and align eyes about 1" from stretch cords, toward outside of trailer. Space retaining rings about 1/8" from each side of roll tube eyes. Tighten screws B to secure retaining rings.

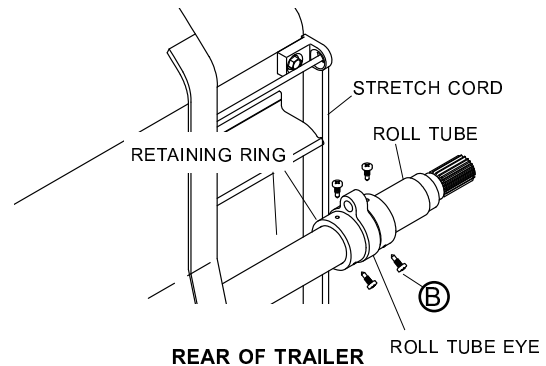
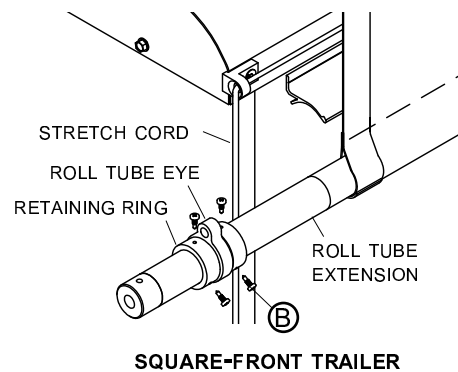
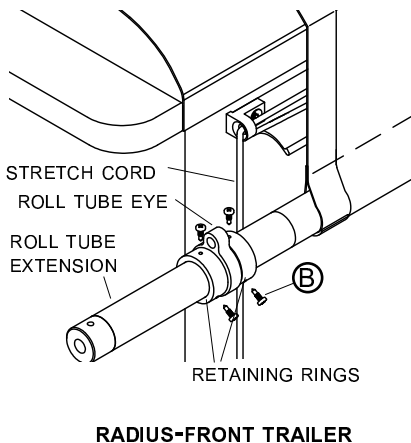

STEP 3: With lower swing arm extending past top of slide arm and motor in most extended position, drill 5/16" hole in lower swing arm. Install screw H to secure slide arm. Remove excess length on swing arm, if required, and install end plug.

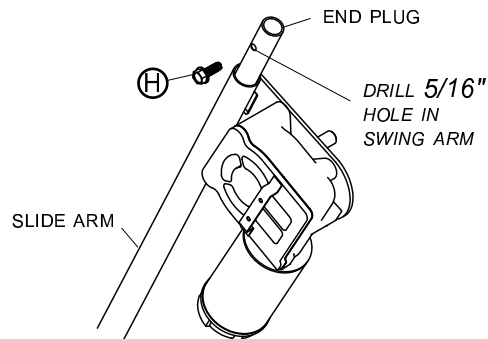

STEP 4: Roll tarp closed tight under latchplate and pull stretch cords through roll tube eyes to create tension. Tie permanent knots in stretch cords at front and rear of roll tube.

NOTE: Stretch cord must not cross over windshield during operation.

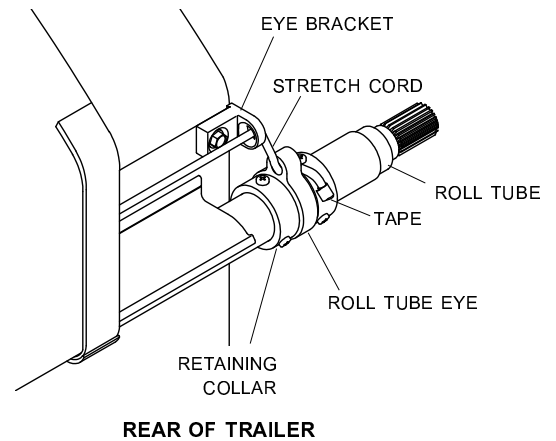
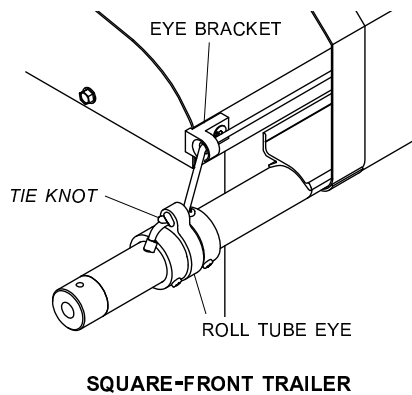
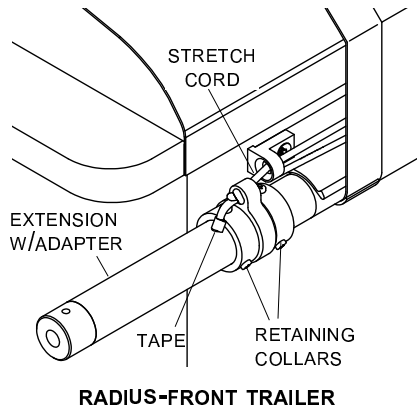

STEP 5: Roll tarp open and closed to make sure roll tube returns correctly. Adjust tension in shock cords as needed. Trim end of stretch cord and wrap with tape to prevent fraying.

WIRING TIPS

- ▶ Pick up power at battery or terminal block. Use 6-ga. wire or larger when connecting to power supply and motor.
- ▶ Do not locate wiring in areas where wire could be pinched or cut during operation. Be sure to leave enough loop in wire at slide arm.
- ▶ If switch is running system backwards, reverse 14-ga. wires at solenoid or switch.
- ▶ System will run only while momentary contact switch is depressed.

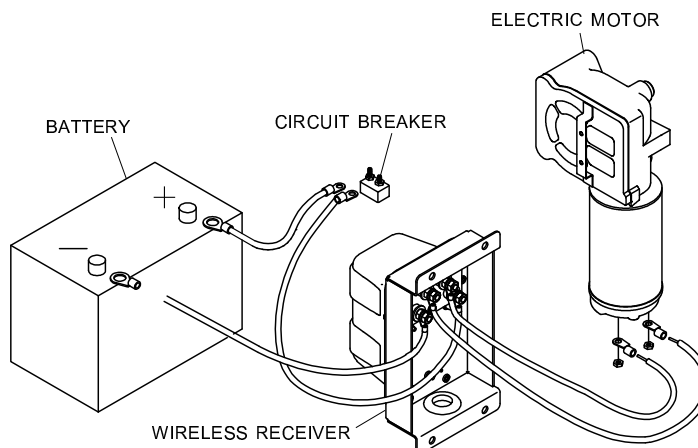

Item	Part #	Description
1.	1703245	Ring Terminal - 6 Ga. x #10 Stud
2.	1704354	40-Amp Modified-Reset Circuit Breaker
	1703480	50-Amp Auto-Reset Circuit Breaker
3.	1703244	Ring Terminal - 6 Ga. x 3/8" Stud
4.	1703660	Ring Terminal - 14 Ga. x 5/16" Stud
5.	1116482	Electrical Wire - 14 Ga. 3-Lead SL 15'
6.	1702707	Ring Terminal - 6 Ga. x 1/4" Stud

NOTE: Wireless receiver must be mounted on vertical surface, within 15' of rocker switch. See instructions P/N 1119352.

Determine mounting location for wireless receiver. Receiver may be mounted on back of cab or on frame. Determine best route for wire - usually along frame with existing wire harness. Run 6-ga. wire from motor to receiver and from power supply to receiver.

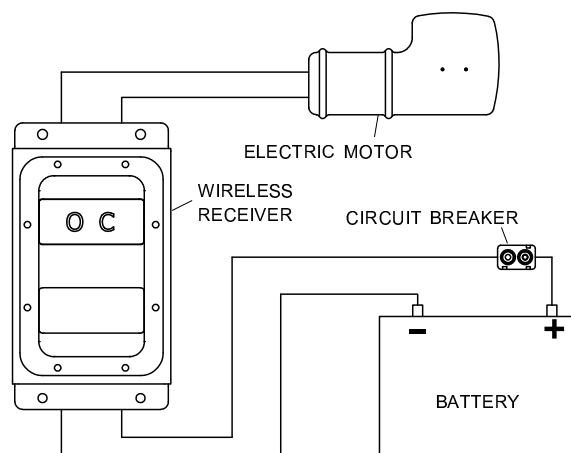

TROUBLESHOOTING ELECTRIC SYSTEM

If electric motor is not working, follow these steps.

STEP 1: To determine if motor is malfunctioning, disconnect both power wires from motor. Using either set of jumper cables and fully charged spare battery or battery charger, supply momentary power to motor terminals. Motor output shaft should turn. Reverse jumper cable connection to motor and verify motor shaft turns in opposite direction. If motor does not run correctly, please call our Customer Service department. If motor does run when connected to spare battery, then motor is OK. Reconnect original power wires to motor and continue to step 2.

STEP 2: Using test light or voltage meter, verify **BATT+** and **BATT-** terminals on solenoid are properly connected and power is reaching solenoid. If power is not reaching solenoid, check circuit breaker between battery and solenoid for problems such as loose terminals. Check for worn, broken or pinched wire. If power is reaching solenoid, continue to step 3.

STEP 3: Using small piece of jumper wire, momentarily connect **T1** terminal to **BATT+** terminal on solenoid. Repeat with **T2** terminal to **BATT+** terminal on solenoid. You should hear solenoid click in each instance and motor should operate each time. If you do not hear the click, please call our Customer Service department. If you hear the click but the motor does not operate, check wiring between solenoid and motor. If you hear the click **and** the motor operate, solenoid is OK. Continue to step 4.

NOTE: Step 4 assumes use of **SPDT momentary (ON) - OFF - (ON)** switch with same functionality as shipped with solenoid. If using something else, such as lighted switch, adjust accordingly.

STEP 4: Using small piece of jumper wire, momentarily connect switch center terminal (common) to an outer terminal. Repeat on other terminal. If motor does not operate during test, problem is in switch. Call our Customer Service department.

Item	Part #	Description
1.	1123582	Shur-Co® Wireless Receiver - SMART1+™ w/SMARTwire™
2.	1704354	40-Amp Modified-Reset Circuit Breaker
3.	1702707	Ring Terminal - 6 Ga. 1/4" Stud
4.	1704330	Rubber Insulating Boot
5.	1123160	5-Channel SMART1+™ Remote
F.	1702926	Cap Screw - 5/16" x 7/8"
N.	1700419	Lock Nut - 5/16"
T.	1201237	Flat Washer - 5/16"

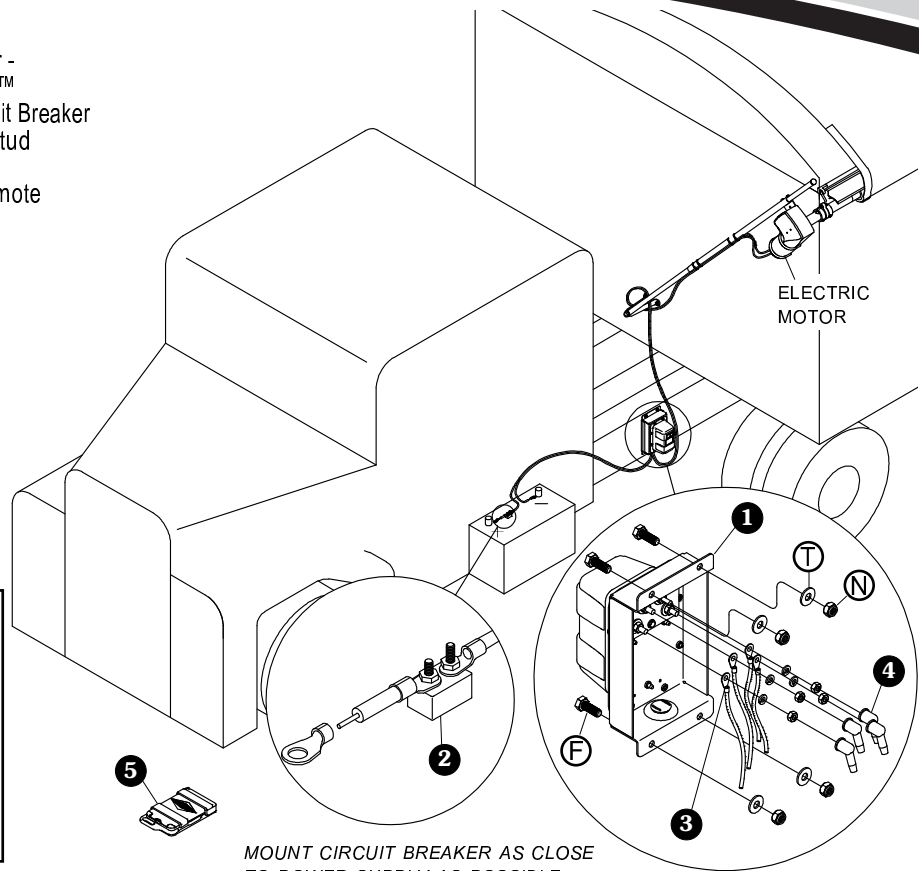

ELECTRIC MOTOR

NOTE: Cut wires to length and strip only enough wire insulation to install ring terminals. Insert bare wire into ring terminals and crimp securely.

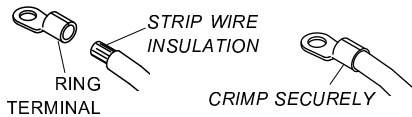

MOUNT CIRCUIT BREAKER AS CLOSE TO POWER SUPPLY AS POSSIBLE

STEP 1: Circuit breaker. Mount circuit breaker as close as possible to battery or power supply.

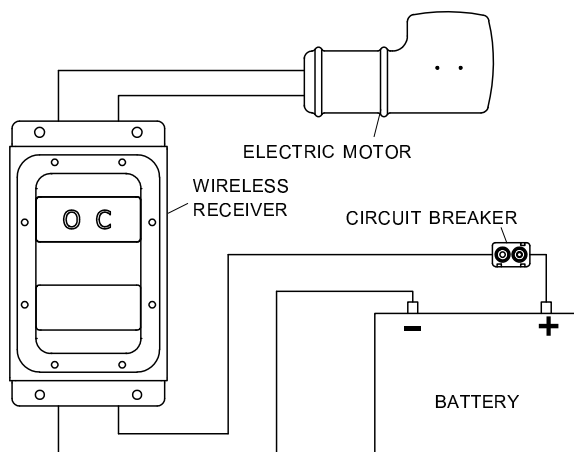

NOTE: Use dielectric grease (P/N 1704378) to prevent corrosion on terminals.

STEP 2: Electric motor. Connect wires as shown. Push shrink wrap over connections and apply heat to seal.

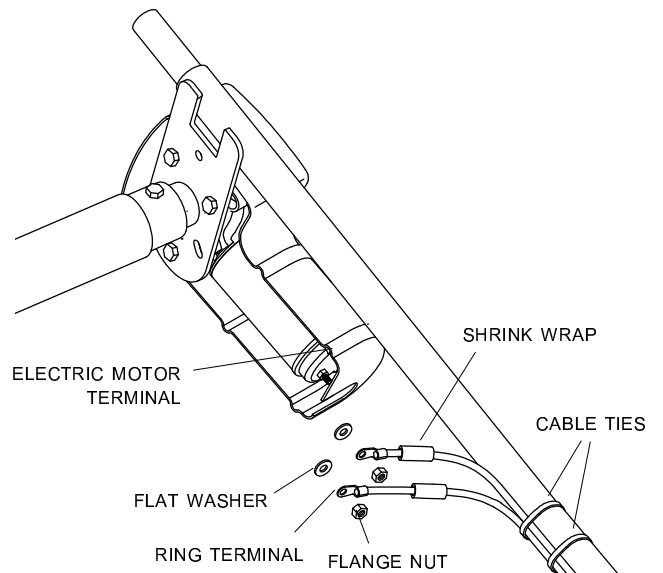

STEP 3: Fasten motor cover to motor with screws supplied.

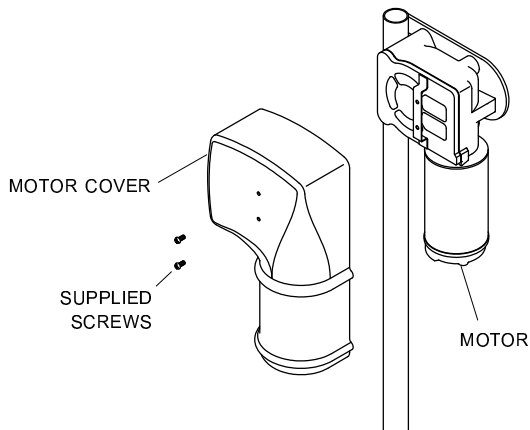

CAUTION

Check all hardware for complete assembly before operating. Inspect system at this time and adjust as required.

OPERATION:

A) Check motor direction by activating switch to "OPEN." If switch is running system backwards, change wire leads on motor to opposite connections.

B) Close tarp: Push switch to "CLOSE" and hold. Observe tarp and release switch when tarp is fully closed.

C) Open tarp: Push switch to "OPEN" and hold. Observe tarp and release switch when tarp is fully open.

NOTE: Release switch at end of cycle or modified-reset circuit breaker will trip. After breaker resets, switch will activate motor again. To reduce unnecessary strain on tarp components, release switch at end of each cycle.

NOTE: Pressure wash. Receiver may be pressure washed, but keep nozzle at least 3' from system while spraying.

POWER UP/DOWN

Remote will power up when lid is opened. Remote will power down when lid is closed or when lid is left open three minutes after last button is pushed.

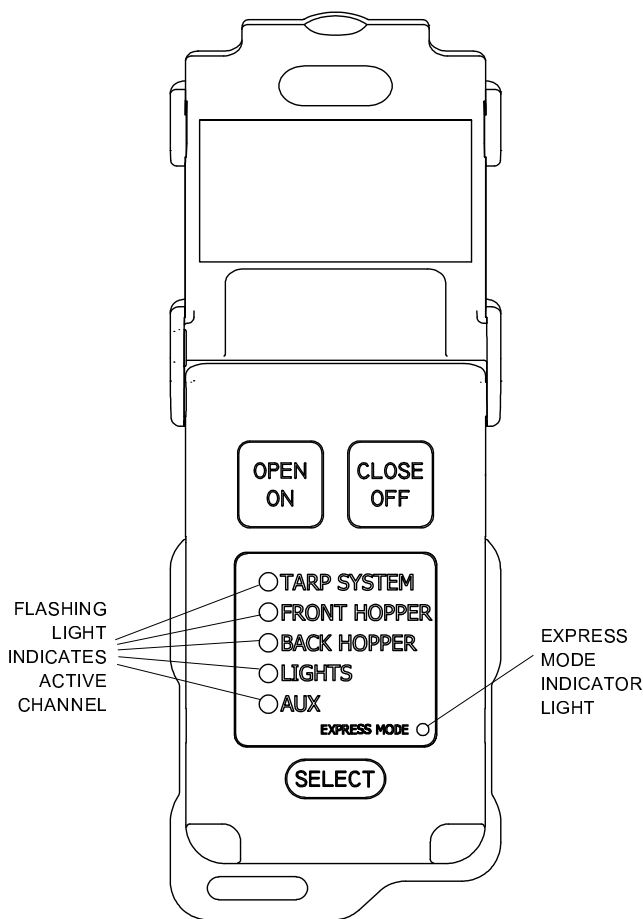

STANDARD OPERATION

After power-up, first channel will be immediately active and indicator light will be flashing. *Open/On* and *Close/Off* buttons are operational for indicated active channel. While either *Open* or *Close* button is pressed, indicator light for active channel will flash faster, indicating command is being transmitted on active channel. *Select* button will cycle between enabled channels.

Each channel on remote can be set to operate in either *Momentary Mode* or *Express Mode*.

Momentary Mode: While remote channel is in *Momentary Mode*, *Open* or *Close* button must be held down to operate system.

NOTE: Some Shur-Co® products are not compatible with **EXPRESS MODE**. If motor does not have encoder wire, remote will operate in *Momentary Mode* only.

Indicator light labeled **EXPRESS MODE** will be off when remote is in *Momentary Mode*.

If remote channel is in *Momentary Mode*, you may still force system to open or close automatically one time by pressing *Open* or *Close*, then simultaneously pressing *Select* button. System will continue to operate until fully open or closed. System can be stopped at any time by pressing any button on remote or closing remote lid.

Indicator light labeled *Express Mode* will be lit for first five seconds after initiating "One Time" Express command.

Express Mode: While remote channel is in *Express Mode*, *Open* or *Close* button can be pressed and released. System will continue to operate until fully open or closed. System can be stopped at any time by pressing any button on remote or closing remote lid.

Indicator light labeled **EXPRESS MODE** will be on when remote is in *Express Mode*.

PAIRING (INTRODUCING) REMOTE(S) TO RECEIVER

Receiver will accept and respond to signals from up to five remotes. Receiver will not respond to signals from remotes that have not been paired to it.

NOTE: Remotes are typically paired to receivers at factory if remote is shipped with receiver.

Follow instructions below to pair remote(s) to receiver:

1. Remove solenoid cover from receiver assembly, pulling gently on cover to prevent damage to wires connected to cover.

NOTE: Only SMART1+™ remotes will function with SMART1+™ receivers. Original SMARTtransmitter® cannot be used.

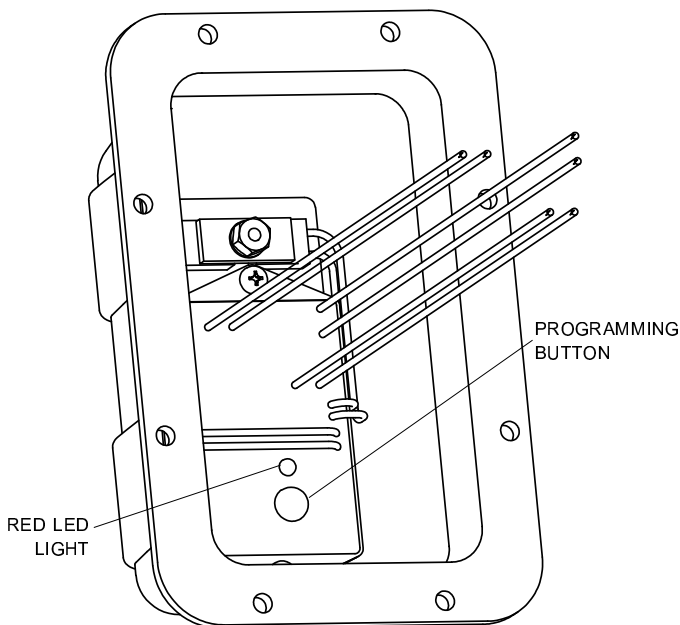

2. Check to be sure receiver is connected to 12-volt power supply. Receiver must be connected to power to be programmed. If battery disconnect switch is installed, make sure it is turned on.

NOTE: Read following steps entirely before proceeding. Programming must be completed within 20 seconds. Receiver will exit program mode after 20 seconds, whether or not it has received five Open/On button signals from remote.

3. Receiver can learn to recognize up to five remotes. Gather all remotes to be introduced to receiver. Open remote lid(s) to activate.
4. Set remote(s) to appropriate channel (*Tarp System*).
5. Press and hold programming button on receiver for five seconds. Red light will start flashing to indicate it is in programming mode. Release programming button. Red light will now turn off.

Single SMART1+™ remote:

- 6a1. On remote, press *Open/On* button five times. Red light on receiver will flash after each button press. After receiving last signal, light will flash twice, then begin flickering, indicating it has been successfully programmed.
- 6a2. Verify remote and receiver are operating correctly, then refasten solenoid cover.

Multiple SMART1+™ remotes:

- 6b1. Press *Open/On* button on first remote. Red light will flash after receiving signal.
- 6b2. Repeat above step for each remote being used.
- 6b3. Receiver will accept up to five signals. Press *Open/On* button additional times on last remote being programmed to achieve total of five signals. Red light on receiver will flash twice after last (fifth) signal, then begin flickering, indicating it has been successfully programmed (see programming example).
- 6b4. Verify each remote and receiver are operating correctly, then refasten solenoid cover.

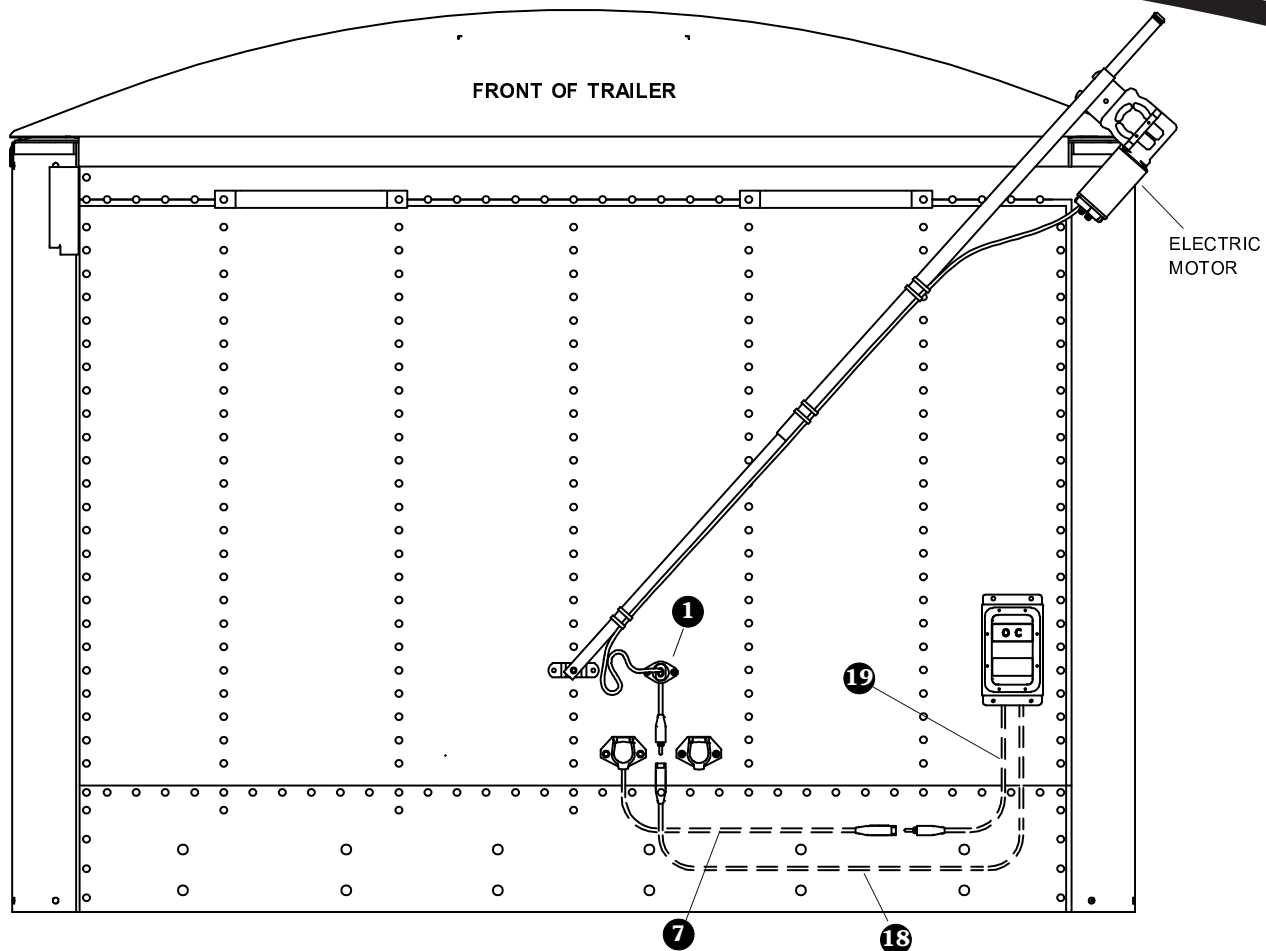

NOTE: Wire lengths are predetermined. Before installing SMARTwire™ components, review and confirm wire routing so wires reach components with ample room for connection.

DUAL-POLE CONDUCTOR-SOCKET INSTALLATION

STEP 1: Locate dual-pole conductor socket near seven-pole conductor socket as shown. Determine location and drill 2" hole through trailer skin.

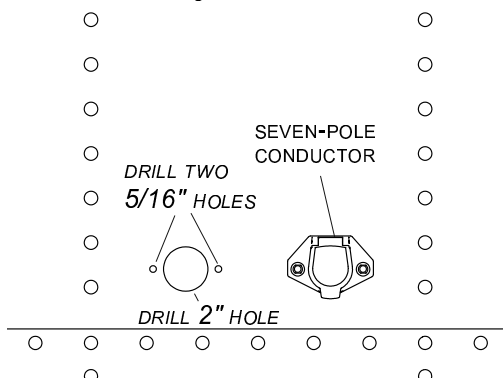

STEP 2: Align socket over 2" hole. Using holes in flanges on socket as guide, mark and drill two 5/16" holes.

STEP 3: Fasten conductor socket to trailer with 5/16" x 3/4" cap screws, flat washers and nuts.

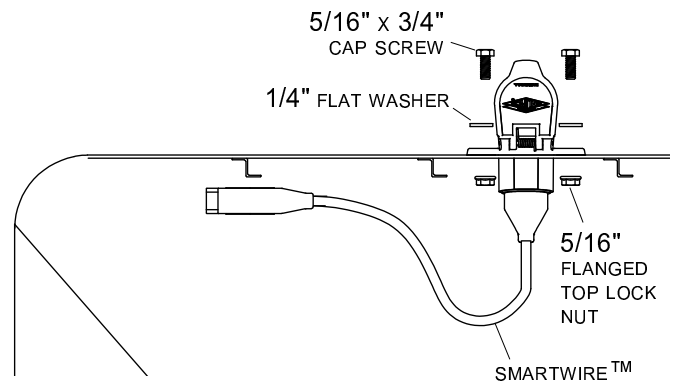

SHUR-CO® WIRELESS RECEIVER INSTALLATION

STEP 1: Locate Shur-Co® wireless receiver as shown on previous page. Determine location and drill 2" hole through trailer skin.

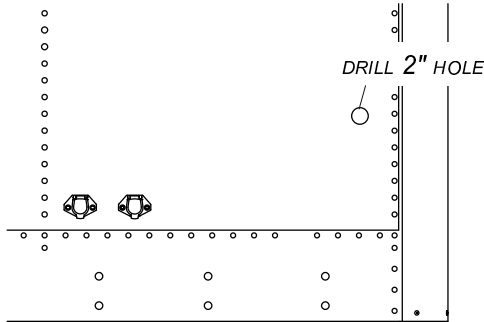

STEP 2: Align holes in wireless receiver over 2" hole in trailer as shown below. Using holes on flanges on receiver as guide, mark and drill four 5/16" holes as shown.

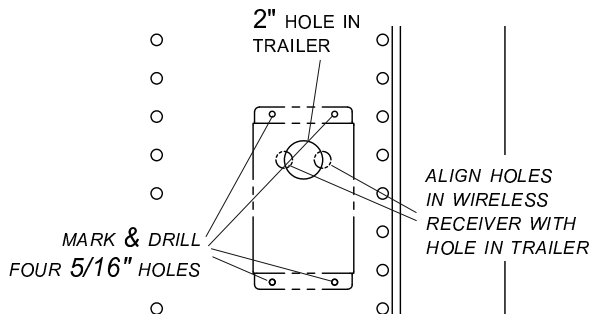

STEP 3: Install grommet into 2" hole. Insert wire from wireless receiver through grommet.

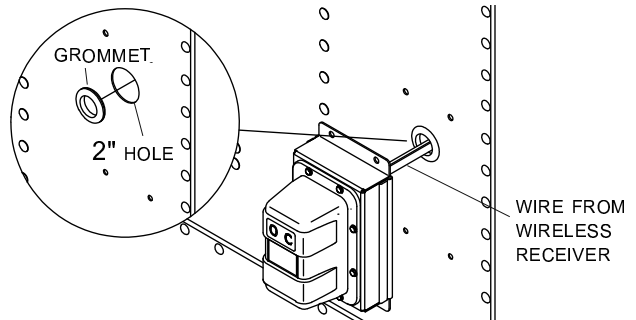

STEP 4: Align holes on wireless receiver with holes on trailer. Fasten receiver to trailer with 5/16" x 7/8" cap screws, lock washers and nuts.

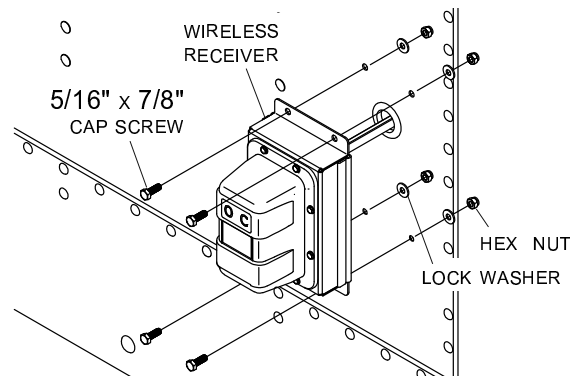

ADAPTER PLUG INSTALLATION

STEP 1: Measure 11" horizontally from center line of trailer and 1" down from lower edge of pivot bracket. Mark and drill 1 1/2" hole through trailer skin.

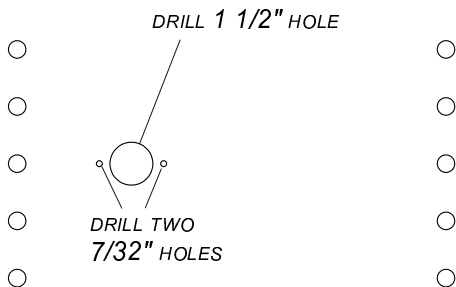

STEP 2: Align adapter plug with 1 1/2" hole. Using plug as guide, mark and drill two 7/32" holes as shown.

STEP 3: Fasten adapter plug to front of trailer with 1/4" x 3/4" cap screws, lock washers and nuts.

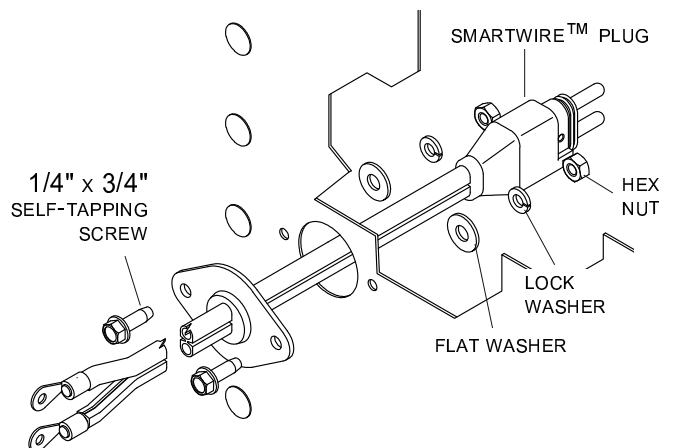

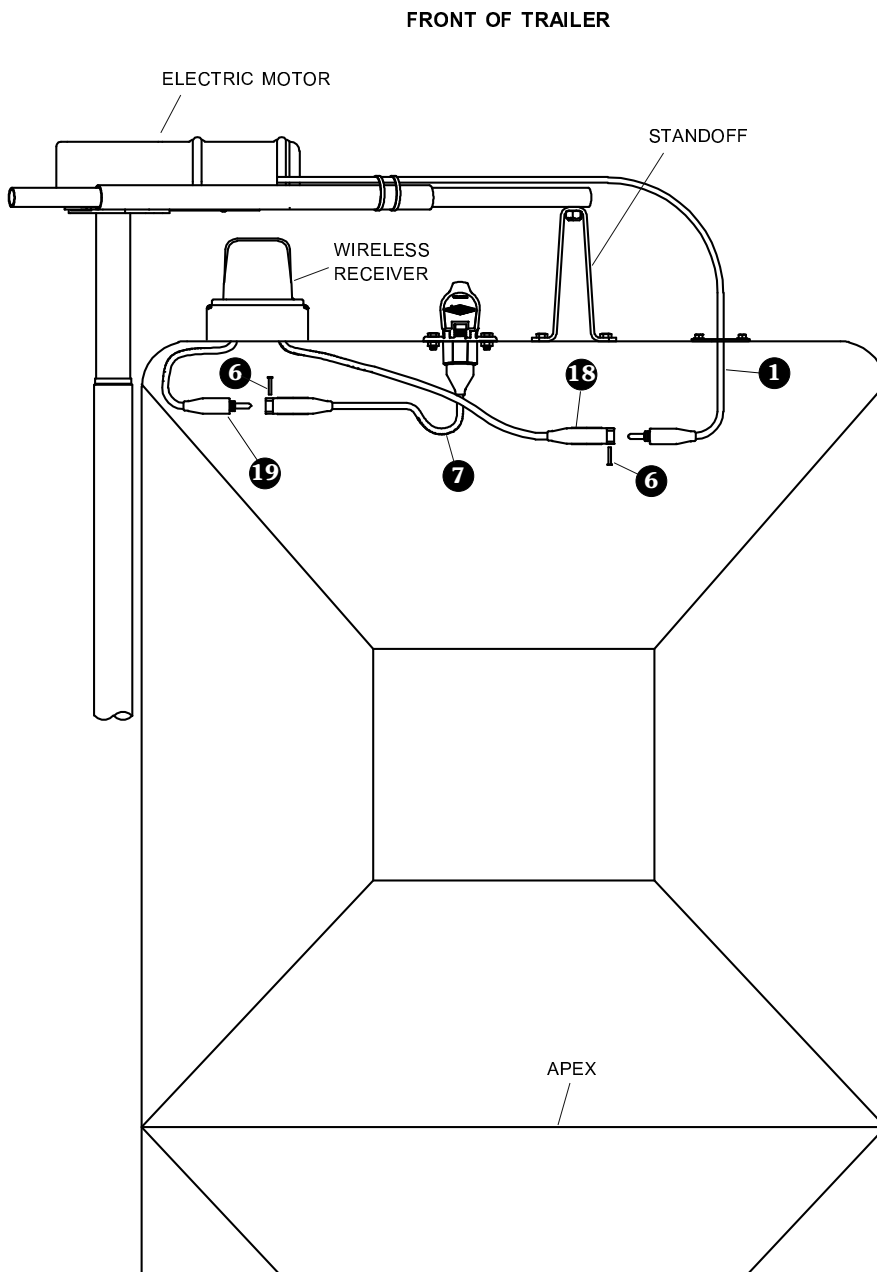

FRONT OF TRAILER

ELECTRIC MOTOR

STANDOFF

WIRELESS RECEIVER

NOTE: Coat each connection with dielectric grease (P/N1704378) to prevent corrosion.

CAUTION
Do not fasten SMARTwire™ components to trailer through hopper walls.

FRONT OF TRAILER

- STEP 1:** Route SMARTwire™ 18 from wireless receiver to adapter plug 1. Connect wire to adapter plug and secure with lock pin 6.
- STEP 2:** Connect SMARTwire™ 19 from wireless receiver into SMARTwire™ 7 and secure connection with lock pin 6.
- STEP 3:** Secure all wires to trailer with cable clips and screws 19. If needed, use cable ties.

NOT TO SCALE

ELECTRIC COMPONENTS

Item	Part #	Description
1.	1703245	Ring Terminal - 6 Ga. x #10 Stud - Motor/Breaker
2.	1703244	Ring Terminal - 6 Ga. x 3/8" Stud - Battery
3.	1703660	Ring Terminal - 14 Ga. x 5/16" Stud - Solenoid
4.	1703659	Push-On Terminal - 14 Ga. x 1/4" - Switch/Solenoid
5.	1702707	Ring Terminal - 6 Ga. 1/4" Stud - Motor/Solenoid
6.	1704354	40-Amp Modified-Reset Circuit Breaker
7.	1123160	5-Channel SMART1+™ Remote
	1705143	SMART1+™ Remote Battery - AAA Battery
8.	1116020	Rocker Switch
9.	1703822	Dual Conductor Wire - 6 Ga. 259-Strand
10.	1116482	Electrical Wire - 14 Ga. 3 Lead - 15'
11.	1703661	Rocker Switch Mounting Bracket
12.	1704813	Nylon Lock Nut - #10
13.	1704312	Motor-Reversing Solenoid - 3 Pt. Mt.
14.	1704367	Hex Flange Cap Screw - #10 x 3/4"
15.	1702108	Wire Clip - 3/4"
16.	1704338	Self-Tapping Screw - 1/4" x 1"
17.	1703231	Cable Tie - 8"
18.	1121367	SMARTwire™ - 6 Ga. - Plug - 10' 9" - Value Series
19.	1700403	Self-Tapping Screw - 1/4" x 3/4"
20.	1704751	Harness Lock Pin - 1/4" x 7/8"
21.	1700427	Flat Washer - 1/4"
22.	1700436	Lock Washer - 1/4"
23.	1700408	Hex Nut - 1/4"
24.	1120670	SMARTwire™ Dual-Conductor Socket
25.	1701045	Cap Screw - 5/16" x 3/4"
26.	1704946	Flanged Top Lock Nut - 5/16"
27.	1702926	Cap Screw - 5/16" x 7/8"
28.	1123507	Shur-Co® Wireless Receiver - SMART1+™ w/SMARTWire™
29.	1202938	Rubber Grommet - 1 1/2" Insert
30.	1700428	Flat Washer - 5/16"
31.	1700419	Lock Nut - 5/16"
32.	1120817	SMARTwire™ - 6 Ga. x 6' 3" - Socket
33.	1704705	SMARTwire™ - 6 Ga. x 2' 4" - Plug

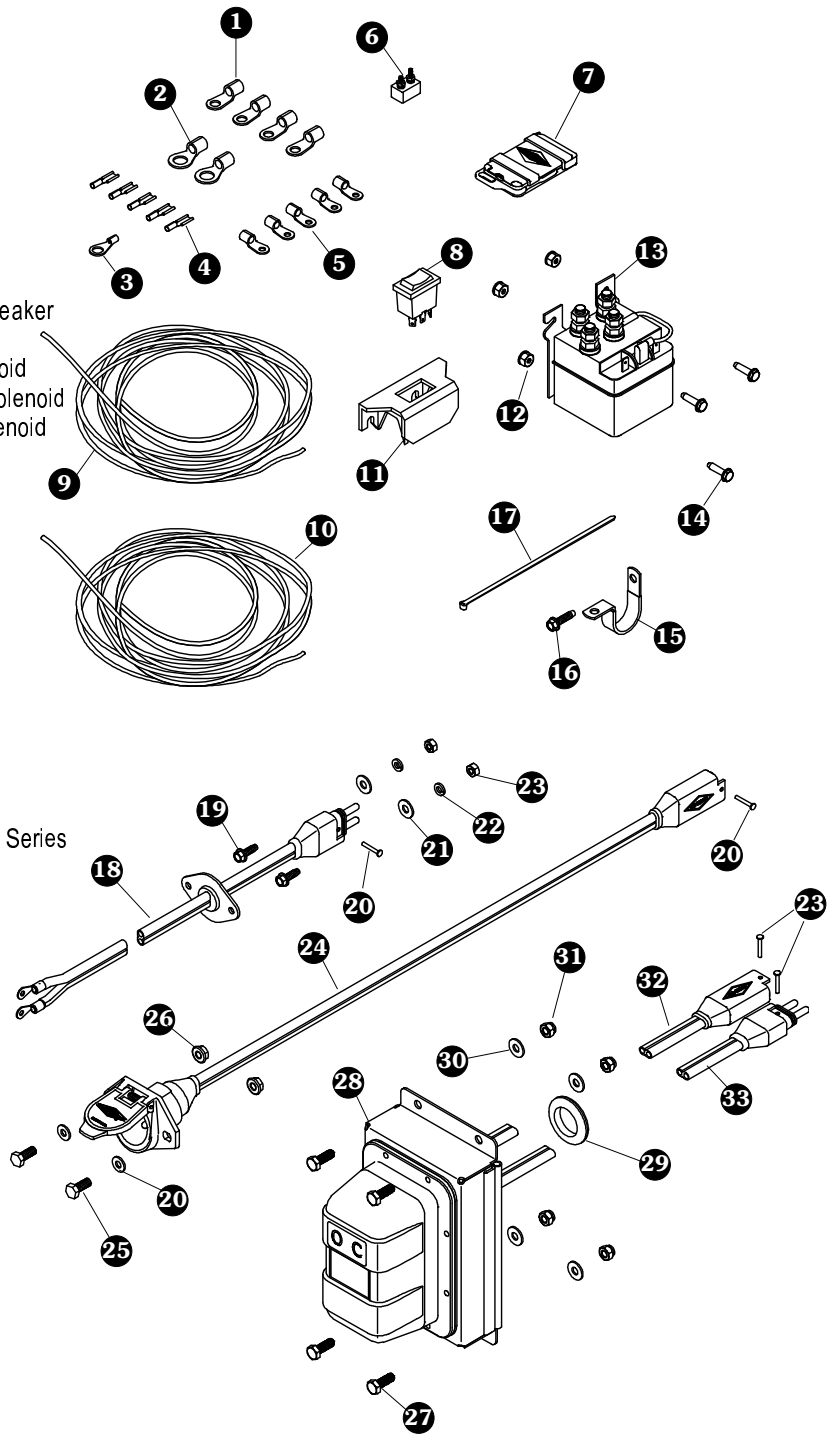

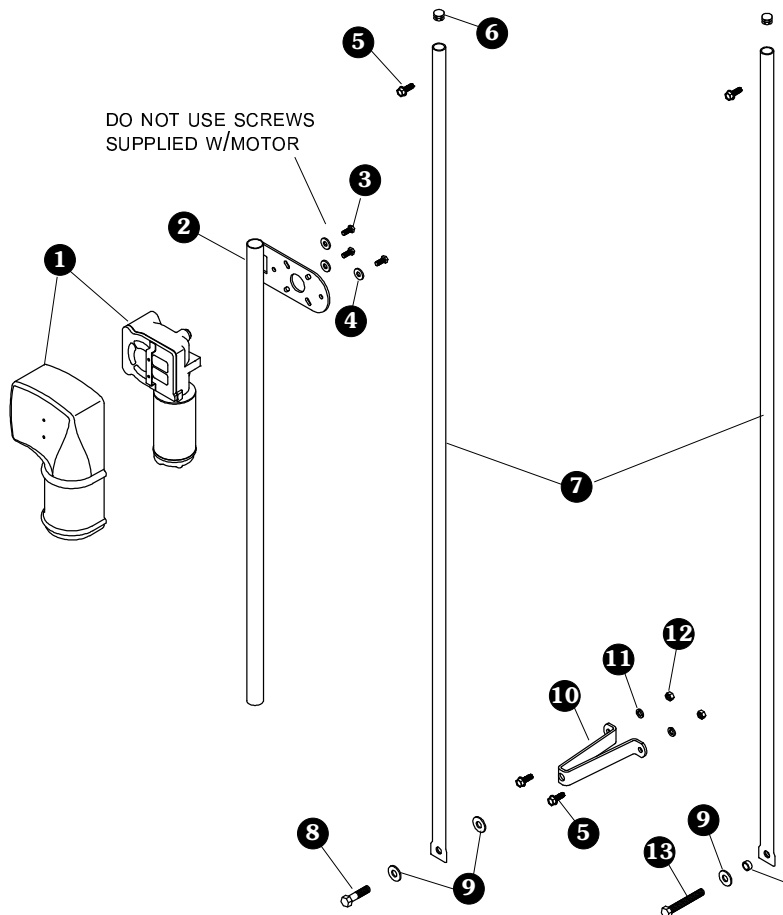

SWING ARMS, SLIDE ARMS & ELECTRIC MOTORS

Item	Part #	Description
1.	1704878	Durabuilt Electric Motor
2.	1110413	Slide Arm
	1115559	Slide Arm - SS
3.	1701045	Cap screw 5/16" x 3/4"
	1201269	Cap Screw - 5/16" x 3/4" - SS
4.	1700428	Flat Washer - 5/16"
	1201237	Flat Washer - 5/16" - SS
5.	1700400	Self-Tapping Screw - 3/8" x 1"
6.	1701595	End Plug - 1"
7.	1114954	Value Series Electric Swing Arm - SS
	1115558	Value Series Electric Swing Arm - SS
8.	1701042	Cap Screw - 1/2" x 2"
9.	1702114	Flat Washer - 1/2"
10.	1100033	Crank Retainer Standoff - 7"
	1115511	Crank Retainer Standoff - 7" - SS
11.	1700434	Lock Washer - 3/8"
12.	1700407	Hex Nut - 3/8"
13.	1704779	Cap Screw - 1/2" x 3"
14.	1700413	Jam Nut - 1/2"
15.	1100306	Retainer Bushing - 11/16" x 5/16"
16.	1702115	Nylon Lock Nut - 1/2"

ROLL TUBE EXTENSIONS & ROLL TUBE EYES

Item	Part #	Description
1.	1114916	Roll Tube Extension w/Adapter
2.	1703237	Cap Screw - 5/16" x 2 1/2"
3.	1702492	Top Lock Nut - 5/16"
4.	1704352	Retaining Collar
5.	1114947	Roll Tube Eye
6.	1705198	Self-Drilling Screw - 1/4" x 1"

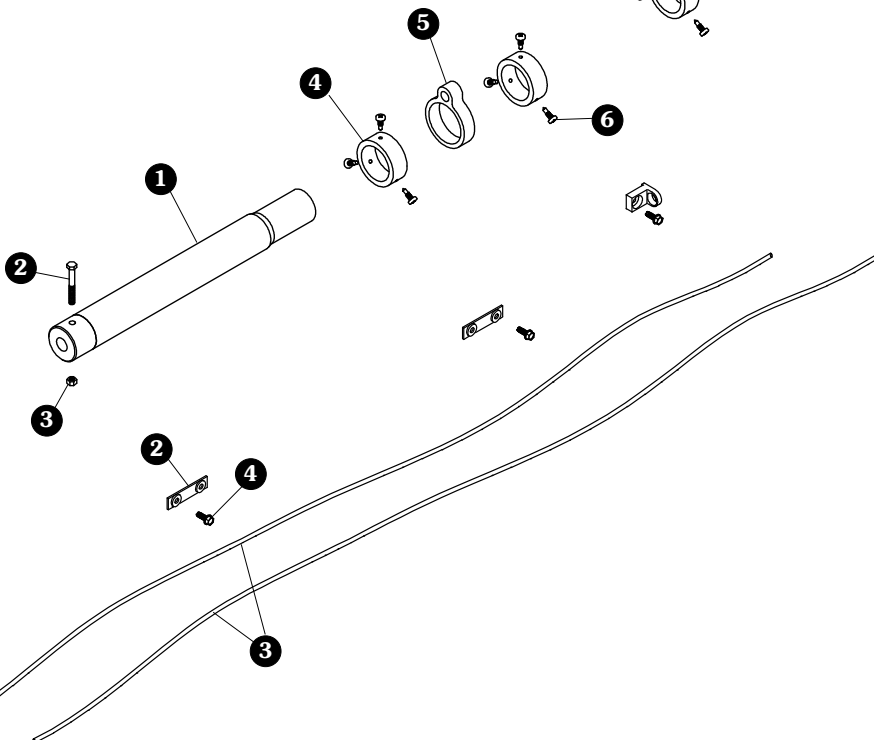

STRETCH CORDS

Item	Part #	Description
1.	1703445	Stretch Cord Eye Bracket
2.	1114948	Stretch Cord Tie-Down Strap
3.	1100169	Stretch Cord - 138"
4.	1700400	Self-Tapping Screw - 3/8" x 1"

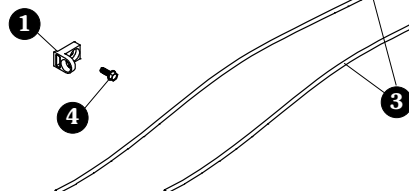

Our **Advanced Troubleshooting Guide** is available on our website: <http://www.shurco.com>, or call our Help Line: **1-866-748-7435**.

PROBLEM:	TRY THIS:
<p>The SMART1+™ remote is not working.</p> <p>None of the lights on the remote turn on when I open the lid.</p>	<ol style="list-style-type: none"> 1. Make sure the batteries are placed correctly. 2. The batteries may be dead and must be replaced. AAA replacement batteries may be purchased from Shur-Co® (P/N 1703163). 3. The SMART1+™ remote may be damaged. Call Shur-Co's Help Line.
<p>The SMART1+™ remote is not working.</p> <p>I can operate the system with the rocker switch but not with the remote. The SMART1+™ remote channel light (Tarp System, for example) is blinking and when I press the Open/On button, the light blinks faster.</p>	<ol style="list-style-type: none"> 1. Make sure the remote is set to the right channel. If you cannot set the remote to the desired channel (<i>Tarp System</i>, for example), the remote must be reprogrammed. See the SMART1+™ programming instructions. 2. Make sure you are within a couple feet of the receiver and try again. <ol style="list-style-type: none"> a) If it works at short range but not at greater distances, you have a range problem. A new battery may be needed. If the remote battery is not the cause, call Shur-Co's Help Line. 3. Reprogram the receiver. See the receiver programming instructions. If this doesn't work, call Shur-Co's Help Line.
<p>The system will not operate with the rocker switch or with the SMART1+™ remote.</p> <p>When I try to use the rocker switch or SMART1+™ remote, I don't hear any noises (a clicking, for example) from the receiver.</p>	<ol style="list-style-type: none"> 1. Make sure the master disconnect switch is turned to the "ON" position. 2. The circuit breaker may have tripped. Wait one minute and try again. 3. Check the vehicle's battery to make sure it isn't dead. 4. Check all connections from the battery to the system. Check for polarity, good connections and corrosion. Verify that you have at least 12V on the back side of the receiver on the battery hookup posts. 5. Call Shur-Co's Help Line.
<p>The system will not operate with the rocker switch or with the SMART1+™ remote.</p> <p>When I try to use the rocker switch or SMART1+™ remote, I hear a clicking noise, but nothing happens.</p>	<ol style="list-style-type: none"> 1. Verify you have at least 12V on the back side of the receiver on the battery hookup posts. 2. Call Shur-Co's Help Line.
<p>The rocker switch is not sticking, but the motor continues to run after I release the rocker switch.</p>	<ol style="list-style-type: none"> 1. Call Shur-Co's Help Line.
<p>The rocker switch is sticking.</p>	<ol style="list-style-type: none"> 1. Check the switch for excessive dirt, rocks or other objects. If the rocker switch cannot be cleaned, call Shur-Co's Help Line for a replacement receiver. <p>The receiver may be pressure washed, but keep nozzle at least 3' from system while spraying.</p>

MORE QUALITY PRODUCTS FROM SHUR-CO®

- **Genuine Replacement Tarps**
- **Genuine Replacement Parts**

- **Agriculture Products**
 - Value Series Shur-Lok®
 - Super Duty Shur-Lok®
 - Shur-Lok® Junior
 - Premium Belt 'n Ratchet
 - Cable-Lok™
 - Turning Point™ Bow

- **SMARTrailer™ Accessories for Agriculture Products**
 - SMART2™ Remote
 - SMART1 +™ Remote
 - 4500 Series HD Electric
 - AutoTrap™ Hopper Opener
 - ProTrap® Hopper Opener
 - LiteALL™ Work Lights
 - Cable-Lok™ Electric Upgrade
 - Electric Turning Point™ Bow
 - Value Series Electric
 - Solar Power Pack

- **Flatbed Products**
 - ShurTite™ Retractable Tarps
 - Stock Lumber & Steel Tarps
 - Steel Tarps

- **Custom Products**
 - Fitted Truck Covers
 - Flat Utility Tarps
 - Bean Drill Covers
 - Shur-Lok® Tarp Cords

- **Construction Products**
 - Super Duty Shur-Lok®
 - Shur-Trak II™
 - Cover-Pro II®
 - Turning Point™ Bow
 - IronSide™ Side-Dump System
 - Arm-Matic™
 - DuraPull™
 - Econo-Pull™
 - Turbo Tarp2 DONOVAN BRAND
 - 2000 Series DONOVAN BRAND
 - 5000 Series DONOVAN BRAND
 - Hammer DONOVAN BRAND
 - Bullet DONOVAN BRAND
 - Flash DONOVAN BRAND
 - Long Arm DONOVAN BRAND

- **SMARTrailer™ Accessories for Construction Products**
 - 4500 Series HD Electric w/Gate Flex™
 - Shur-Trak II™ Electric Upgrade
 - Cover-Pro II® Electric Upgrade
 - Electric Turning Point™ Bow
 - Solar Power Pack

- **Waste Products DONOVAN BRAND**
 - The Ox™
 - Quick-Flip III
 - Sidewinder
 - Sidewinder 350
 - HyTower SL
 - HyTower DL
 - Double-Flip