



TARPING SYSTEMS & ACCESSORIES

P/N 1124457 Rev. E

# INSTALLATION INSTRUCTIONS



## Electric Gate & Hoist System

*READ BEFORE INSTALLING*

PO BOX 713 ■ 2309 SHUR-LOK STREET ■ YANKTON, SD 57078-0713  
PHONE 1-800-4-SHUR-LOK (1-800-474-8756) ■ FAX 605-665-0501  
[www.shurco.com](http://www.shurco.com)

SHOP ONLINE: [www.shopshurco.com](http://www.shopshurco.com)

**STEP 1:** Determine location for control modules and actuator, positioning components where control wire from actuator reaches control modules. Do not mount at this time.

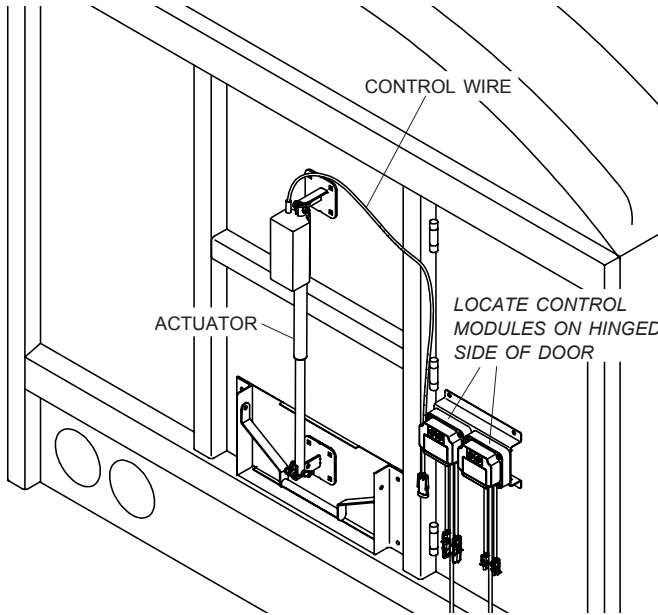

**STEP 2:** Determine location for air solenoids, placing near supply tank. Location may vary according to truck configuration. Do not mount at this time.

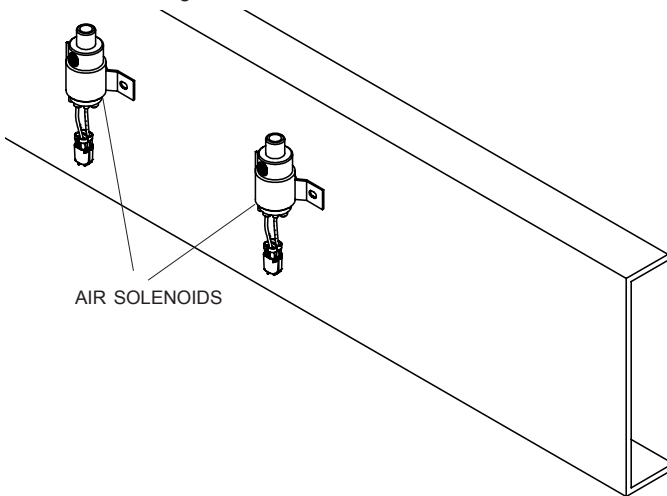

**STEP 3:** Loosely route power wire along frame from control module to battery.

**STEP 4:** Loosely route control wire along frame from air solenoid to control module.

**STEP 5:** Confirm control module, air solenoids and actuator locations are in reach of power and control wires from solenoid.

**NOTE:** Make sure wire locations do not interfere with doors opening. Leave sufficient wire for hoist to lift.

**STEP 6: Option 1.** Using holes in receiver bracket as guide, mark and drill 1/4" holes in box. Fasten control modules to receiver bracket with screws **5**. Fasten receiver bracket to box with screws **14**, washers **15** and nuts **16**.

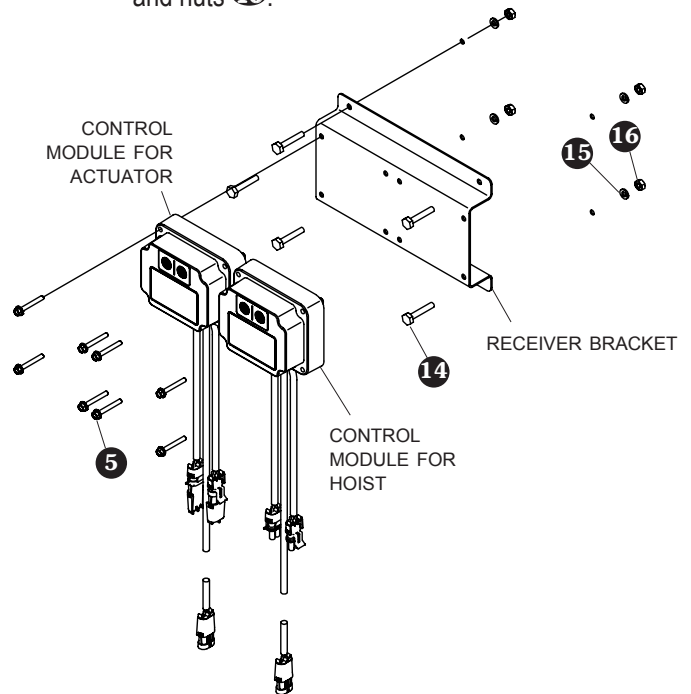

**STEP 6: Option 2.** Using holes in control modules as guide, mark and drill 1/4" holes in box. Fasten control modules to box with screws **5** and nuts **30**.

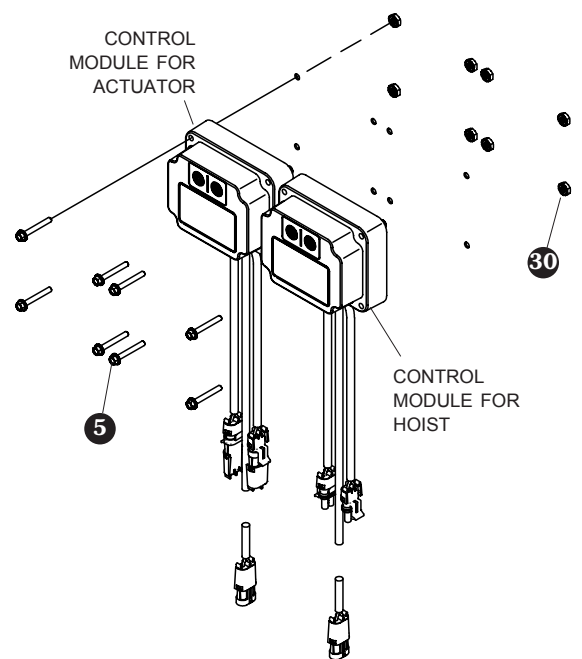

**STEP 7:** Connect white power wire from battery to circuit breaker with ring terminals, trimming wire length if needed. Connect output-splitter wire to control modules.

**STEP 8:** Connect wires from control module to actuator. Fasten upper actuator bracket to actuator with screw 6, washers 7 and nut 8. Fasten lower actuator bracket to actuator with wire lock pin. Fully extend actuator.

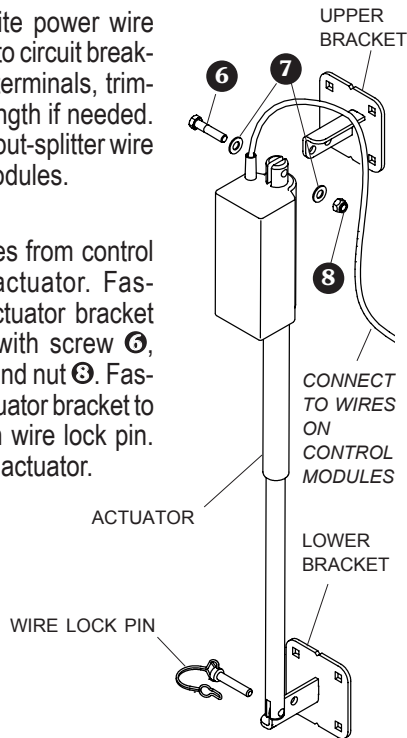

**STEP 9:** Align V-notches in brackets along center line of box, adjusting actuator up and down until lower bracket is centered vertically on slide gate as close as possible. Holding lower bracket in place, use holes in upper bracket as guide to mark hole locations on box. Drill 3/8" holes and fasten upper bracket to box with screws 11, washers 12 and nuts 13.

**NOTE:** First, center lower bracket on door. Hold bracket in place to determine mounting location for upper bracket. Mount upper bracket first, then actuator will determine mounting location for lower bracket.

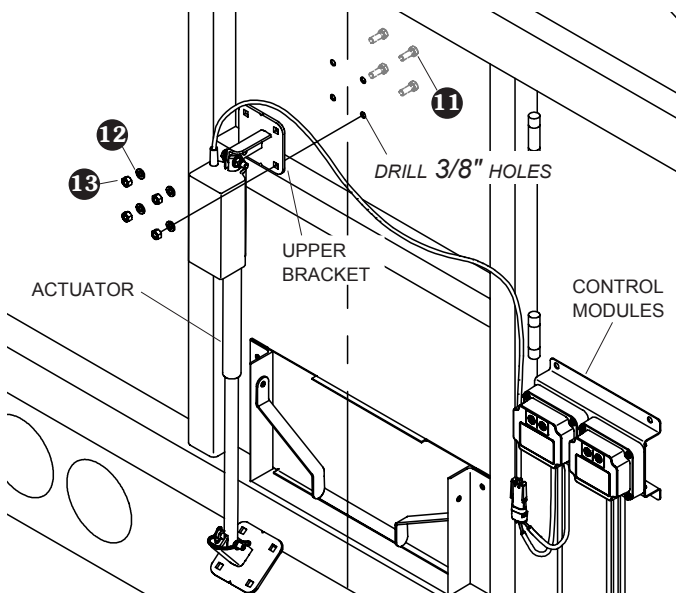

**CAUTION**

Locking device on slide gate must be disabled before attempting to open gate. Damage will occur if actuator attempts to open gate while gate is locked.

**STEP 10: OPTION 1:** Using lower actuator bracket as guide, mark and drill holes. See caution before fastening lower bracket to slide gate. Fasten with screws 11, washers 12 and nuts 13.

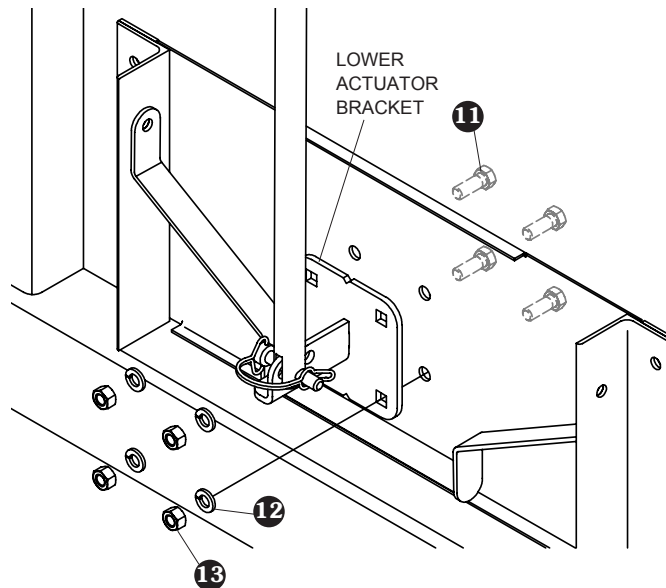

**STEP 10: OPTION 2:** Weld bracket to slide gate. See caution note above before welding lower bracket to slide gate.

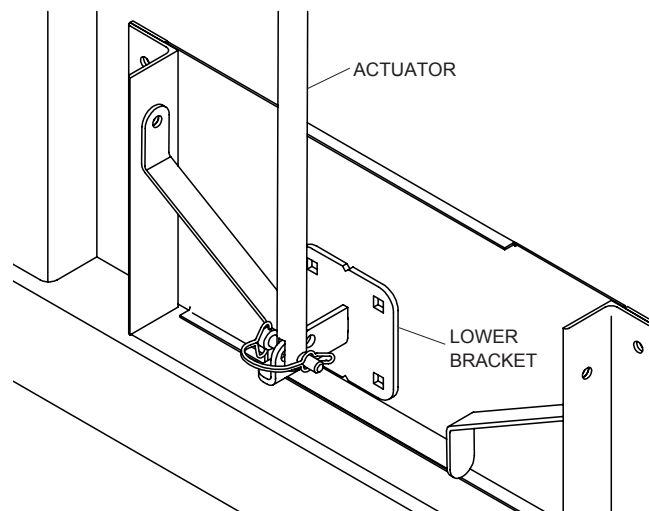

**STEP 12:** Disable locking device on slide gate.

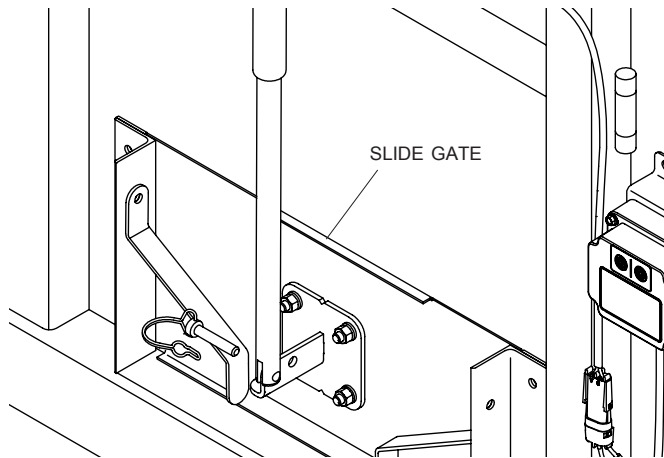

**STEP 13:** Place Warning decal on trailer/box in area visible to operators.

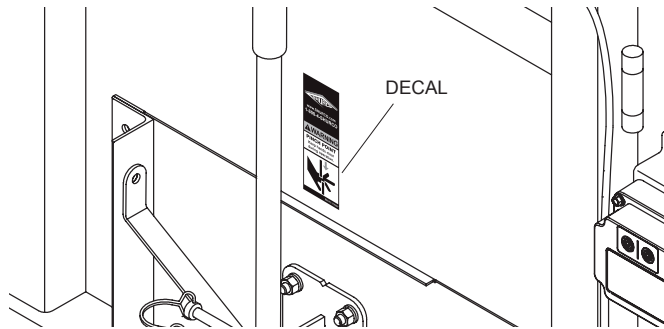

**NOTE:** Actuator must be fully extended to function correctly.

**STEP 14:** Connect control module for slide gate to actuator.

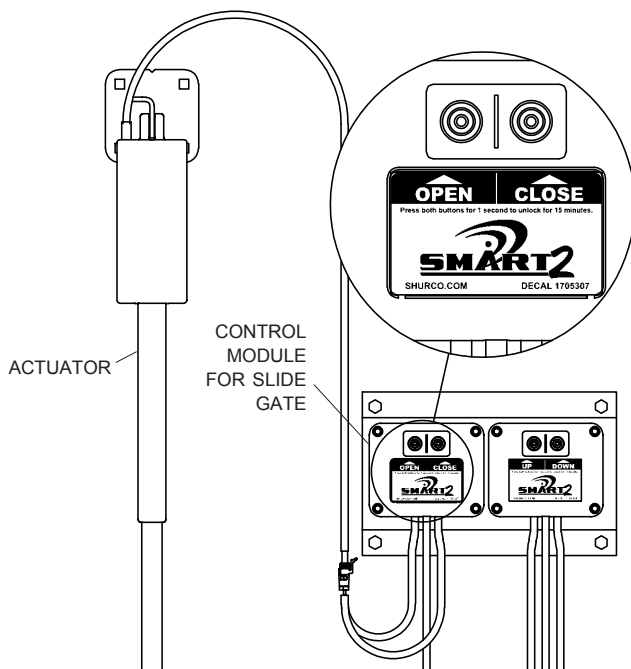

**STEP 15:** Test actuator function by pressing OPEN/CLOSE button on control module.

**STEP 16:** Mount air solenoids to frame with screws **14**, washers **15** and nuts **16**.

**NOTE:** If using manually controlled air switch, refer to instructions P/N 1125038.

**STEP 17:** Plumb air lines and fittings as shown below.

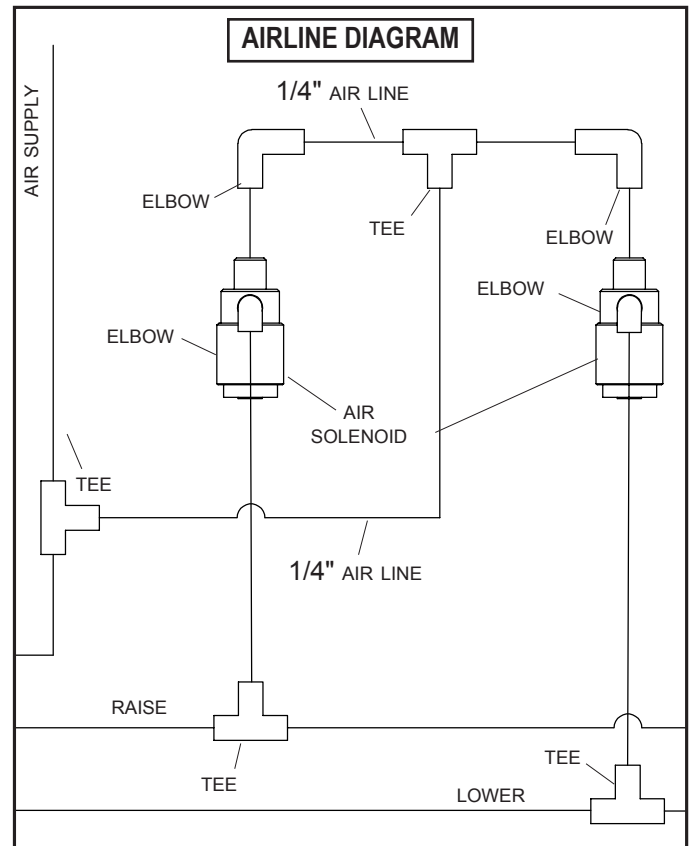

**STEP 18:** Connect air solenoid control wires to control modules.

**STEP 19:** Start truck engine and test hoist system by pressing UP/DOWN button on control module.

**STEP 20:** Secure power and solenoid wires to trailer with cable ties.

**NOTE:** If air solenoids operate backwards, switch wires at plugs on control module.

**NOTE:** To open and close gate manually, first remove lock pin and disconnect gate hoist.

Item	Part #	Description
1.	1124588	Actuator Mounting Bracket
2.	1126890	Control Box - SMART3™ Mini Module - Actuator
	1124669	Control Box - SMART2™ Mini-Module - Actuator
	1125070	Control Box - SMART1+™ Mini-Module - Actuator
3.	1126894	SMART3™ Control Module - Momentary - Up/Down
	1122546	SMART2™ Control Module - Momentary - Up/Down
	1124228	SMART1+™ Control Module - Momentary - Up/Down
4.	1124231	Receiver Bracket - Mini-Module - Farm
5.	1705412	Flanged Cap Screw - #10 x 1 1/2"
6.	1700369	Cap Screw - 3/8" x 1 3/4"
7.	1701176	Flat Washer - 3/8"
8.	1701580	Nylon Lock Nut - 3/8"
9.	1124866	Gate Actuator - 12 Stroke (Black)
	1128354	Gate Actuator - 300MM Stroke (Gray)
10.	1704427	Wire Lock Pin
11.	1705475	Elevator Bolt - 3/8" x 1"
12.	1700434	Lock Washer - 3/8"
13.	1700407	Hex Nut - 3/8"
14.	1704343	Cap Screw - 1/4" x 1 1/2"
15.	1700436	Lock Washer - 1/4"
16.	1700408	Hex Nut - 1/4"
17.	1124454	Cable Assembly
18.	1124455	Cable Assembly Control
19.	1122231	SMART2™ Remote w/Cradle
20.	1704958	SMART2™ Charging Cable
21.	1124305	SMART2™ Remote Cradle
22.	1122705	Output Splitter - LiteALL™
23.	1124613	Power Wire w/Circuit Breaker
24.	1703231	Cable Tie
25.	1702108	Wire Clip
26.	1124867	Solenoid Valve - 3 Way
27.	1705466	Air Brake Tubing
28.	1705515	Air Fitting - 1/4" Elbow
29.	1705516	Air Fitting - 1/4" Union Tee
30.	1702653	Machine Screw Nut w/Washer - #10
31.	1122704	Cable Extension - 20'
32.	1700381	Cap Screw - 1/4" x 1"
33.	1704173	Ring Terminal - 10 to 12 Ga. x #10 Stud
34.	1705491	Ring Terminal - 10 to 12 Ga. x 3/8" Stud
35.	1704338	Self-Drilling Screw - 1/4" x 3/4"
36.	1705513	Circuit Breaker - 6 Amp - Short Stop-Reset
37.	1126867	SMART3™ Remote
	1123160	SMART1+™ Remote
38.	1125081	Receiver Bracket - Mini Module - Farm
39.	1705507	Pinch Point Warning Decal

ITEM 4 IS OPTIONAL -  
USE W/ITEMS 32, 15 & 16

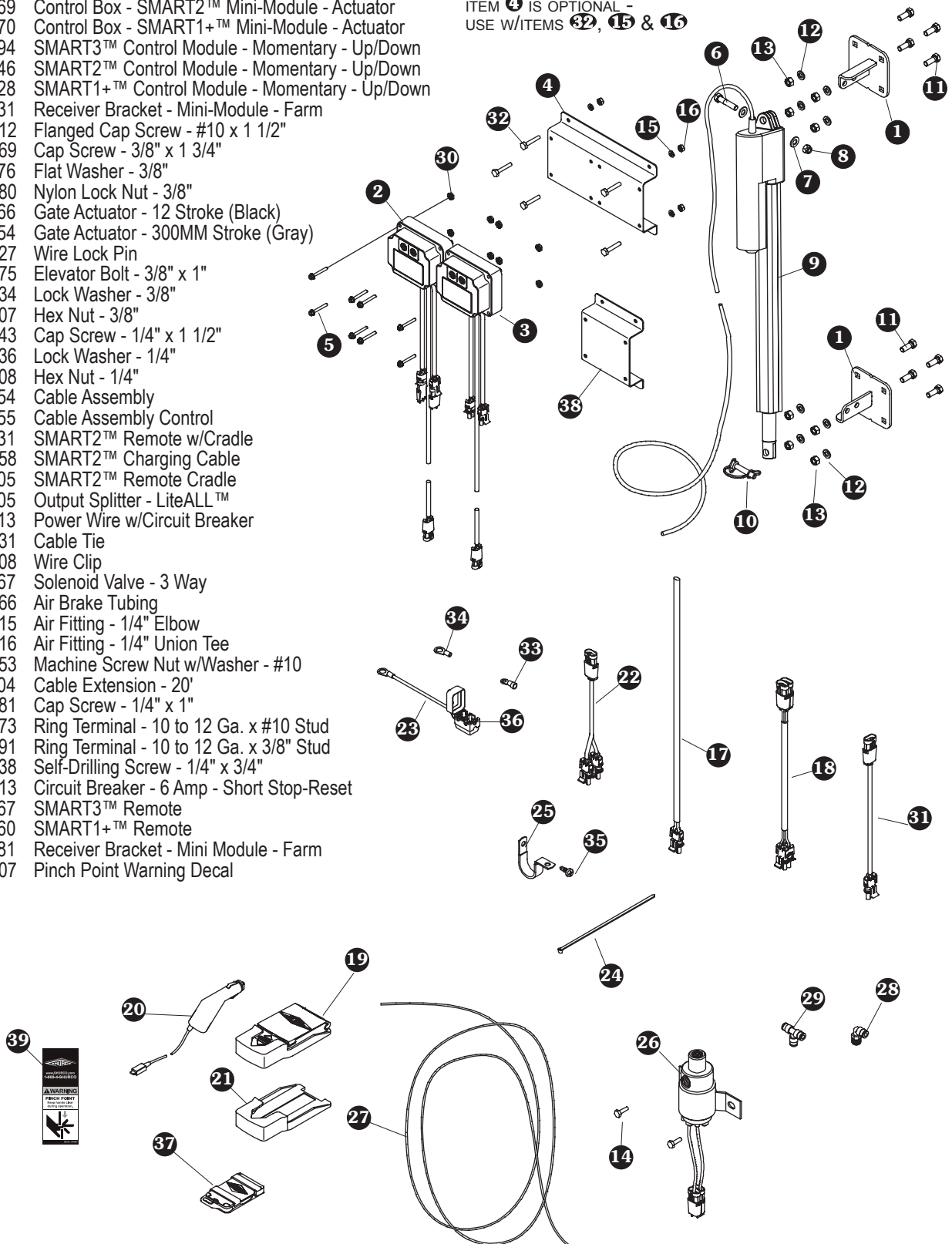





# MORE QUALITY PRODUCTS FROM SHUR-CO®

---

- **Genuine Replacement Tarps**
- **Genuine Replacement Parts**
  
- **Agriculture Products**
  - *The Original Shur-Lok®*
  - **Turning Point™ Bow**
  - **Shur-Lok® Junior**
  - **Premium Belt 'n Ratchet**
  - **Cable-Lok™**
  - **Tater-Top™**
  
- **SMARTrailer™ Accessories for Agriculture Products**
  - **SMART2™ Remote**
  - **SMART3™ Remote**
  - **4500 Series HD Electric**
  - **Electric Shur-Lok®**
  - **AutoTrap™ Hopper Opener**
  - **ProTrap® Hopper Opener**
  - **Electric Gate & Hoist**
  - **DriveMaxx™ Auger Drive**
  - **Electric Farm Swing Gate**
  - **LiteALL™ Work Lights**
  - **Cable-Lok™ Electric Upgrade**
  - **Electric Turning Point™ Bow**
  - **Solar Power Pack**
  
- **Construction Products**
  - *The Original Shur-Lok®*
  - **Turning Point™ Bow**
  - **Shur-Trak II™**
  - **IronSide II™**
  - **Shur-Matic™**
  
- **SMARTrailer™ Accessories for Construction Products**
  - **4500 Series HD Electric w/Gate Flex™**
  - **Shur-Trak II™ Electric Upgrade**
  - **Electric Turning Point™ Bow**
  - **Solar Power Pack**
  
- **Custom Products**
  - **Fitted Truck Covers**
  - **Flat Utility Tarps**
  - **Bean Drill Covers**
  - **Gustbuster™ Tarp Cords**
  - **SMARTwire™**

TARPING SYSTEMS & ACCESSORIES

