



TARP SYSTEMS, PARTS & TARPS

P/N 1808554 Rev. D

# OWNER'S MANUAL

## Quick-Flip II™ - Electric

*READ BEFORE INSTALLING*

3353 SE GRAN PARK WAY ■ STUART, FL 34997  
PHONE 1-800-327-8287 ■ FAX 772-287-0431  
[www.donovan-tarps.com](http://www.donovan-tarps.com)

**SHIPPING.** Orders are shipped F.O.B. from the Shur-Co®, LLC sites listed below. No full freight is allowed or prepaid shipment accepted unless quoted and approved in writing prior to acceptance of the order. All shipments are made by the most reasonable means in accordance with size and weight of order, unless specified routing instructions are furnished by the customer. Shipments are made daily via U.P.S. and common carrier. Claims for shortages must be made within 10 days. All claims for damages or loss in transit must be made with the carrier. No collect calls will be accepted. To ensure delivery of orders, we need your full street address and phone number. When you receive your shipment, examine it carefully. Be sure all cartons listed on the delivery sheet are accounted for. Large items may be packaged separately. If a carton is damaged, open it and inspect the contents before signing for delivery. If merchandise is damaged, describe damage on the delivery receipt. Failure on your part to document damaged or missing merchandise on the delivery receipt releases the carrier of all liability; repair or replacement will be the customer's responsibility.

**WARRANTY.** We warrant all new products are free of defects in materials and workmanship.\* This warranty is effective if products are properly installed and used for the purpose for which they were intended and applies to the original buyer only. Except as set forth above or in any product-specific warranty documentation, we make no other warranties, express or implied, including but not limited to warranties of merchantability of fitness for a particular use.

Returns of a product for warranty must be accompanied by a Return Merchandise Authorization number (RMA#), obtained by calling Customer Service at 866-748-7435, and sent, with freight paid by us, to Shur-Co®, LLC, 2309 Shur-Lok St., PO Box 713, Yankton, SD 57078. All products returned without an RMA# will be refused. When we issue the RMA#, we will also issue a call tag to have UPS (or other freight company) pick up the product. C.O.D. returns not accepted. We will pay no storage fees for a warranty product return prior to pick by us or the freight company. If a warranty product return is scheduled to be picked up by us, we will pick up the product at our earliest convenience.

If a product returned is found, in our judgement, to be defective in material or workmanship, our obligation under this warranty is limited to the repair or replacement of the product, which will be made by us. Repair or replacement will be at our discretion, with replacements being made using current products performing in the equivalent function. Labor charges, other than those incurred at our factory, including, but not limited to, any labor to install a repaired or replacement product, are not covered under this warranty. All expenses associated with delivering defective products to our factory and delivering repaired or replacement products from our factory to the owner will be paid by us.

If the product returned is found, in our judgement, to be non-warrantable, the owner will be contacted to authorize repair work, purchase of a replacement product or return of the product, all of which will be at the owner's expense. Payment authorization must be received by us before any non-warrantable product is repaired, replaced or returned. All expenses associated with delivering the repaired non-warrantable product, a replacement product or the non-warrantable product from our factory to the owner will be paid by the owner.

In no event will we be liable for any damages of any kind to person, product or property, including but not limited to indirect, incidental, special, consequential or punitive damages, or damages for loss of profits or revenue, even if we have been advised of the possibility of such damages. There are no warranties for used products or products that have been repaired, altered, modified or subjected to misuse, negligence or accident. We will not repair or replace products that fail or malfunction due to ordinary wear and tear, except as expressly noted in a product-specific warranty. Use of non-Shur-Co®, LLC parts in conjunction with Shur-Co®, LLC products will void this product warranty.

\*Certain products have specific warranties that differ from this warranty, for example motors and electronics. Product-specific warranty documentation is available for these items. In the event of a conflict between this warranty and a product-specific warranty, the product-specific warranty will govern.

**RETURN POLICY.** All sales final. See WARRANTY above for return details.

**OTHER.** All prices, product listings, sizes, weights and manufacturing details are subject to change without notice. No person is authorized to modify the foregoing conditions of sale whatsoever.

**SHUR-CO®, LLC SERVICE AND DISTRIBUTION CENTERS**

*Corporate HQ and Outlet Store*

**SHUR-CO® of SOUTH DAKOTA**

2309 Shur-Lok St., PO Box 713  
Yankton, SD 57078-0713  
Ph 800.474.8756 | Fax 605.665.0501

*ShurTite™ Service Centers*

**SHUR-CO® of CANADA**

490 Elgin St., Unit #1  
Brantford, Ontario N3S 7P8  
Ph 800.265.0823 | Fax 519.751.3997

**SHUR-CO® of SIOUX FALLS**

47184 258th St., Suite B  
Sioux Falls, SD 57107  
Ph 844.573.9322 | Fax 605.543.5469

**SHUR-CO® of ILLINOIS**

Ph 866.356.0246 | Fax 217.877.8270

**SHUR-CO® of OHIO**

Ph 866.356.0242 | Fax 330.297.5599

**SHUR-CO® of COLORADO**

10220 Brighton Rd., Unit #1  
Henderson, CO 80640  
Ph 866.355.9173 | Fax 303.289.2298

**SHUR-CO® of FLORIDA**

3353 SE Gran Park Way  
Stuart, FL 34997  
Ph 800.327.8287 | Fax 772.287.0431

**SHUR-CO® of ILLINOIS**

3993 E. Mueller Ave.  
Decatur, IL 62526  
Ph 866.356.0246 | Fax 217.877.8270

**SHUR-CO® of IOWA**

3839 Midway Blvd.  
Ft. Dodge, IA 50501  
Ph 866.356.0245 | Fax 515.576.5578

**SHUR-CO® of MICHIGAN**

5100 Lakeshore Dr.  
Lexington, MI 48450  
Ph 800.327.8287 | Fax 772.287.0431

**SHUR-CO® of NORTH DAKOTA**

1746 4th Ave. NW  
West Fargo, ND 58078  
Ph 877.868.4488 | Fax 701.277.1283

**SHUR-CO® of OHIO**

1100 N. Freedom, St. Rt. 88 & 14  
Ravenna, OH 44266  
Ph 866.356.0242 | Fax 330.297.5599

**SHUR-CO® of TEXAS**

34505 I-10 West, S. Frontage Rd.  
Brookshire, TX 77423  
Ph 866.689.0039 | Fax 281.934.3311

**SHUR-CO® UK, Ltd.**

Unit 41 Rochester Airport Estates  
Laker Rd., Rochester, Kent ME1 3QX  
Ph +44 (0)1795.473499  
Fax +44 (0)871.272.8278

*For more info, log on to our website:*

**www.shurco.com**

**MESSAGE TO OWNERS**

Thank you for buying this tarping system from Shur-Co®. We appreciate your confidence in our products. Please read and thoroughly understand this manual before installing and/or operating this system.

Pay particular attention to important safety and operating instructions, as well as warnings and cautions. The hazard symbol  is used to alert users to potentially hazardous conditions and is followed by caution, warning or danger messages.

Failure to READ AND FOLLOW INSTRUCTIONS could result in failure of your tarping system and/or personal injury. Your trailer requirements may, however, call for minor variations to these instructions.

Please inspect your tarping system periodically and repair or replace worn or damaged parts.

QUESTIONS? CALL OUR FL HELP LINE:

**1-800-327-8287**

MON-FRI 8 AM-5 PM EASTERN TIME

**SAFETY**

We at Shur-Co® are concerned with your safety and the safety of all those operating this system. Therefore, we have provided safety decals at various locations on your tarping system. Keep decals as clean as possible at all times. Replace any decal that has become worn or damaged, painted over or otherwise difficult to read. Replacement decals are available through Shur-Co® dealers.

**SAFETY INSTRUCTIONS**

- 1. Always wear safety glasses during installation and operation.**
- 2. Stay clear of moving parts.**
- 3. Do not operate under low-hung power lines. Always check for overhead obstructions before opening or closing.**
- 4. Open and close tarp only at job site.**
- 5. Place safety decals in visible locations. Replace worn or damaged decals.**
- 6. No other use of this system is authorized, except as designed.**

**RUST PREVENTION**

To prevent rust, paint all exposed metal, such as weld seams and/or metal exposed by grinding or cutting, with corrosion-resistant paint.

**TABLE OF CONTENTS**

Hardware Identification..... 1

Clearance Requirements..... 2

Base Assembly Installation..... 2

Housing Assembly Installation..... 3

Spring Box Installation..... 4

Pivot Arm Installation..... 5

Tarp Installation..... 6

Electric Hook-Up..... 7-10

Spring Box Cover Installation..... 11

Upper Arm Rest Installation..... 12

Replacement Parts..... 13-16

**TOOLS REQUIRED**

1. Wrenches - 1/2", 5/16", 9/16", 5/8", 3/4", 7/8"
2. Ratcheting Socket Wrench
3. Sockets - 1/2", 9/16", 3/4"
4. Allen Wrenches - 1/8", 5/32", 3/16"
5. Drill Bits (metal cutting) - 5/16", 3/8", 1/2", 3/16"
6. Center Punch
7. Hammer
8. Tape Measure
9. Flat Head or Phillips Screwdriver
10. Grinder
11. Air or Electric Impact Driver w/9/16" Socket
12. Metal Saw
13. Steel Welder
14. Hex Driver Bit - 5/16"
15. Phillips Driver Bit - #2

**MAINTENANCE**

- Spray all bearings and drive chain with penetrating oil as needed.
- Brush springs with steel brush weekly to remove dirt and spray with penetrating oil.
- Tighten any loose bolts.
- Replace damaged/bent parts.
- Replace worn or broken springs.
- Replace/repair worn or damaged tarps.

**HOUSING HARDWARE**

Item	Part #	Description	Qty.
A.	1801024	Cap Screw - 1/2" x 4"	1
B.	1800996	Flat Washer - 1/2"	6
C.	1800995	Lock Nut - 1/2"	5

**SPRING BOX HARDWARE**

Item	Part #	Description	Qty.
D.	1801629	Carriage Bolt - 5/8" x 2 1/2"	8
E.	1801555	Flat Washer - 5/8"	8
F.	1801554	Lock Nut - 5/8"	8

**PIVOT ARM HARDWARE**

Item	Part #	Description	Qty.
G.	1800561	Pan Hd. Cap Screw - 5/16" x 2 1/4"	20
H.	1800989	Flat Washer - 5/16"	20
J.	1800990	Lock Nut - 5/16"	20

**SPRING BOX COVER HARDWARE**

Item	Part #	Description	Qty.
K.	1801439	Pan Hd. Cap Screw - 5/16" x 3/4" - SS	4
L.	1800900	Flat Washer - 5/16" - SS	4

**PIVOT ARM REST HARDWARE**

Item	Part #	Description	Qty.
M.	1800998	Cap Screw - 5/16" x 1"	2
J.	1800990	Lock Nut - 5/16"	2
H.	1800989	Flat Washer - 5/16"	2

**ELECTRIC/HYDRAULIC HARDWARE**

Item	Part #	Description	Qty.
N.	1800790	Cap Screw - 3/8" x 1 1/2"	2
P.	1800991	Lock Washer - 3/8"	2

**ELECTRIC HARDWARE**

Item	Part #	Description	Qty.
Q.	1800783	Cap Screw - 1/4" x 1 1/2"	2
R.	1800442	Flat Washer - 1/4" SAE	6
S.	1800699	Lock Nut - 1/4"	2
T.	1800802	Sheet Metal Screw - #10 x 1"	4
U.	1800787	Lock Washer - 5/16"	4
V.	1800431	Hex Nut - 5/16"	4

**TARP INSPECTION**

**Tarp length:** Measure tarp length with slight tension applied. Compare actual tarp length with length stated on sheet attached to tarp. If actual tarp length does not match length on sheet, do not proceed. Call your local dealer or Shur-Co® FL Customer Service at 1-800-327-8287.

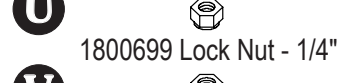
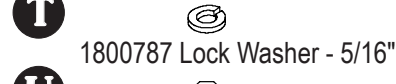
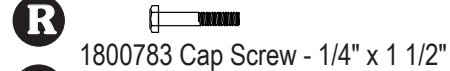
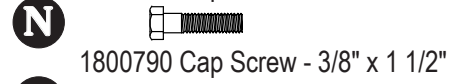
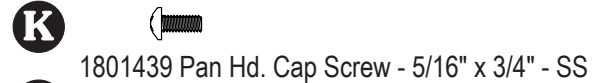
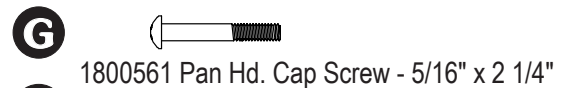
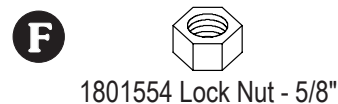
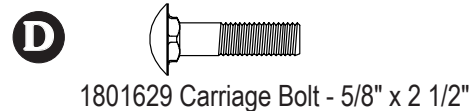
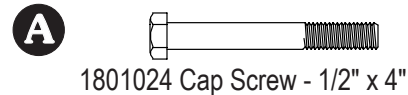

Item	Part #	Description
1.	1801622	Base Assembly
2.	1800726	Mounting Channel
3.	1801966	Mounting Angle

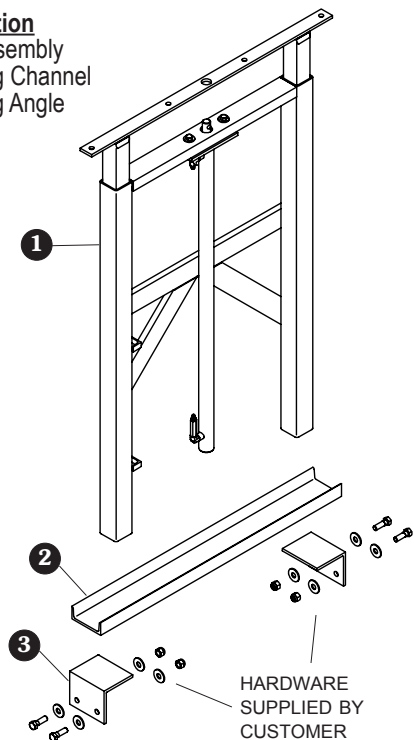

**CLEARANCE REQUIREMENTS**

There must be at least 6" clearance between components and tilt frame. If existing exhaust system or hydraulic system components are located between tilt frame and cab, adjust component locations as needed to achieve 6" of clearance.

If existing components interfere with base assembly installation, and if moving existing components is not practical, fabricate brackets as needed to prevent interference.

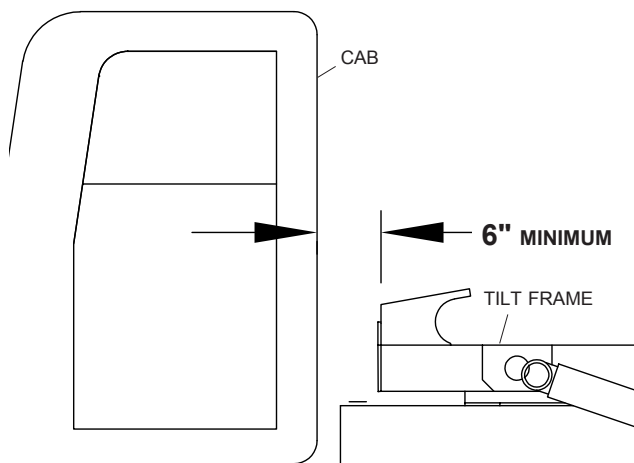

**CAUTION**  
To prevent damage to and ensure proper operation of Quick Flip II™ system, center base assembly between cab and hoist with at least 6" of clearance.

**BASE ASSEMBLY INSTALLATION**

**STEP 1:** Locate mounting angles on both sides of truck frame, centering brackets between cab and tilt frame. Align angles on frame, mark and drill 5/8" holes and fasten with 5/8" x 2" cap screws, flat washers and lock nuts (supplied by customer) or weld in place.

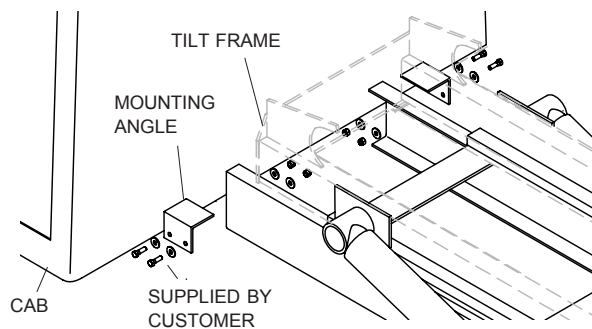

**CAUTION**  
Welding components to truck frame may weaken frame and will void warranty on truck. Weld angle brackets to existing brackets on frame when possible. When not possible, drill holes in frame and bolt brackets in place.

**STEP 2:** Align and center mounting channel on mounting angles and weld in place.

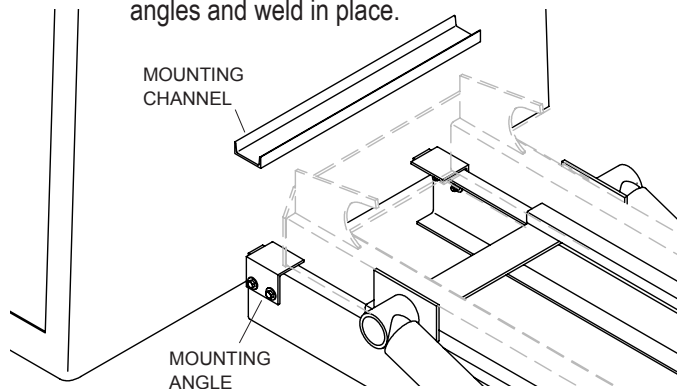

**STEP 3:** Square and center base assembly on mounting channel. Weld legs to mounting channel.

**NOTE:** If needed, fabricate additional bracing to stabilize base assembly and mounting channel.

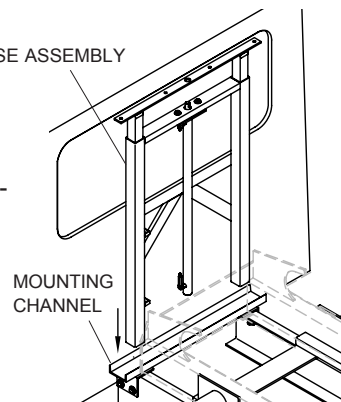

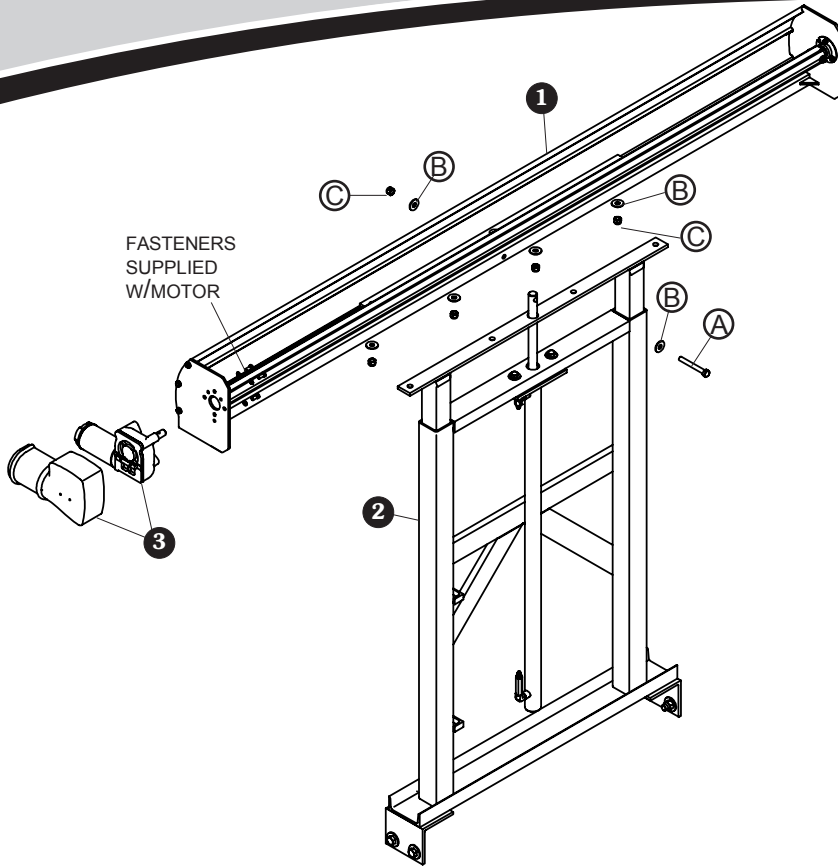

Item	Part #	Description
1.	1800492	Housing Assembly
2.	1801622	Base Assembly
3.	1704878	Durabuilt Motor w/Cover
A.	1801024	Cap Screw - 1/2" x 4"
B.	1800996	Flat Washer - 1/2"
C.	1800995	Lock Nut - 1/2"

**STEP 1:** Fasten motor to housing assembly with supplied fasteners as shown above.

**STEP 2:** Insert studs on housing assembly into holes in base assembly and fasten with washers **B** and nuts **C**.

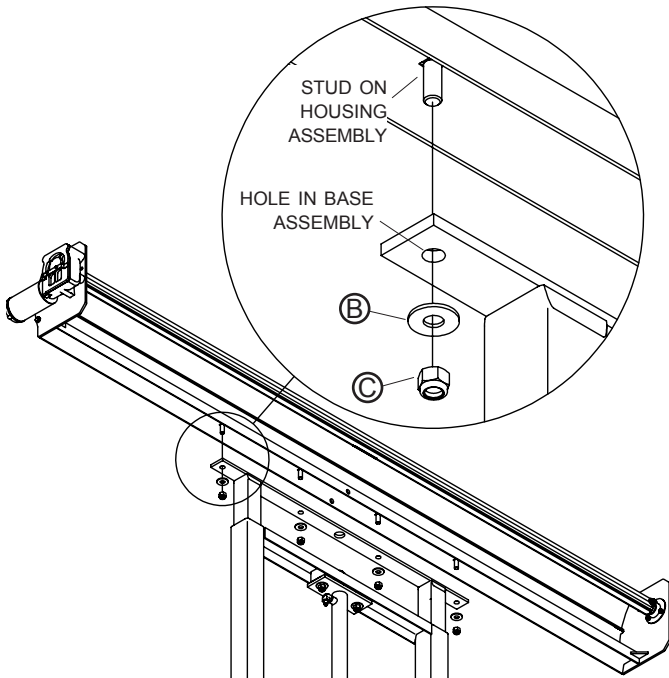

**STEP 3:** Fasten hydraulic cylinder rod on base assembly to housing assembly with screws **A**, washers **B** and nuts **C**.

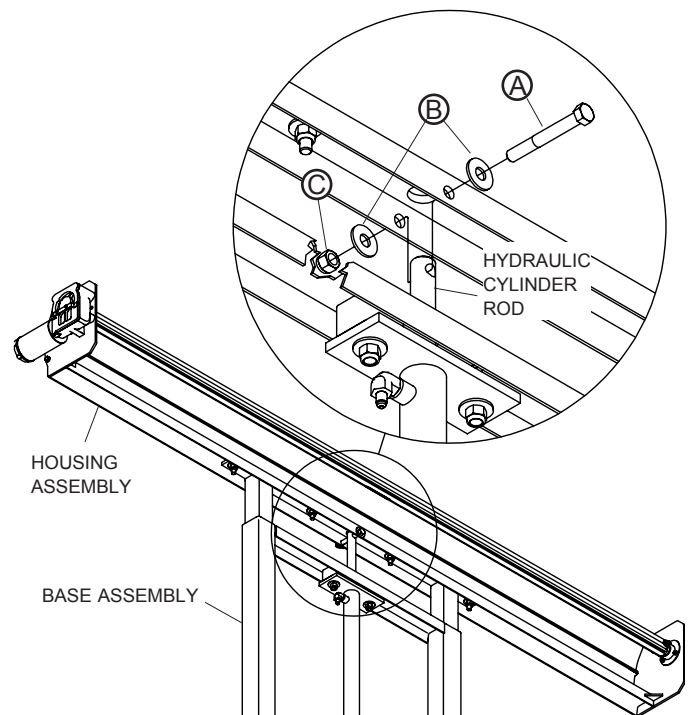

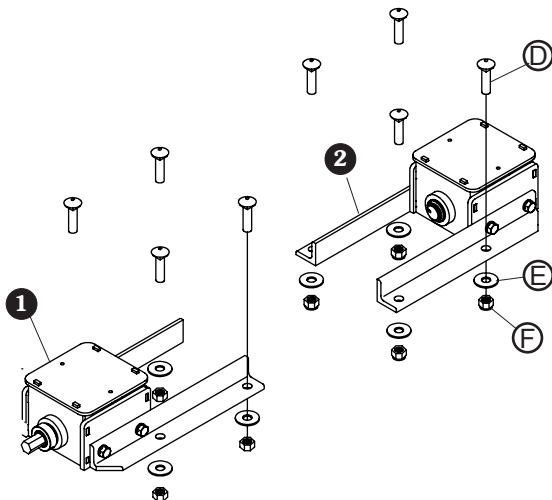

Item	Part #	Description
1.	1800555	Spring Box Assembly - Driver Side
2.	1800556	Spring Box Assembly - Passenger Side
D.	1801629	Carriage Bolt - 5/8" x 2 1/2"
E.	1801555	Flat Washer - 5/8"
F.	1801554	Lock Nut - 5/8"

**NOTE:** Fenders on most stock trucks are not strong enough to support spring boxes. To support weight and torsion of spring box, a support frame must be fabricated. In order for system to operate correctly, fenders must be square and level.

**IMPORTANT:** Locate spring box as low on truck frame as possible to allow clearance between roll-off container and spring box. Top of spring box must be less than 5" above rollers used to support container. If needed, pull container onto truck and check for clearance.

**STEP 1:** Locate spring boxes on truck fenders or on support frame, with 144" between base assembly and front of spring boxes.

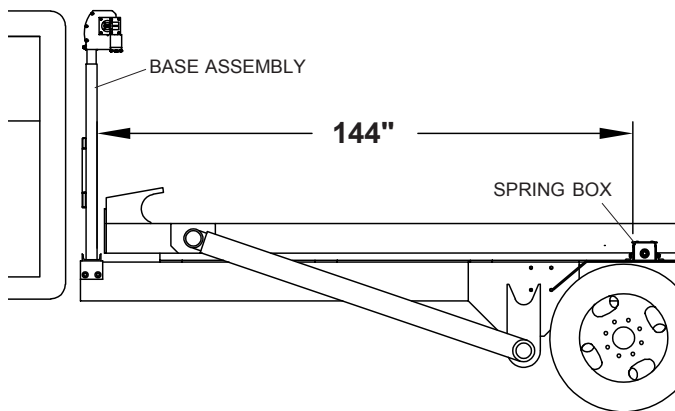

**NOTE:** Recommended distance needed for spring boxes to support arms for a 40-yard container is 144" from base assembly to spring box. To assure containers are covered and arms do not extend past rear of container, move container onto truck and center spring boxes between base assembly and back of container.

**STEP 2:** Space spring boxes 87" apart (see note below). System must be centered on truck, with an equal distance between truck rails to spring boxes.

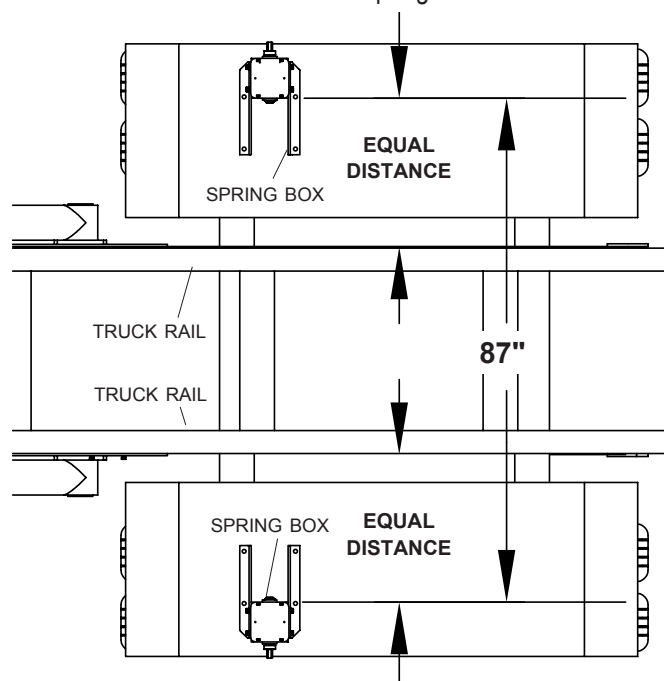

**NOTE:** Spring boxes may be welded in place if fenders are strong enough or customer-fabricated supports are used.

**STEP 3:** Fasten spring boxes and backing plates to fenders on truck with carriage bolts **D**, washers **E** and nuts **F**.

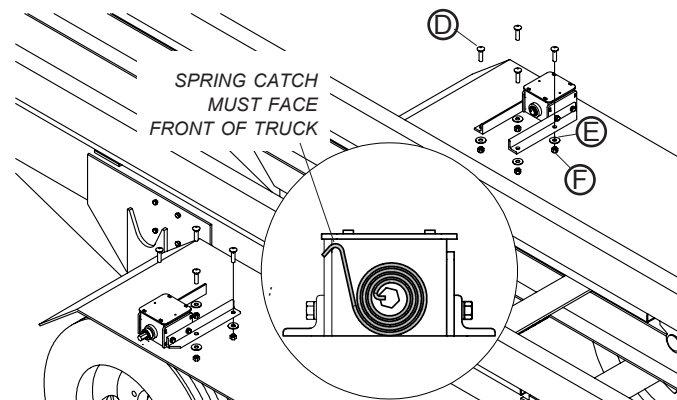

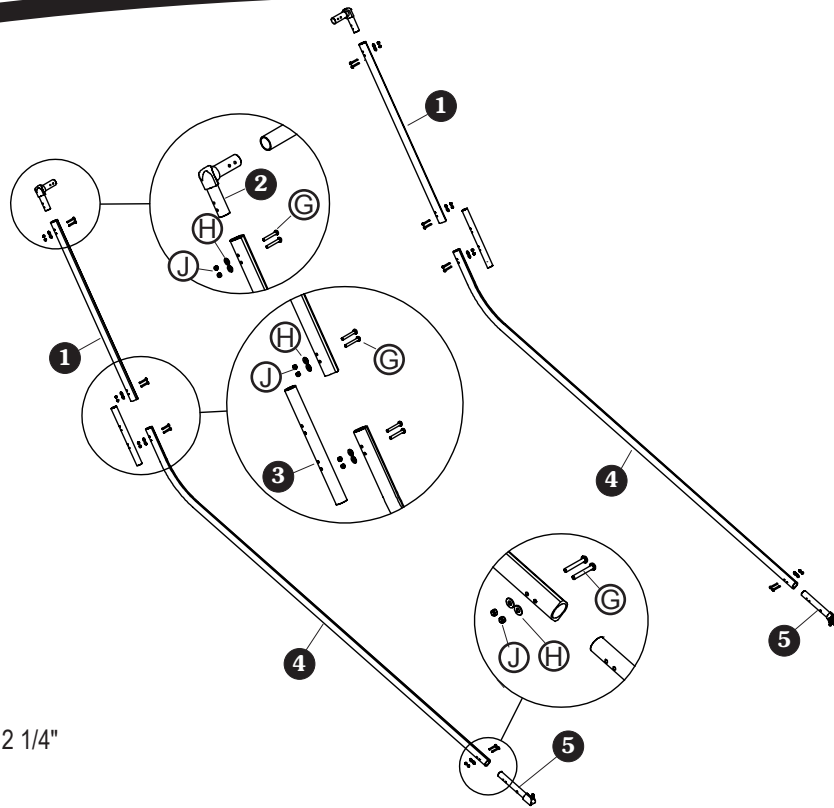

Item	Part #	Description
1.	1800548	Upper Arm
2.	1800597	90° Cast Elbow
3.	1800547	Arm Coupler
4.	1800545	Lower Arm
5.	1801636	Hex Pivot Arm Shaft
G.	1800561	Pan Hd. Cap Screw - 5/16" x 2 1/4"
H.	1800989	Flat Washer - 5/16"
J.	1800990	Lock Nut - 5/16"

**STEP 1:** Align pivot shaft on spring box as shown and fasten with supplied screws and nuts.

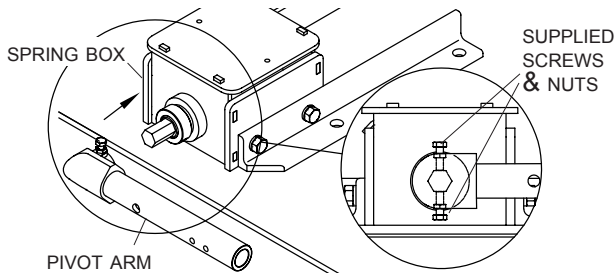

**STEP 2:** Slide lower arm onto pivot shaft on spring box assembly, positioning bend in arm as shown. Fasten lower arm to pivot shaft with screws G, washers H and nuts J.

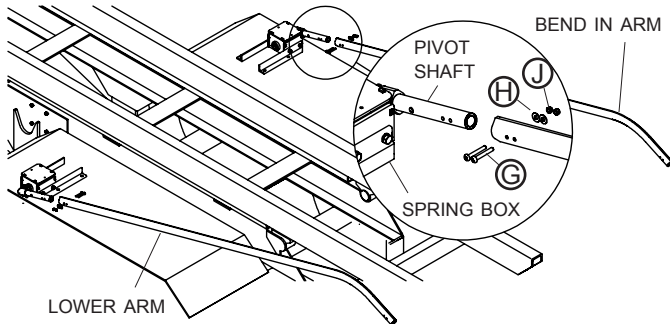

**NOTES:** If holes will not align well enough to insert bolts, run 5/16" drill bit through holes. Place bolt heads on inside of arms to prevent bolts from catching on container.

**STEP 3:** Slide arm coupler into lower arm and fasten with screws G, washers H and nuts J.

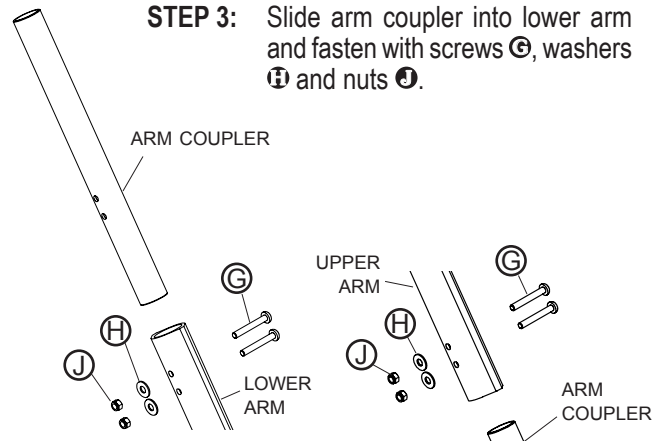

**STEP 4:** Slide upper arm onto arm coupler and fasten with screws G, washers H and nuts J.

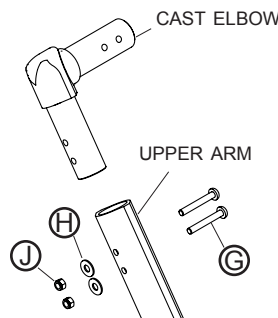

**STEP 5:** Insert cast elbow into upper arm and fasten with screws G, washers H and nuts J.



Item	Part #	Description
1.		Tarp
2.	1800546	Rear Crosspiece
G.	1800561	Pan Hd. Cap Screw - 5/16" x 2 1/4"
H.	1800989	Flat Washer - 5/16"
J.	1800990	Lock Nut - 5/16"

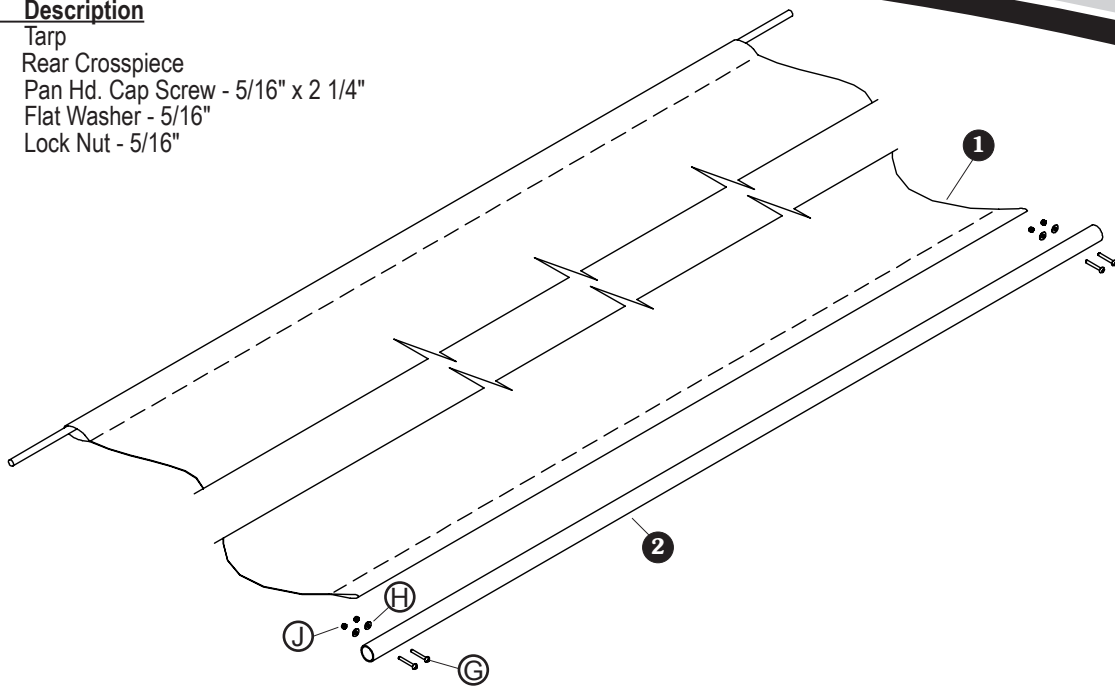

**STEP 1:** Thread front of tarp with plastic rod into slot in center of roller bar. Trim ends of rod to fit tarp.

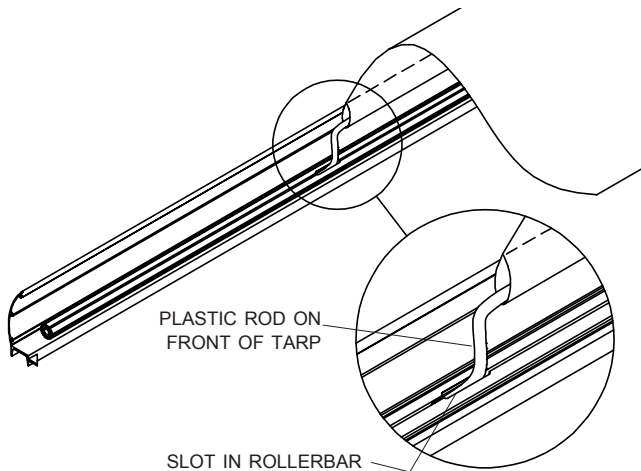

**STEP 2:** Slide rear crosspiece into tarp pocket at rear of tarp.

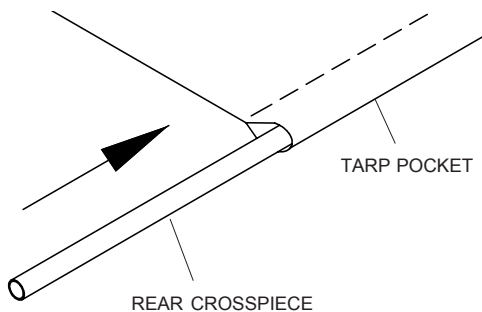

**STEP 3:** Center tarp on roller bar and rear crosspiece.

**STEP 4:** Insert rear crosspiece into 90° elbow. Using holes in 90° elbow as guide, mark and drill 5/16" holes. Fasten with screws G, washers H and nuts J.

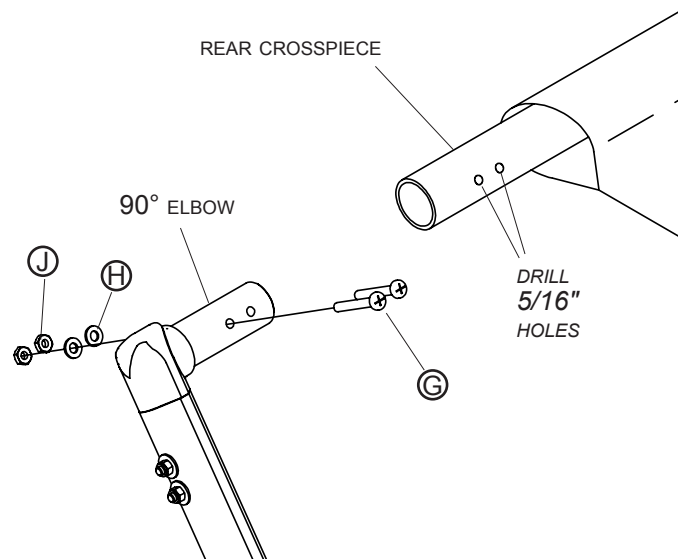

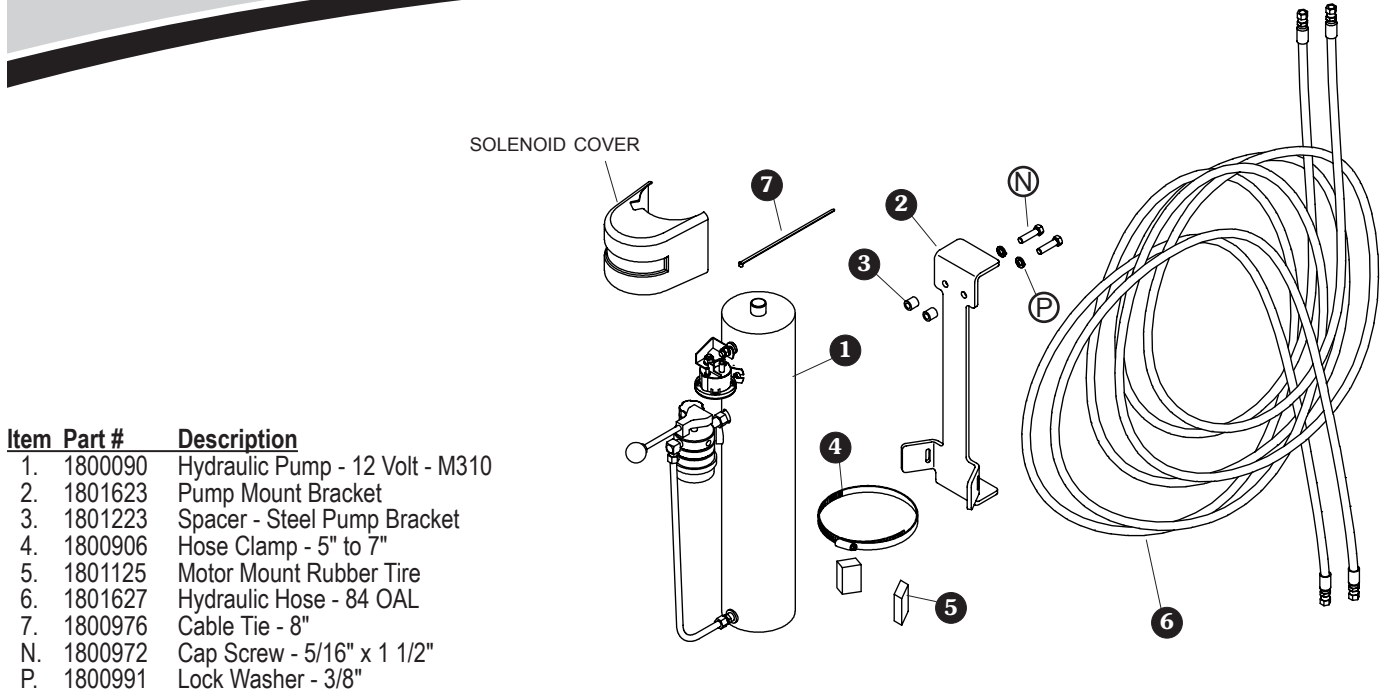

Item	Part #	Description
1.	1800090	Hydraulic Pump - 12 Volt - M310
2.	1801623	Pump Mount Bracket
3.	1801223	Spacer - Steel Pump Bracket
4.	1800906	Hose Clamp - 5" to 7"
5.	1801125	Motor Mount Rubber Tire
6.	1801627	Hydraulic Hose - 84 OAL
7.	1800976	Cable Tie - 8"
N.	1800972	Cap Screw - 5/16" x 1 1/2"
P.	1800991	Lock Washer - 3/8"

## HYDRAULIC PUMP

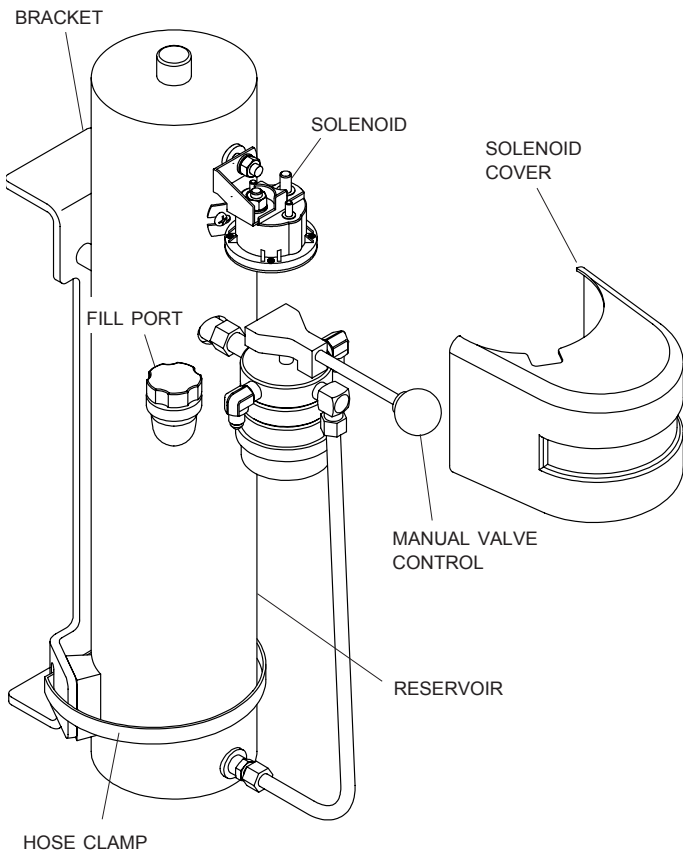

**STEP 1:** Locate pump mount bracket on outside of leg or other easily accessible location. Locate bracket so pump will be vertical, with control valve and motor on top and reservoir on bottom as shown.

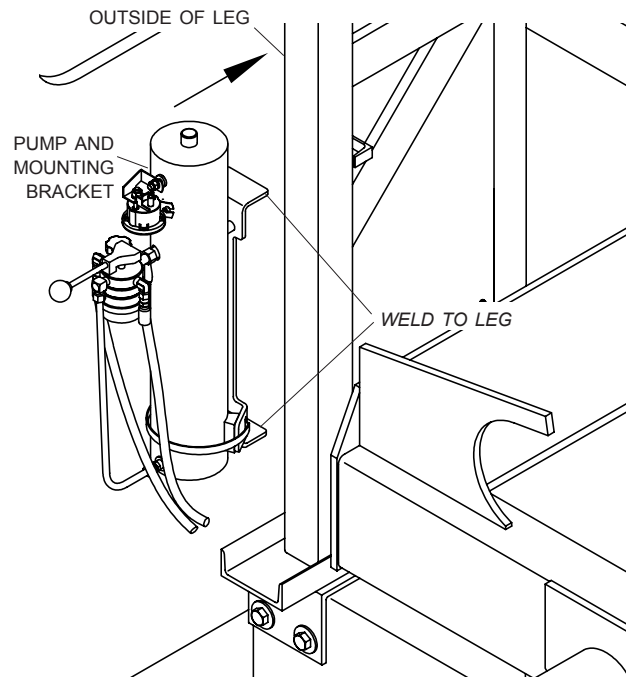

**STEP 2:** Mark bracket location on trailer. Unfasten and remove hydraulic pump from bracket. Weld bracket in place, then replace and refasten pump.

**STEP 3:** Connect hoses from hydraulic pump to hydraulic cylinder, making sure hose clamps are tight around reservoir.

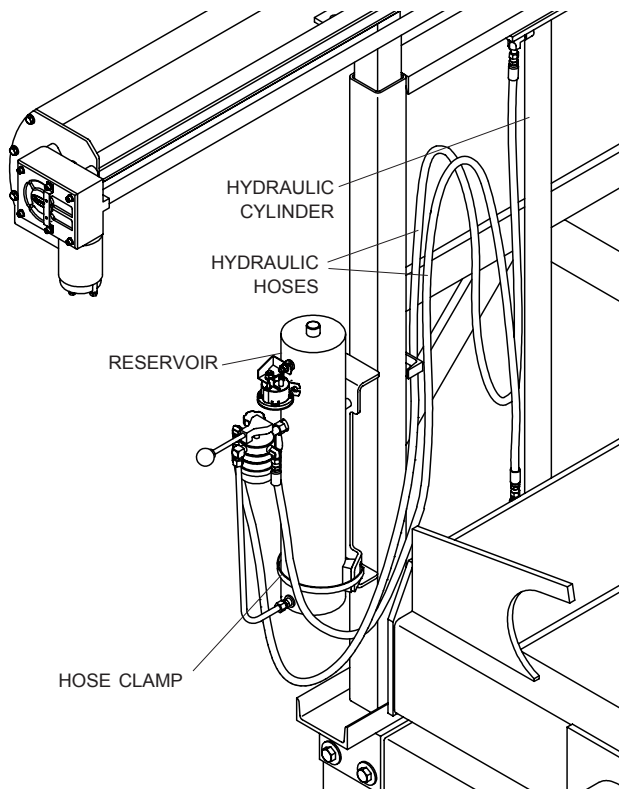

**STEP 4:** Remove shipping plug from fill port and fill pump with approximately 4 quarts Dexron automatic transmission fluid. Install breather cap onto fill port. Do not reinstall shipping plug.

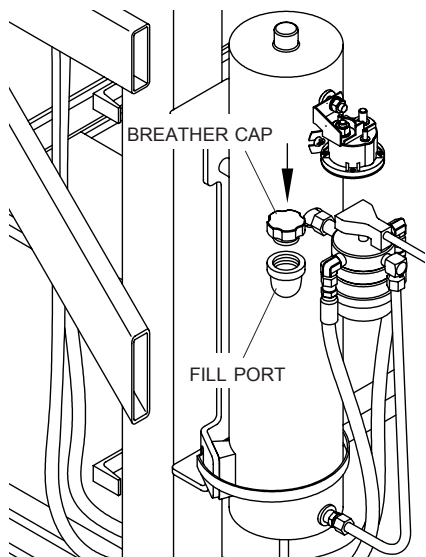

**CAUTION**  
 Replace shipping plug with breather cap on hydraulic pump or pump will be damaged.

**STEP 5:** Connect negative wire from battery to stud on hydraulic pump.

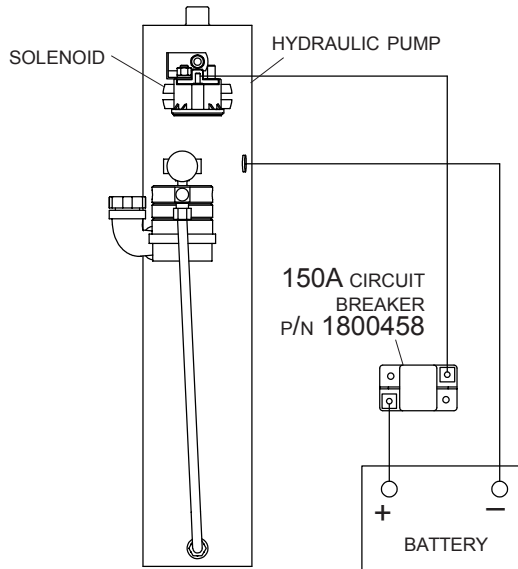

**STEP 6:** Connect positive wire from battery to circuit breaker and from circuit breaker to solenoid on pump.

**STEP 7:** Place solenoid cover over solenoid. Secure cover to pump with 8" cable tie.

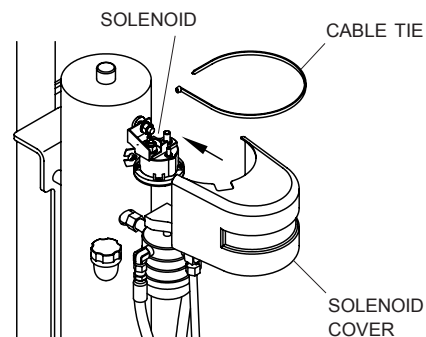

**NOTE:** To thread fitting body onto end of hose, turn body counterclockwise until body engages hose about 1". Thread fitting insert onto body, turning clockwise until insert is snug against body. Fitting must be threaded completely onto hoses to prevent leaking.

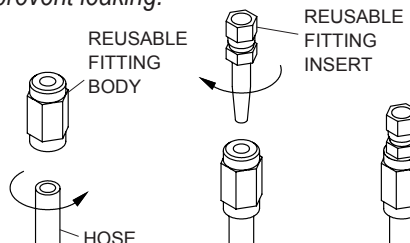

Item	Part #	Description
1.	1800418	Solenoid
2.	1800429	Solenoid Cover
3.	1807726	Toggle Switch
4.	1801265	Toggle Switch Plate
5.	1800302	Ring Terminal - 8 Ga. x 1/4"
6.	1800158	Ring Terminal - 8 Ga. x 3/8"
7.	1800417	Circuit Breaker - 60-Amp 12V
8.	1800441	Butt Connector - 18-22 Ga.
Q.	1800783	Cap Screw - 1/4" x 1 1/2"
R.	1800442	Flat Washer - 1/4" SAE
S.	1800699	Lock Nut - 1/4"
T.	1800802	Sheet Metal Screw - #10 x 1"
U.	1800787	Lock Washer - 5/16"
V.	1800431	Hex Nut - 5/16"

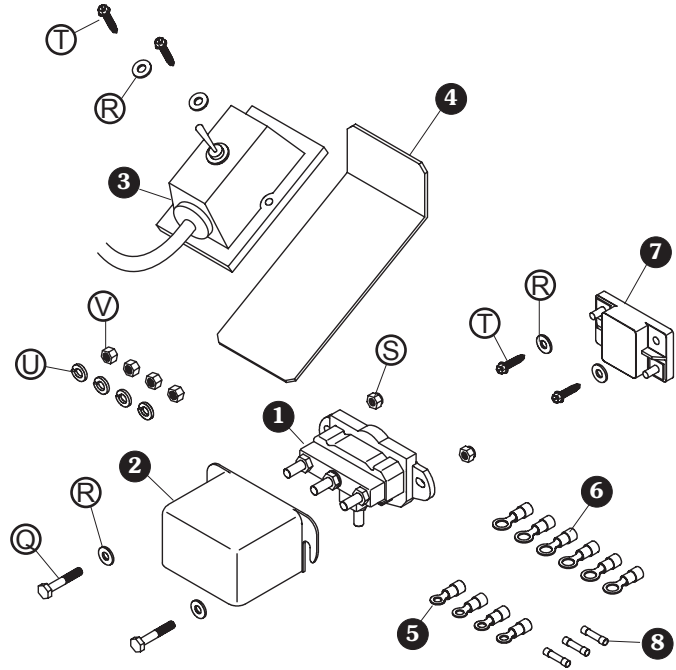

**NOTE:** New electric motor kits include dual-conductor wire. If not using new electric kit, use existing wire on truck.



### CAUTION

Do not spray electric components with pressure washer or hose.



### CAUTION

Do not pull dual-strand wires apart. To separate, cut through insulation between wires carefully with knife. Pulling wires apart could damage wire insulation and expose wire. This could result in equipment damage and/or personal injury.

**NOTE:** Cut wires to length and strip only enough wire insulation to install ring terminals. Insert bare wire into ring terminals and crimp securely.

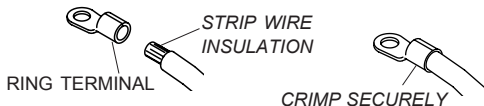

**STEP 1:** Locate solenoid in sheltered location such as battery box, cab or under cab. Using solenoid as guide, mark and drill 1/4" holes. Loosely fasten solenoid with screws Q, washers R and nuts S.

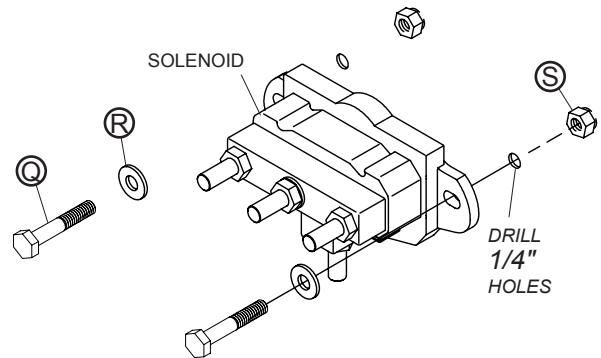

**STEP 2:** Locate circuit breaker near battery. Fasten with screws T and washers R.

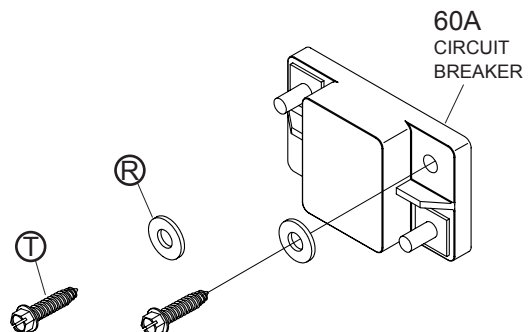

**WIRING DIAGRAM**

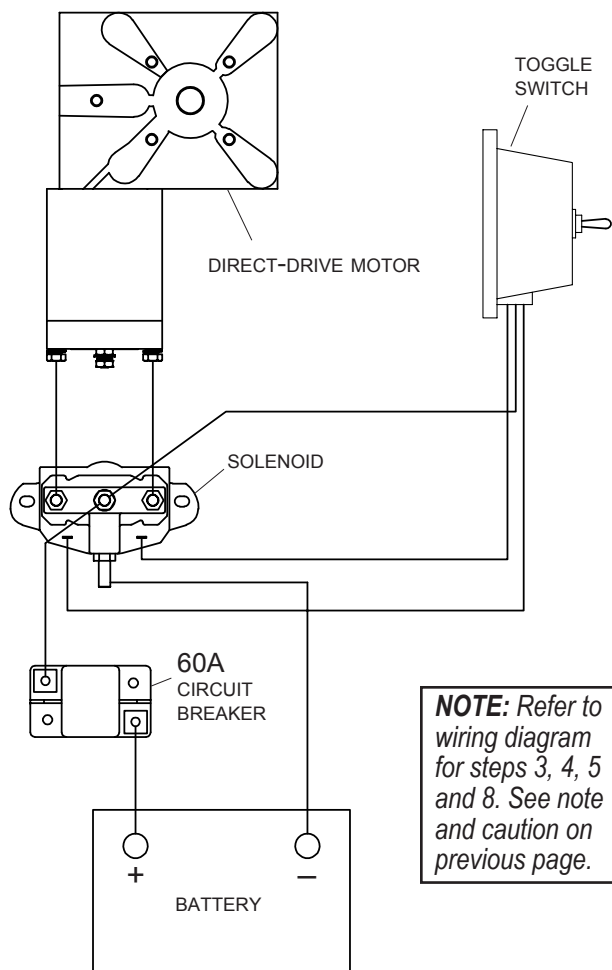

- STEP 3:** Cut section of dual-conductor wire to run from solenoid to electric motor. Crimp two 3/8" ring terminals ⑥ on one end of wire and two 1/4" ring terminals ⑤ on other end. Connect 1/4" ring terminals to motor and 3/8" ring terminals to solenoid.
- STEP 4:** Cut section of dual-conductor wire to run from solenoid to battery. Crimp two 3/8" ring terminals ⑥ on one end of wire and connect terminals to posts on solenoid marked Batt+ and Batt-. Crimp one 1/4" ring terminal ⑤ and one 3/8" ring terminal ⑥ on other end of wire. Connect 1/4" ring terminal to circuit breaker post marked AUX and connect 3/8" ring terminal to negative battery post.
- STEP 5:** Divide portion of dual-conductor wire into two single-strand wires (see caution). Cut section of single-strand wire to run from positive terminal on battery to circuit breaker. Crimp 3/8" ring terminal ⑥ onto one end of wire and 1/4" ring terminal ⑤ onto other end. Connect 3/8" ring terminal to positive battery post and connect 1/4" ring terminal to post on circuit breaker marked BAT.

**STEP 6:** Locate toggle switch where switch can easily be accessed by system operator. Weld toggle switch plate in place.

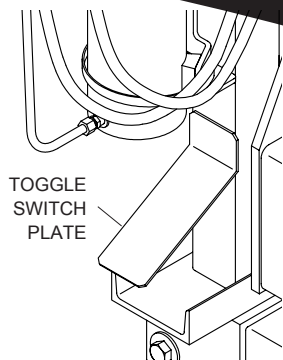

**STEP 7:** Fasten toggle switch to plate with screws ① and washers ②.

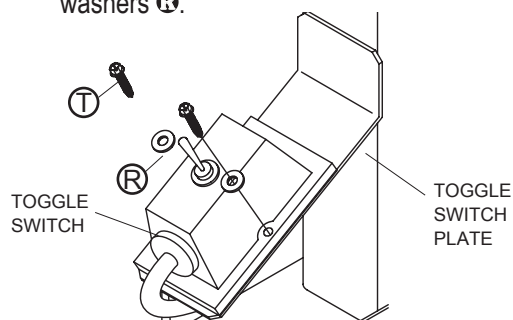

**STEP 8:** Run three-strand jacketed toggle switch wire to solenoid and cut to length. Connect wire ends to solenoid, placing ring terminal ⑤ on post marked BATT+ and two quick disconnects to tabs marked T1 and T2.

**NOTE:** Kit includes three extra butt connectors. If excess switch wire cannot be coiled, connectors are provided to shorten switch wires to desired length.

**STEP 9:** Slide solenoid cover under bolt heads and washers holding solenoid in place. Tighten fasteners to hold cover and solenoid in place.

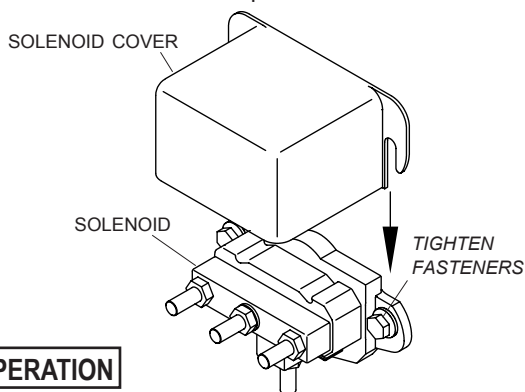

**TEST OPERATION**

**STEP 10:** Operate toggle switch to verify tarp is moving in same direction as shown on toggle. If tarp is not moving in same direction as toggle, either swap two wires connected to tabs T1 and T2 on solenoid or two wires connected to motor.

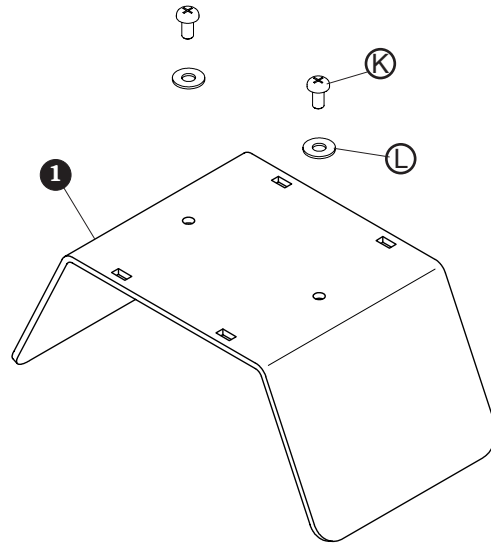

Item	Part #	Description
1.	1800560	Spring Box Cover
K.	1801439	Pan Hd. Cap Screw - 5/16" x 3/4" - SS
L.	1800900	Flat Washer - 5/16" - SS

**STEP 1:** Fasten spring box covers to spring boxes with screws **K** and washers **L**.

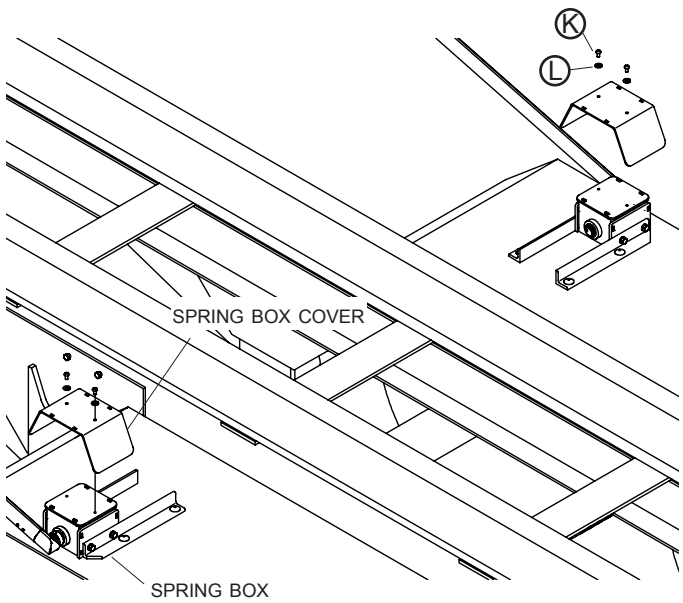

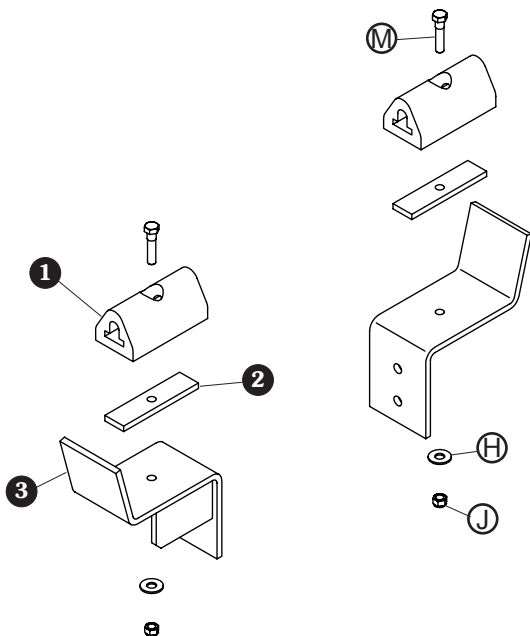

Item	Part #	Description
1.	1801012	Rubber Bumper
2.	1800140	Bumper Hold-Down Bar
3.	1801324	Pivot Arm Rest
M.	1800998	Cap Screw - 5/16" x 1"
H.	1800989	Flat Washer - 5/16"
J.	1800995	Lock Nut - 5/16"

**STEP 1:** Wind tarp open until arms are completely forward, stopping just before arms reach housing assembly.

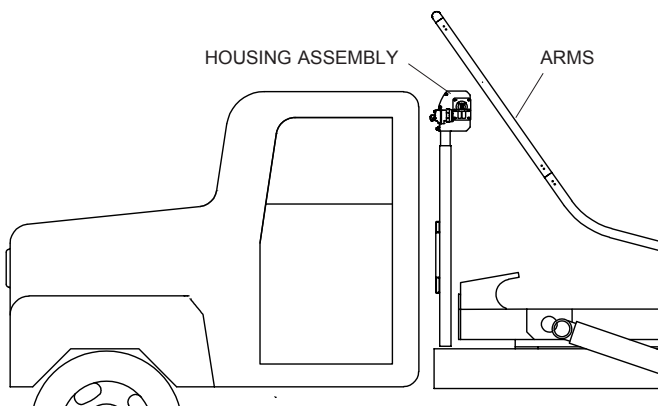

**STEP 2:** Position rubber bumpers on pivot arm rests. Align components on housing assembly brackets, adjusting so pivot arms rest evenly on rests and do not interfere with motor. Clamp pivot arm rests in place.

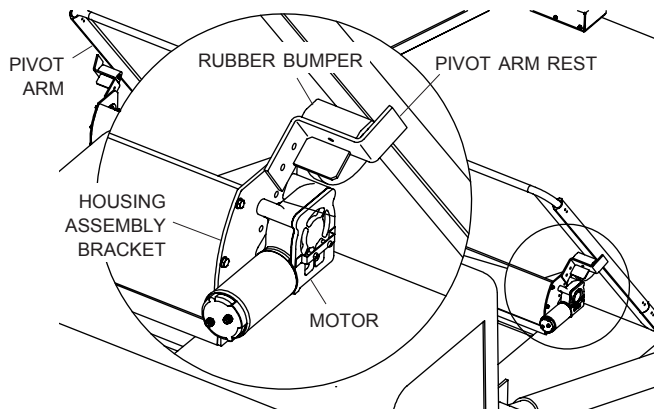

**STEP 3:** Remove rubber bumpers and weld or bolt pivot arm rests onto housing brackets (hardware not provided).

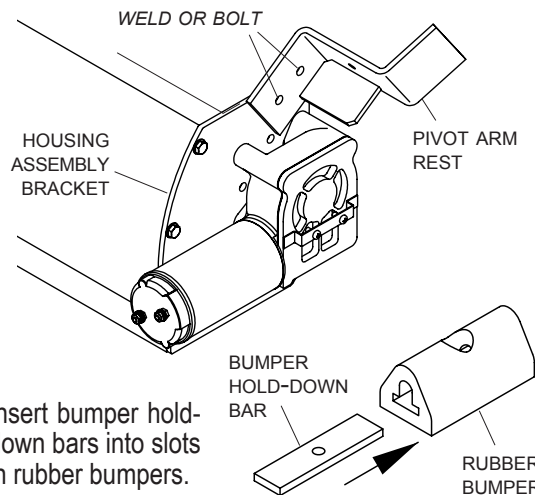

**STEP 4:** Insert bumper hold-down bars into slots in rubber bumpers.

**STEP 5:** Fasten bumper assemblies to pivot arm rests with screws (M), washers (H) and nuts (J).

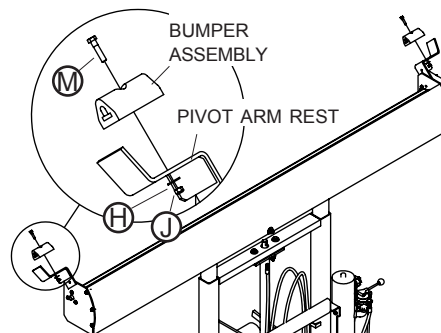

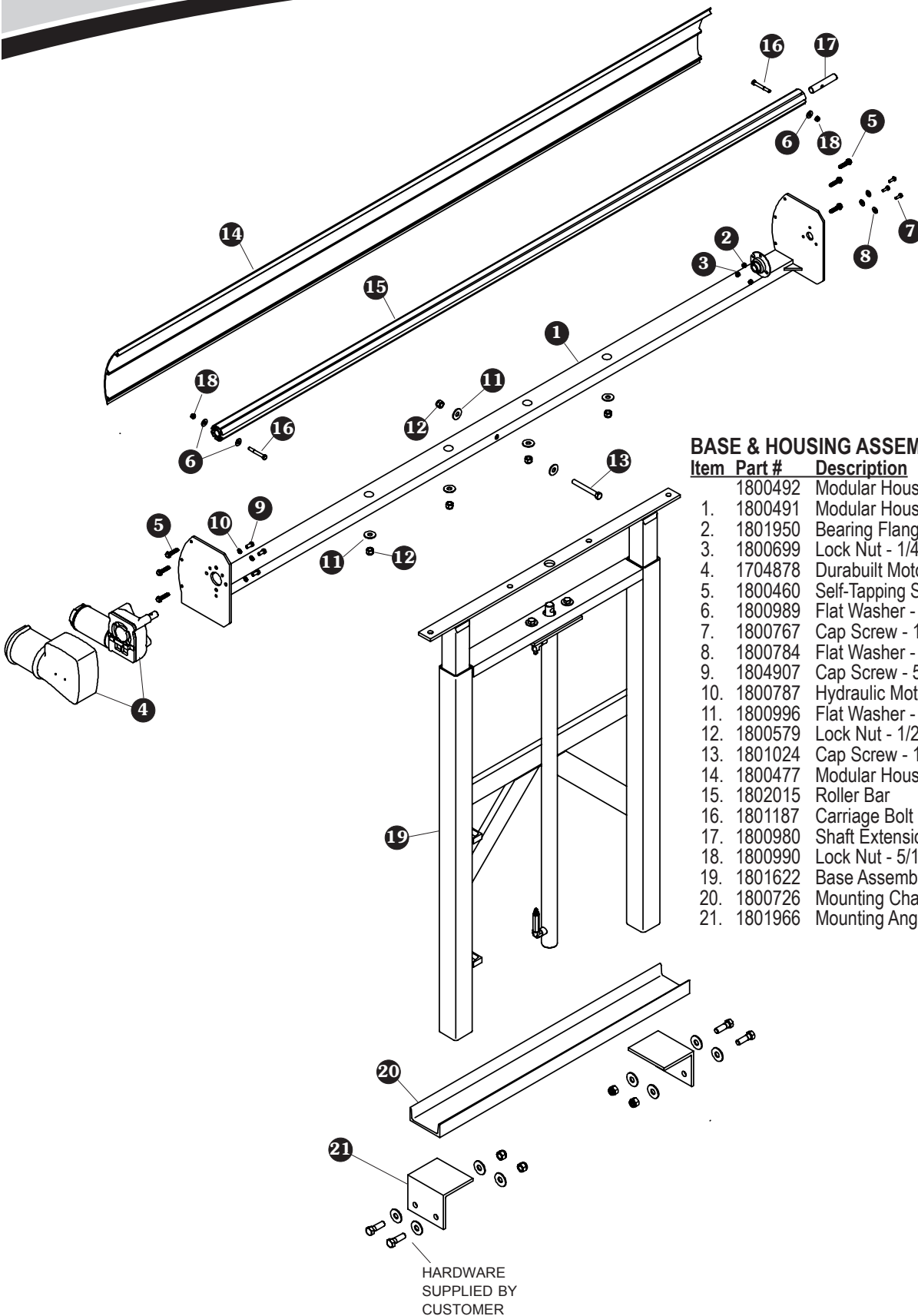

**BASE & HOUSING ASSEMBLIES**

Item	Part #	Description
	1800492	Modular Housing Assembly
1.	1800491	Modular Housing Weldment
2.	1801950	Bearing Flange - Reversed
3.	1800699	Lock Nut - 1/4"
4.	1704878	Durabuilt Motor w/Cover
5.	1800460	Self-Tapping Screw - 5/16" x 1 1/4"
6.	1800989	Flat Washer - 5/16"
7.	1800767	Cap Screw - 1/4" x 3/4"
8.	1800784	Flat Washer - 1/4"
9.	1804907	Cap Screw - 5/16" x 3/4"
10.	1800787	Hydraulic Motor Washers
11.	1800996	Flat Washer - 1/2"
12.	1800579	Lock Nut - 1/2"
13.	1801024	Cap Screw - 1/2" x 4"
14.	1800477	Modular Housing Deflector
15.	1802015	Roller Bar
16.	1801187	Carriage Bolt - 5/16" x 2 1/2"
17.	1800980	Shaft Extension - 3/4" x 4"
18.	1800990	Lock Nut - 5/16"
19.	1801622	Base Assembly
20.	1800726	Mounting Channel
21.	1801966	Mounting Angle

HARDWARE  
SUPPLIED BY  
CUSTOMER



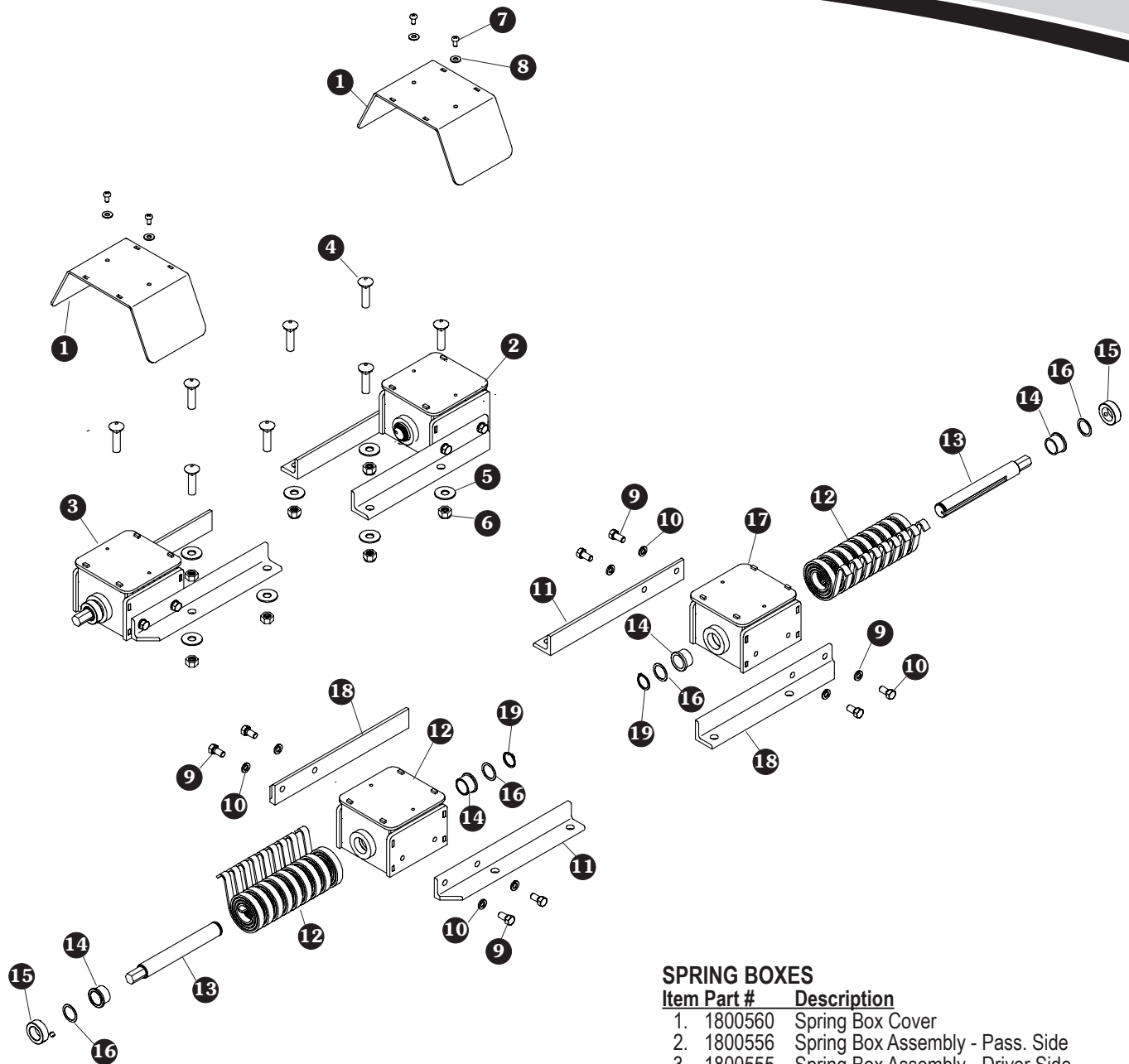

**SPRING BOXES**

Item	Part #	Description
1.	1800560	Spring Box Cover
2.	1800556	Spring Box Assembly - Pass. Side
3.	1800555	Spring Box Assembly - Driver Side
4.	1801629	Carriage Bolt - 5/8" x 2 1/2"
5.	1801555	Flat Washer - 5/8"
6.	1801554	Lock Nut - 5/8"
7.	1801439	Pan Hd. Cap Screw - 5/16" x 3/4" - SS
8.	1800900	Flat Washer - 5/16" - SS
9.	1801327	Cap Screw - 1/2" x 1"
10.	1800797	Lock Washer - 1/2"
11.	1800551	Mounting Angle #2 of 2
12.	1800763	Torsion Spring
13.	1808514	Spring Shaft - 1 1/4" OD - 7/8" Hex End
14.	1800860	Flanged Bushing - 1 1/4"
15.	1800861	Shaft Collar - 1 1/4"
16.	1800977	Shim - 1 1/4" x .047"
17.	1800542	Spring Box Weldment
18.	1800550	Mounting Angle #1 of 2
19.	1801474	Ring Retainer - 1/4" x .093"

**PIVOT ARM RESTS**

Item	Part #	Description
1.	1801012	Rubber Bumper - 4" - Drilled
2.	1800140	Bumper Hold-Down Bar
3.	1801324	Pivot Arm Rest
4.	1800998	Cap Screw - 5/16" x 1"
5.	1800989	Flat Washer - 5/16"
6.	1800995	Lock Nut - 5/16"

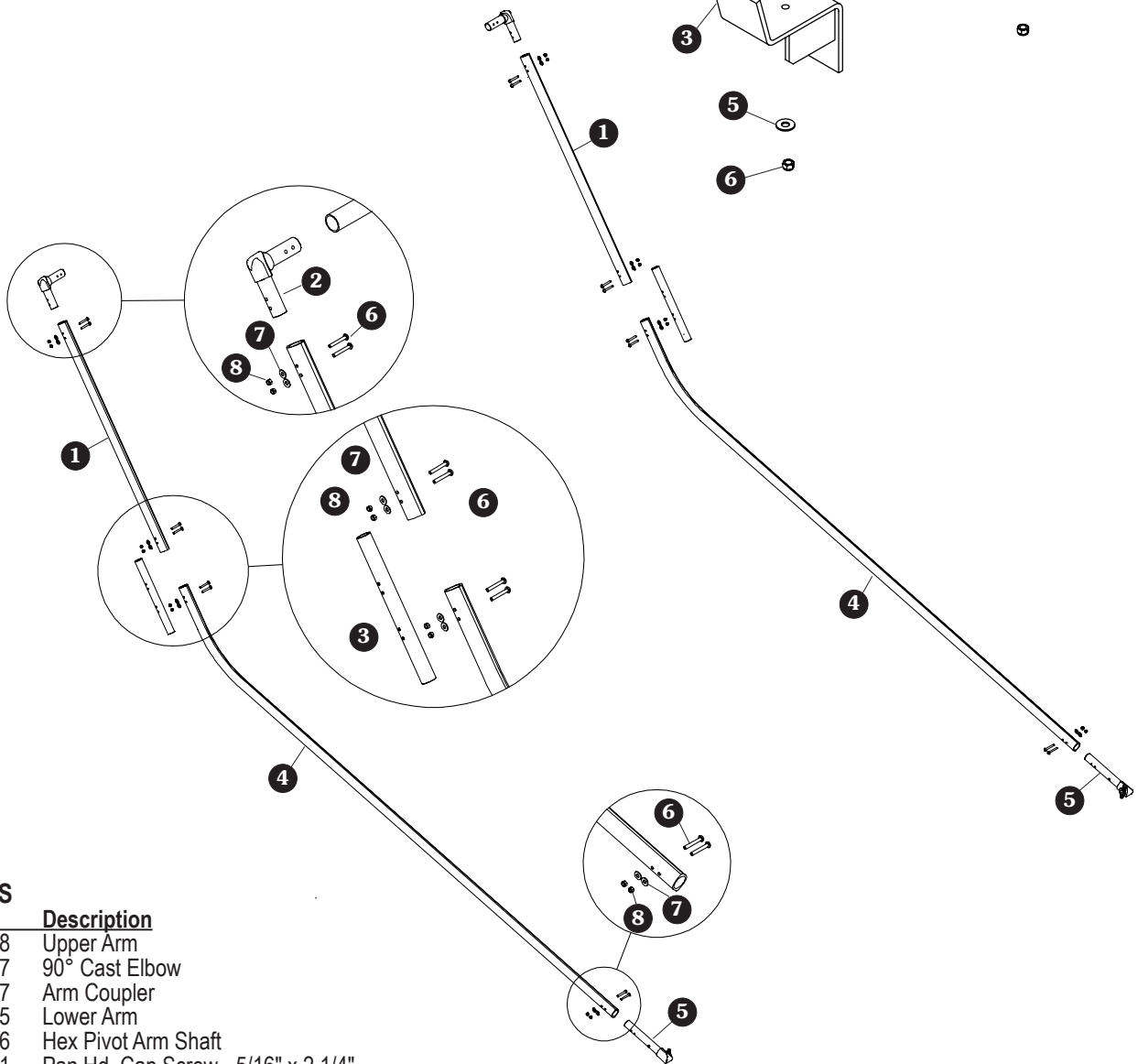
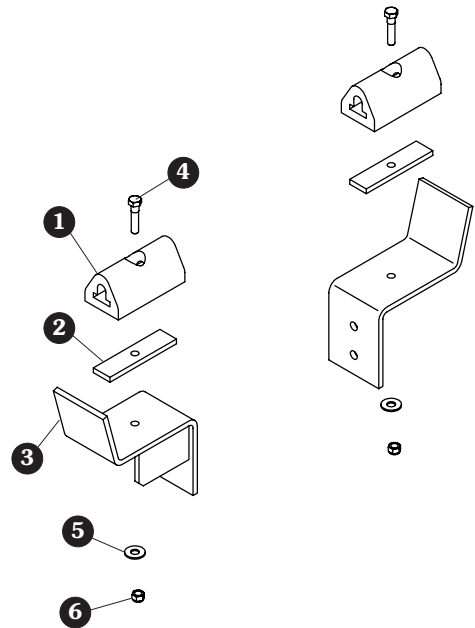

**PIVOT ARMS**

Item	Part #	Description
1.	1800548	Upper Arm
2.	1800597	90° Cast Elbow
3.	1800547	Arm Coupler
4.	1800545	Lower Arm
5.	1801636	Hex Pivot Arm Shaft
6.	1800561	Pan Hd. Cap Screw - 5/16" x 2 1/4"
7.	1800989	Flat Washer - 5/16"
8.	1800990	Lock Nut - 5/16"

**TARPS**

Item	Part #	Description
1.	1800546	Rear Crosspiece
2.		Tarp
3.	1800561	Pan Hd. Cap Screw - 5/16" x 2 1/4"
4.	1800989	Flat Washer - 5/16"
5.	1800990	Lock Nut - 5/16"

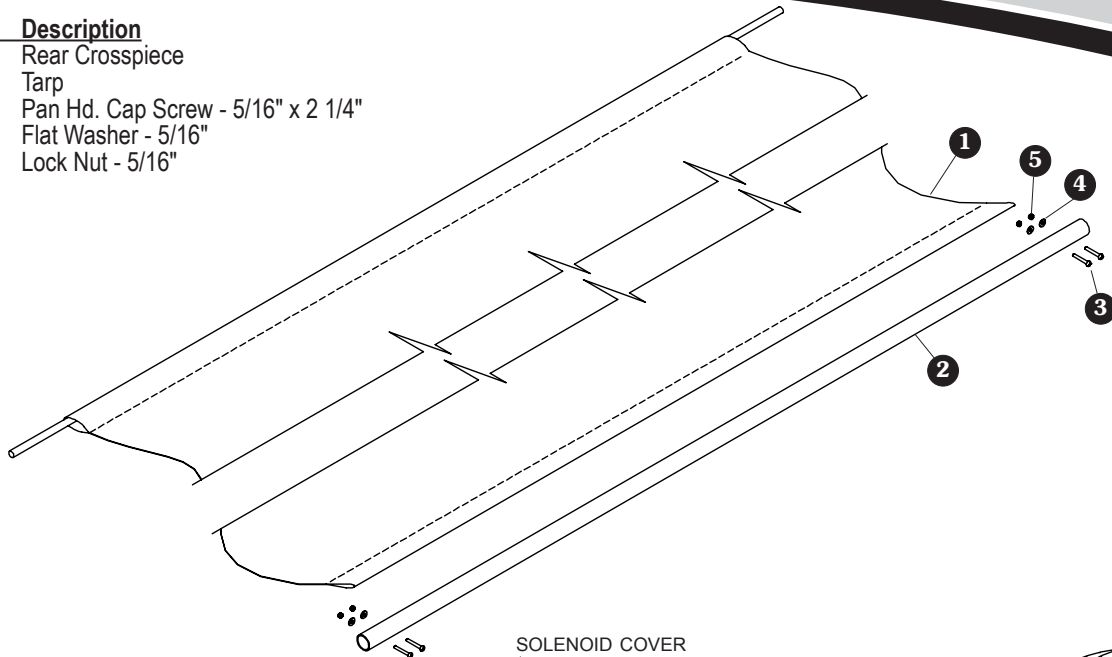

**HYDRAULIC COMPONENTS**

Item	Part #	Description
1.	1800090	Hydraulic Pump - 12 Volt - M310
2.	1801623	Pump Mount Bracket
3.	1801223	Spacer - Steel Pump Bracket
4.	1800906	Hose Clamp - 5" to 7"
5.	1801125	Motor Mount Rubber Tire
6.	1801627	Hydraulic Hose - 84 OAL
7.	1800976	Cable Tie - 8"
8.	1800972	Cap Screw - 5/16" x 1 1/2"
9.	1800991	Lock Washer - 3/8"

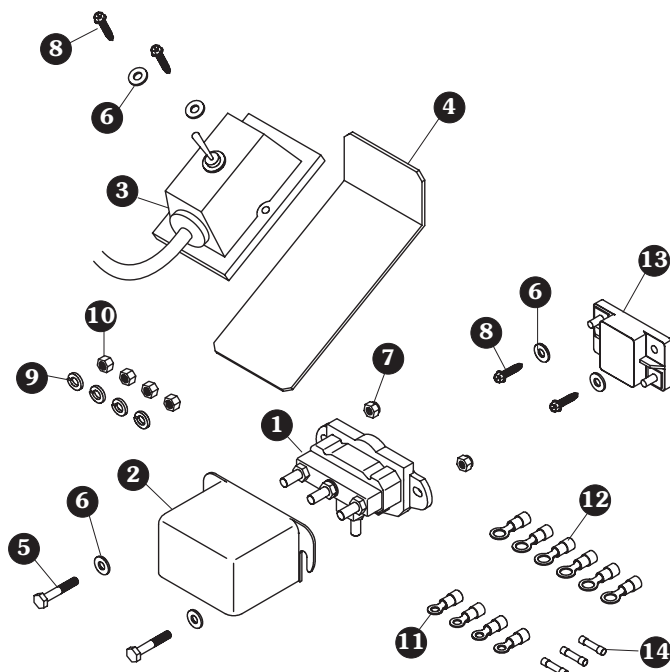
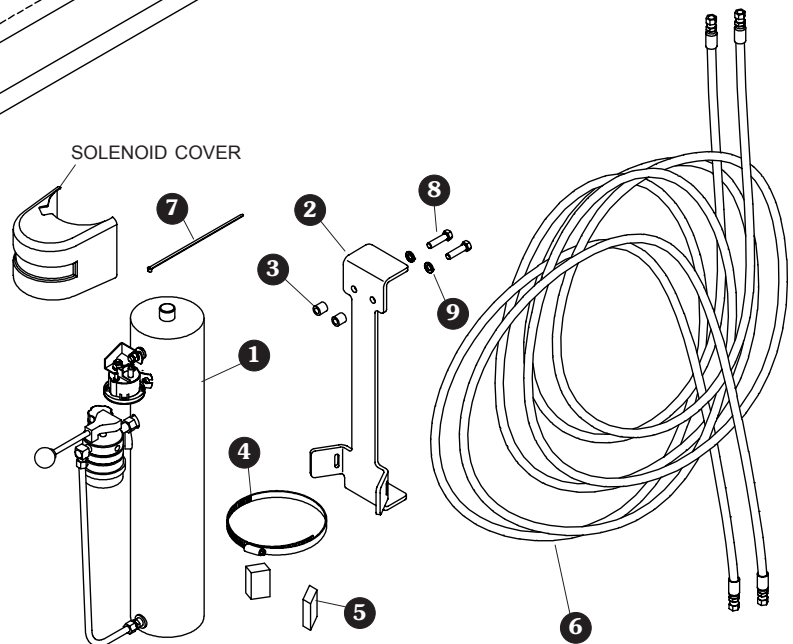

**ELECTRIC COMPONENTS**

Item	Part #	Description
1.	1800418	Solenoid
2.	1800429	Solenoid Cover
3.	1807726	Toggle Switch
4.	1801265	Toggle Switch Plate
5.	1800783	Cap Screw - 1/4" x 1 1/2"
6.	1800442	Flat Washer - 1/4" SAE
7.	1800699	Lock Nut - 1/4"
8.	1800802	Sheet Metal Screw - #10 x 1"
9.	1800787	Lock Washer - 5/16"
10.	1800431	Hex Nut - 5/16"
11.	1800302	Ring Terminal - 8 Ga. x 1/4"
12.	1800158	Ring Terminal - 8 Ga. x 3/8"
13.	1800417	Circuit Breaker - 60-Amp 12V
14.	1800441	Butt Connector - 18-22 Ga.

# MORE QUALITY PRODUCTS FROM DONOVAN™

---

## ■ Construction Products

- Arm-Matic™
- DuraPull™
- Econo-Pull™
- Turbo Tarp2™
- 2000 Series
- 5000 Series
- Hammer™
- Bullet™
- Flash™
- Long Arm™

## ■ Waste Products

- SWAT™
- The Ox™
- Quick-Flip III™
- Sidewinder™
- Sidewinder™ 350
- HyTower™ SL
- HyTower™ DL
- Double-Flip™
- Donovan Belt & Ratchet (DBR)

TARP SYSTEMS, PARTS & TARPS

